

INSTALLATION INSTRUCTIONS



LLOYD'S BUILDING LONDON TOWER T1-T3-T5

Code **14-218216-INST.GLASS.EN**

Version **0**

Date **01.08.2017**

LANDING DOOR FULL GLASS PANEL

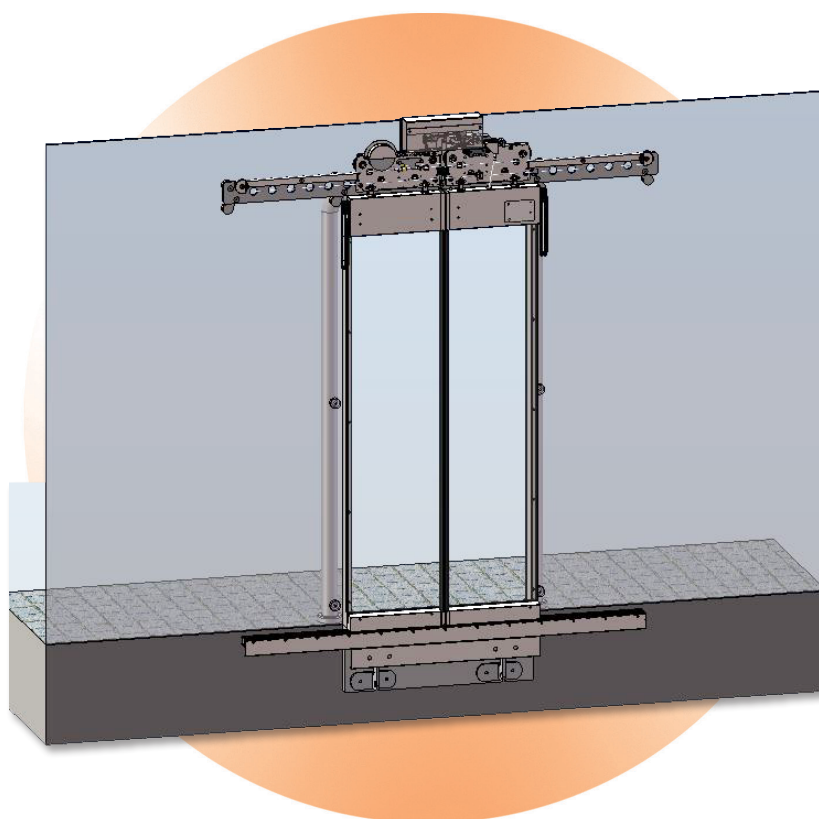

No part of this publication may be reproduced or translated, even in part, without prior written permission from WITTUR.

Subject to change without notice!

Questa pubblicazione non può essere riprodotta né tradotta, né interamente né in parte senza autorizzazione scritta della WITTUR.

Soggetto a modifica senza preavviso!

info@wittur.com
www.wittur.com

© Copyright WITTUR 2017



INDEX

Foreword.....	Pag.1
Symbols used.....	Pag.2
Safety Requirements.....	Pag.2
Warnings and Suggestions.....	Pag.3
Tools.....	Pag.4
Existing frame	Pag.5
Mechanism Installation	Pag.9
Sill installation	Pag.11
Installation of the safety profile	Pag.13
Panel Installation.....	Pag.14
Install the panel on the door as shown.....	Pag.15
Landing door lock adjustment	Pag.18
Spirator reclosing system adjustment	Pag.21
Warnings on how to keep the doors in good operating conditions.....	Pag.23

Congratulations on choosing a **WITTUR** product!

Before starting the installation of this product, read the information contained in this document. You will find important warnings on how to assemble and maintain your **WITTUR** product in good operating conditions and to get the maximum of your investment.

You will also find important information concerning the product care and maintenance which are an important factor to ensure safety at all times.

WITTUR has long been involved in research aimed at reducing noise level and in design that takes into due consideration the product quality and the conservation of environment.

 This document is an integral part of the supply and must be available in the lift power room at all times.

All products are provided with identification type label and in case with certification marks in accordance with the current rules.

In case of need concerning the product, the identification data on the label must be always communicated to us.

We hope you will get full satisfaction from this **WITTUR** product. Yours faithfully.

WITTUR

The points that are important under the safety viewpoint and danger warnings are indicated with these symbols:



Danger general



Important warnings



Risk of personal injury (e.g. sharp edges, protruding parts)



Risk of damage to mechanical parts (e.g. incorrect installation)



Live parts



SAFETY REQUIREMENTS

All persons involved must know and follows all company and local safety regulations, with special attention to the following:

- Make sure that there is enough light to work safely.
- Immediately replace damaged or lost safety equipment.
- Keep all tools in good condition.
- Follow instructions when using tools.

In addition to protective clothing, the following safety equipment must be used:



Safety Shoes



Hardhat



Safety Goggles



Full Body Safety Harness



Protective Gloves

WARNINGS

- **WITTUR** will not be held liable for any damage caused by tampering of the packing material by thirds.
- Before starting assembly, check that the product received corresponds to the order and to the packing list and that no damage has occurred in transit.
- Within its policy of continual research, **WITTUR** reserves to make changes to its products without notice. The figures, descriptions and data contained in this manual are intended as purely indicative and not binding.



- To ensure the safety of the product, avoid any alteration or tampering.
- **WITTUR** liability will be limited to the original components only.
- **WITTUR** product is intended for use in the lift sector only, therefore **WITTUR** liability shall be limited to such use.
- This product is intended for professional use. Any improper use, including for hobby or DIY, is prohibited.



- In order to prevent any injury to persons and damage to property, the handling, installation, adjustment and maintenance must be carried out by suitably trained personnel, using appropriate clothing and equipment.
- Any masonry work connected with the correct installation of the product must be executed in a workmanlike manner according to the applicable laws.
- The connection of the electric/electronic units to the local power supply must be executed in a workmanlike manner according to the applicable laws.
- All metal parts supporting the electric/electronic units must be connected to an earth system in a workmanlike manner according to the applicable laws.



- Before connecting the product to the power supply check that the product's requirement corresponds with the power supply available.
- Before starting any work on the electric/electronic components disconnect power from the system.
- **WITTUR** shall have no responsibility on the execution of masonry works or the connection of electric/electronic components to the power supply.



- **WITTUR** shall not be liable for damages/injury to property/persons caused by improper use of the emergency opening devices.

SUGGESTIONS

- Keep the material in the original packing, protected from bad weather and direct exposure to sun during the storage period in order to avoid the accumulation of water/condensation inside the packing material.
- During the stocking period, in order to keep unaltered the properties of the materials in the packing, the room temperature range has to be from -20° C to +60° C.
- Never dispose of packing material in the environment.
- Once dismantled, the product should be conveniently disposed as provided for by the local laws; never dispose of in the environment.
- Whenever possible, re-cycling is preferable to disposal in dump sites.
- Before re-cycling check the nature of the various materials and re-cycle in the appropriate way.

LLOYD'S LANDING DOOR T1-T3-T5 FULL GLASS

Code 14-218216-INST.GLASS.EN
Version 0
Date 01.08.2017
Page 4.23

TOOLS

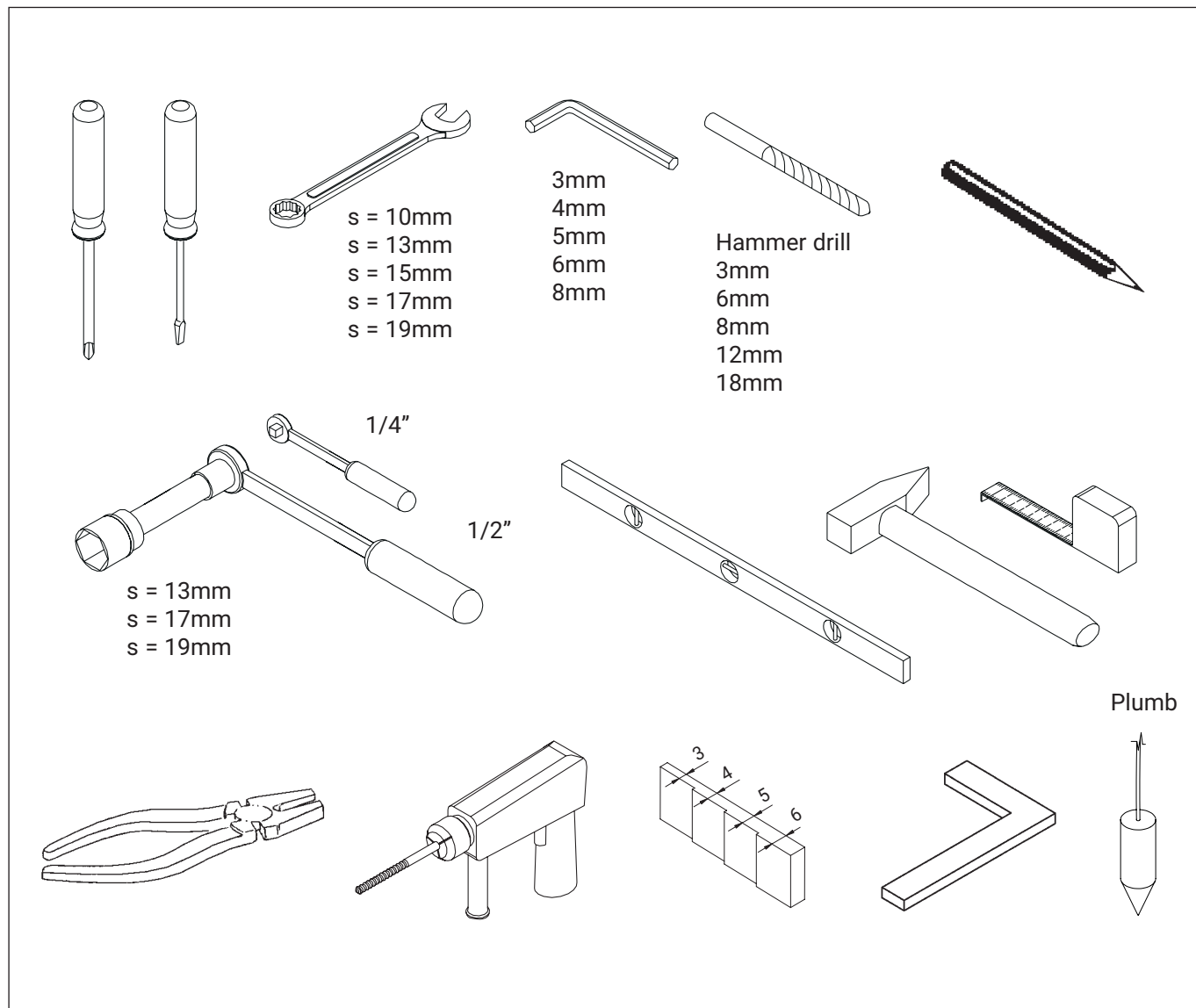

! All screws used for the assembly of our product are screwed by means of a tightening torque as shown on following table:

Screw	Max torque (Nm)	Min torque (Nm)
M3	1,1	0,9
M4	2,6	2,1
M5	5,1	4,1
M6	9	7
M8	21	17
M10	42	34
M12	71,4	57,1

In case of need please refer to above table.

EXISTING FRAME

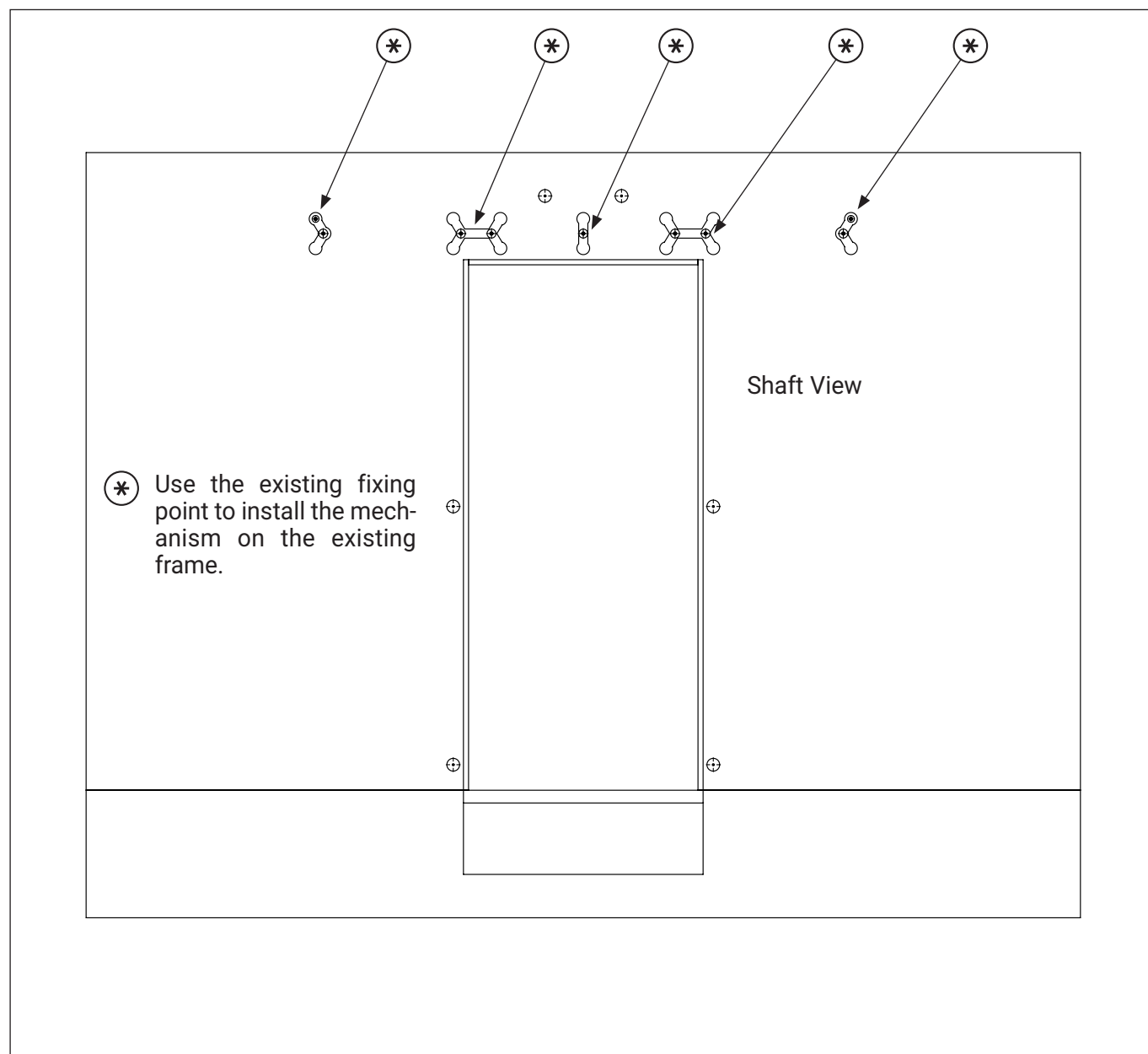

LLOYD'S LANDING DOOR
T1-T3-T5 FULL GLASS

Code 14-218216-INST.GLASS.EN
Version 0
Date 01.08.2017
Page 6.23

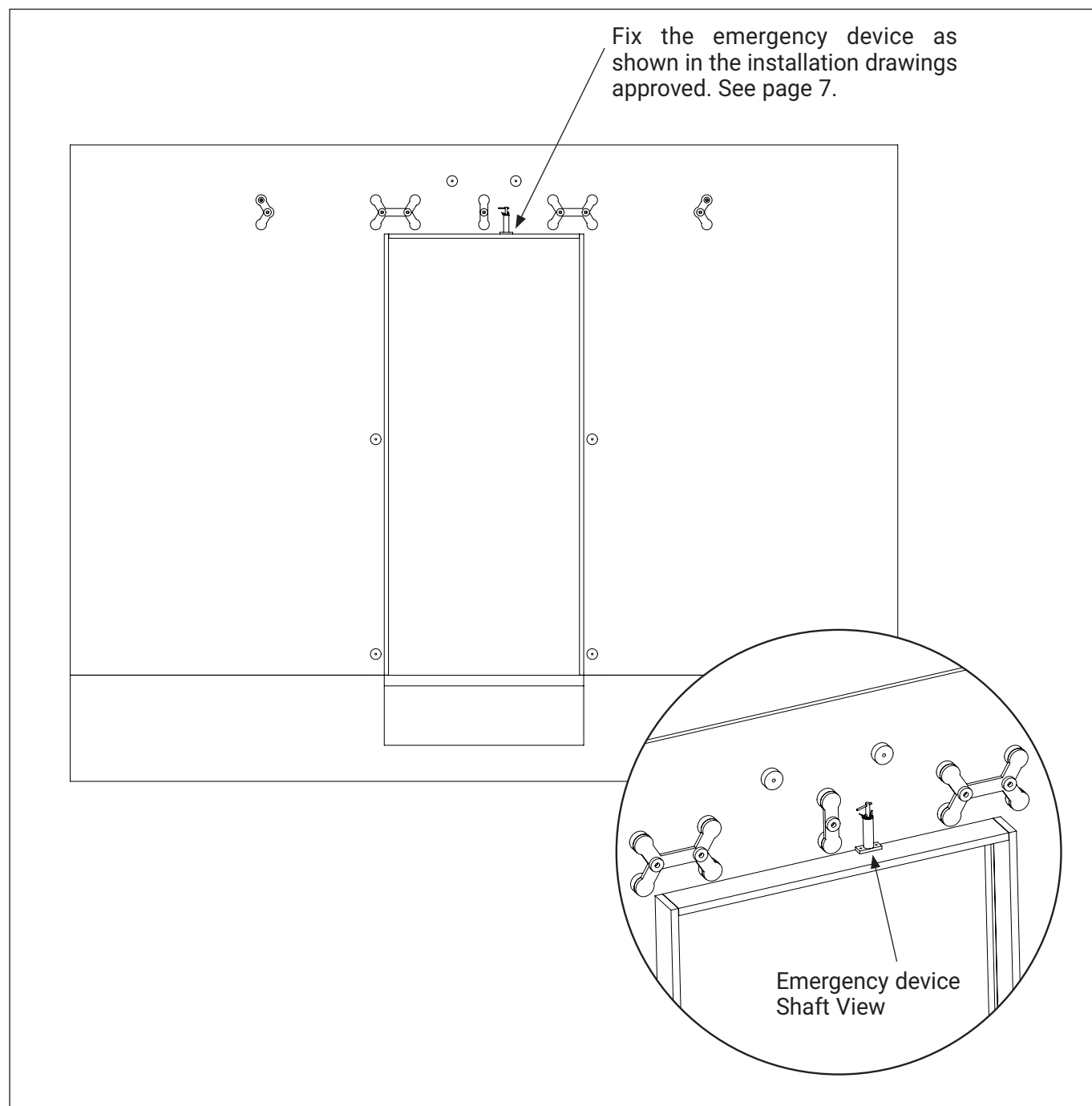

LLOYD'S LANDING DOOR
T1-T3-T5 FULL GLASS

Code 14-218216-INST.GLASS.EN
Version 0
Date 01.08.2017
Page 7.23

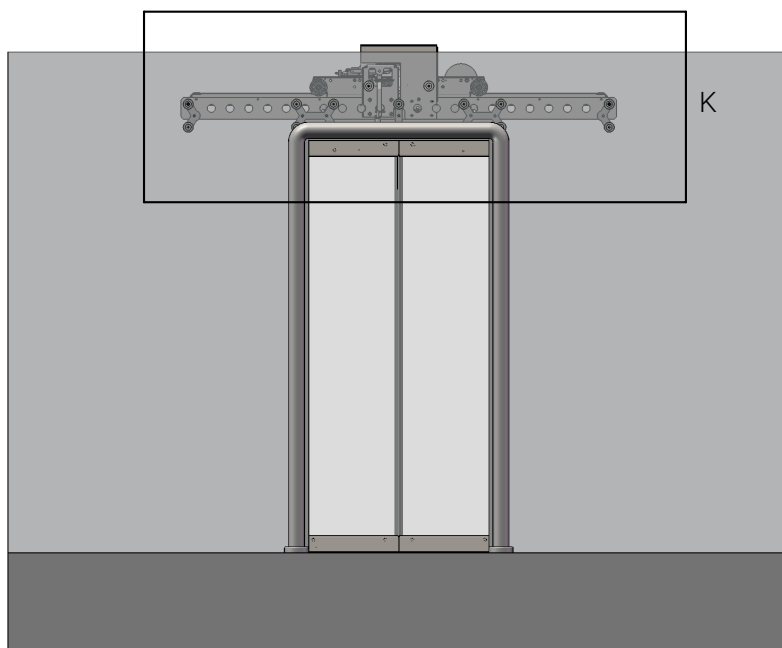

VIEWED FROM THE LANDING

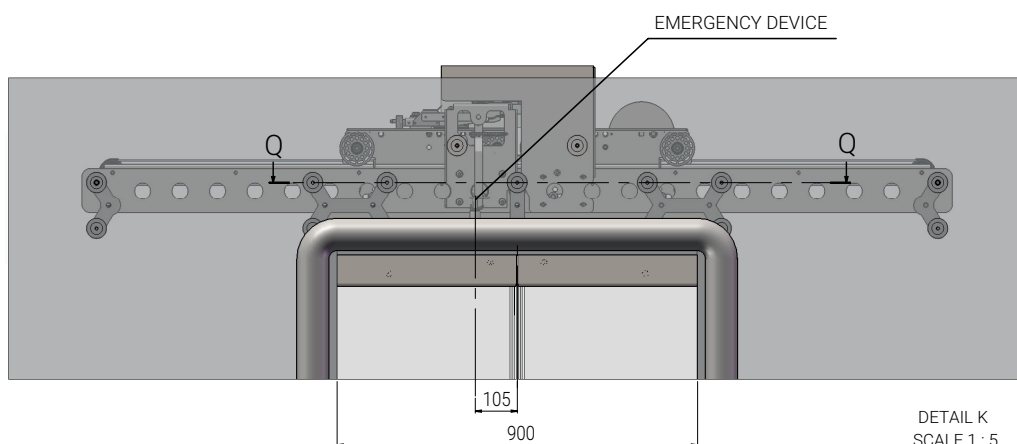

LLOYD'S LANDING DOOR
T1-T3-T5 FULL GLASS

Code 14-218216-INST.GLASS.EN
Version 0
Date 01.08.2017
Page 8.23

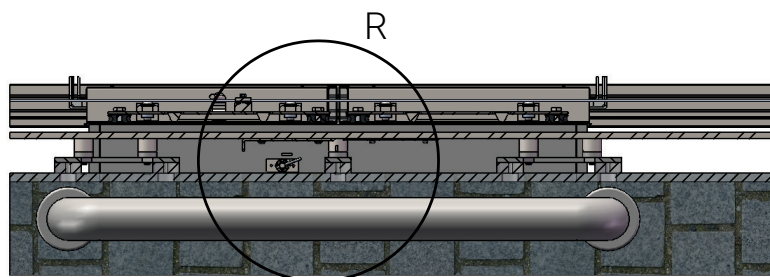

Q-Q
SCALE 1 : 5

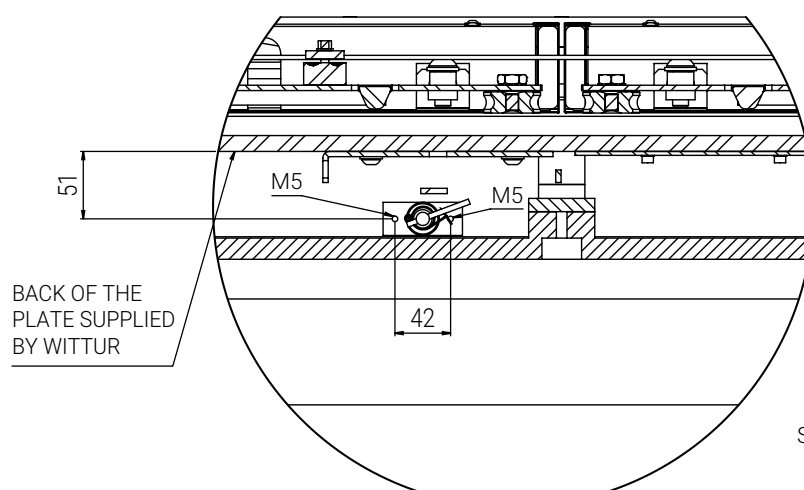

DETAIL R
SCALE 1 : 2

MECHANISM INSTALLATION

Mechanism supplied by Wittur

Shaft View

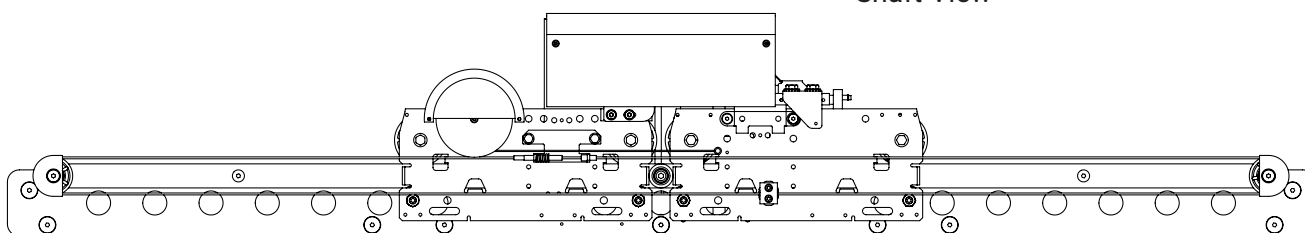

Landing View

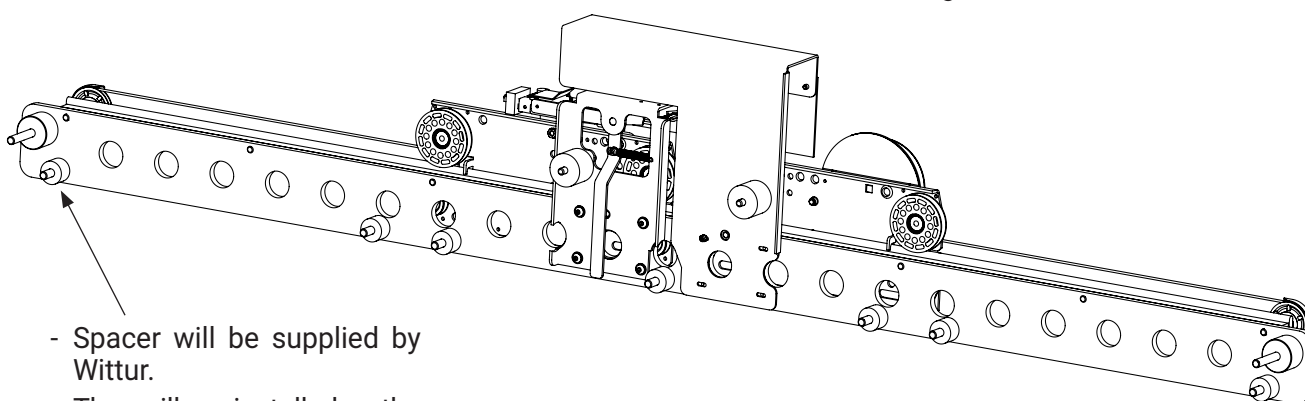

- Spacer will be supplied by Wittur.
- They will pre-installed on the mechanism.

LLOYD'S LANDING DOOR T1-T3-T5 FULL GLASS

Code 14-218216-INST.GLASS.EN
Version 0
Date 01.08.2017
Page 10.23

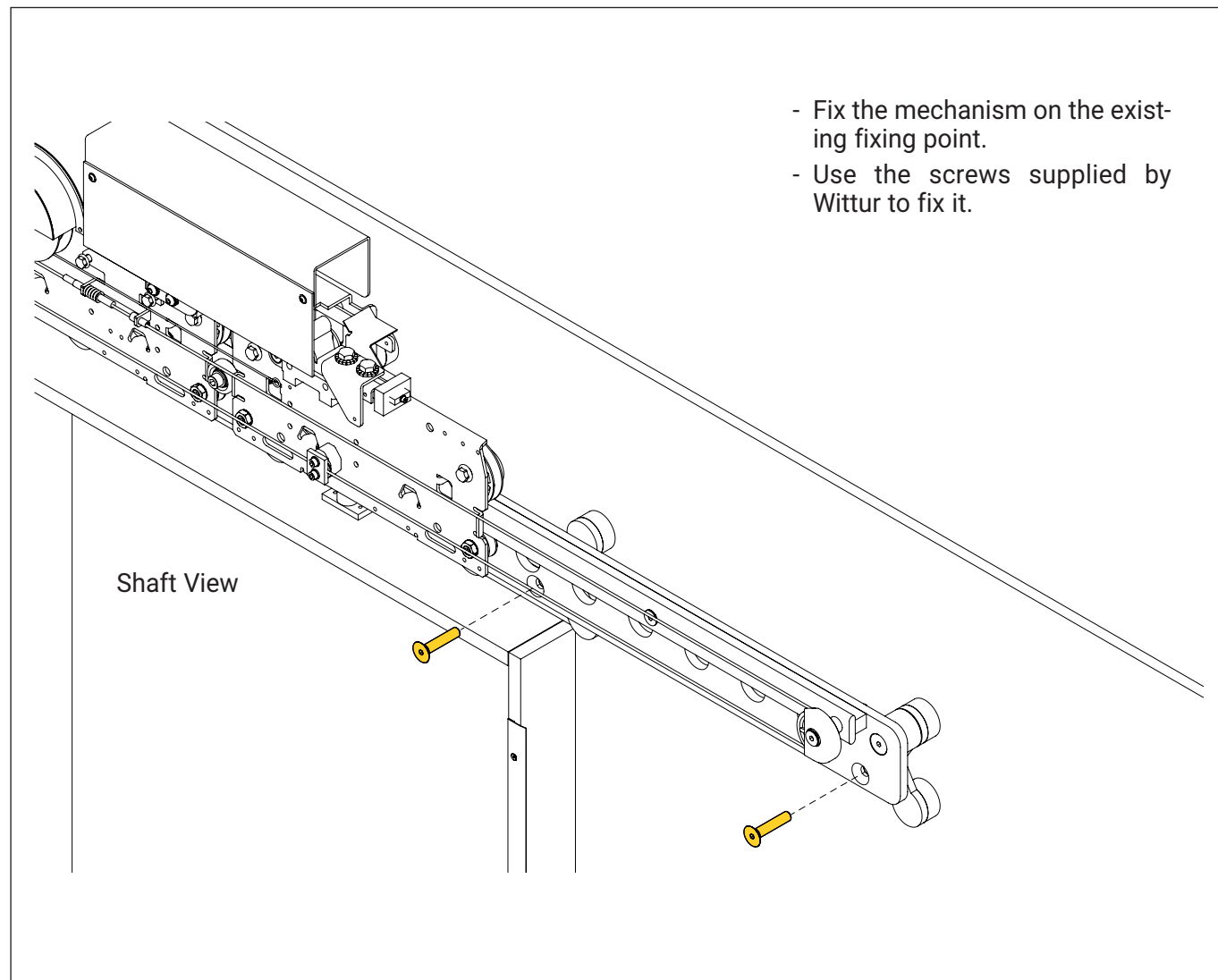

SILL INSTALLATION

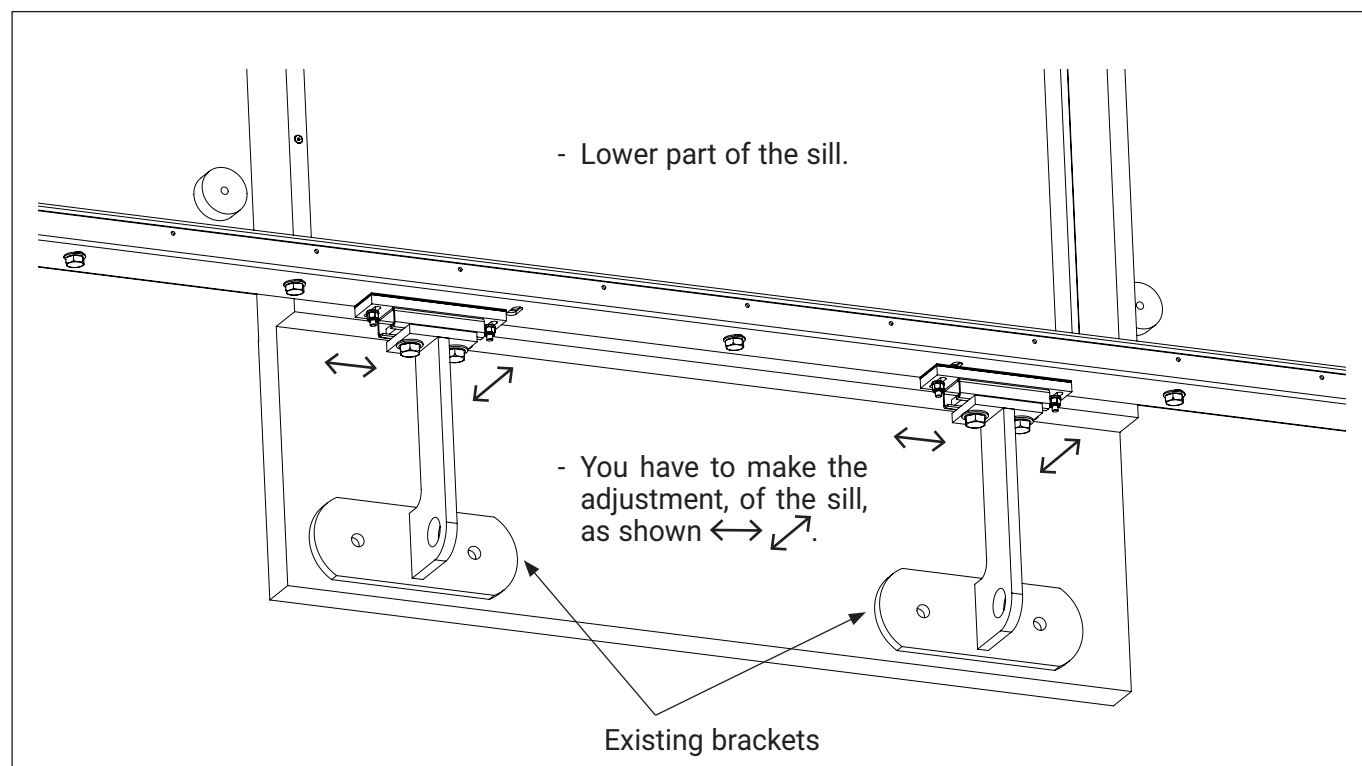
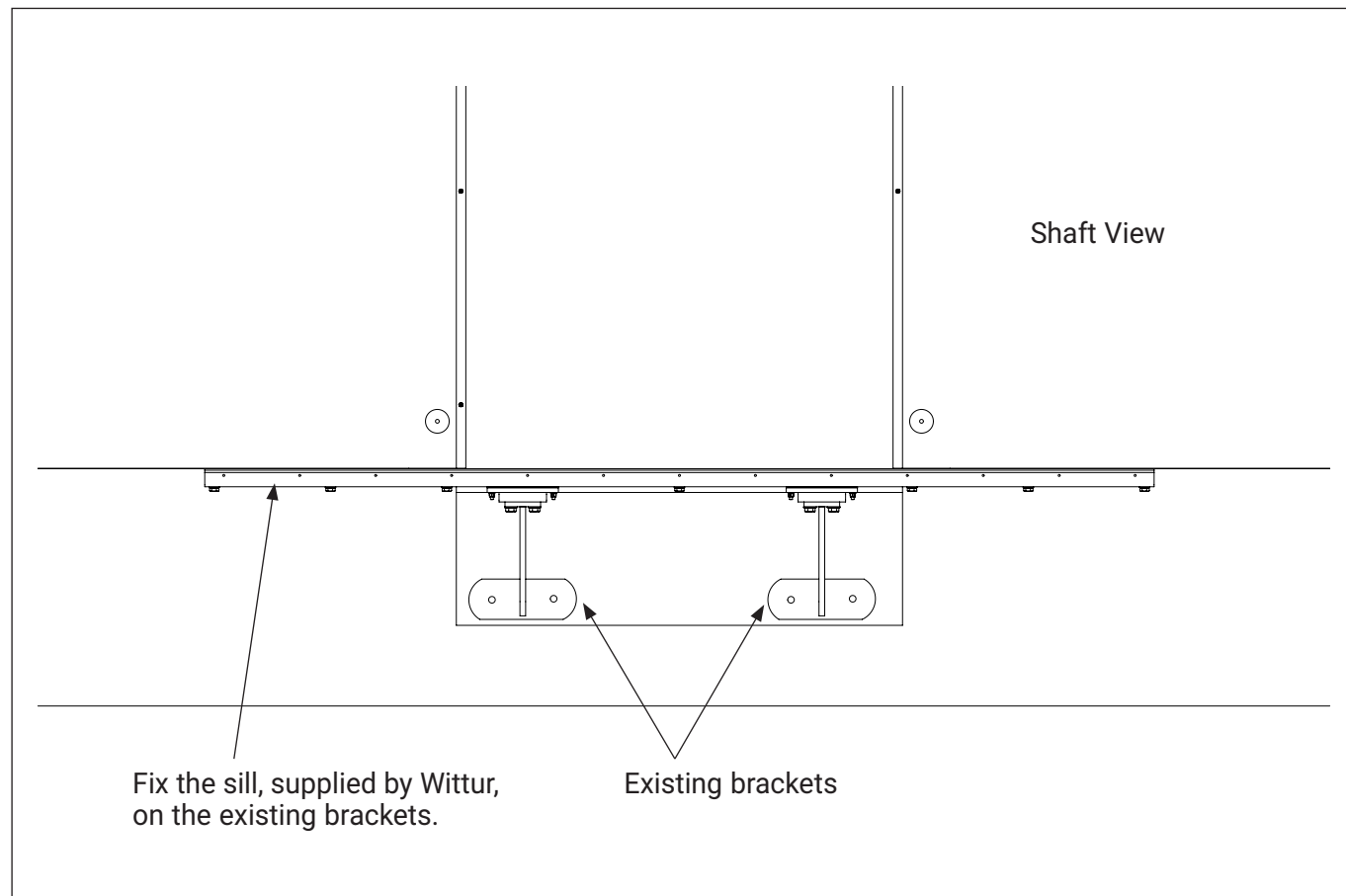

After the sill adjustment, fix
toe guard with the screws
supplied.

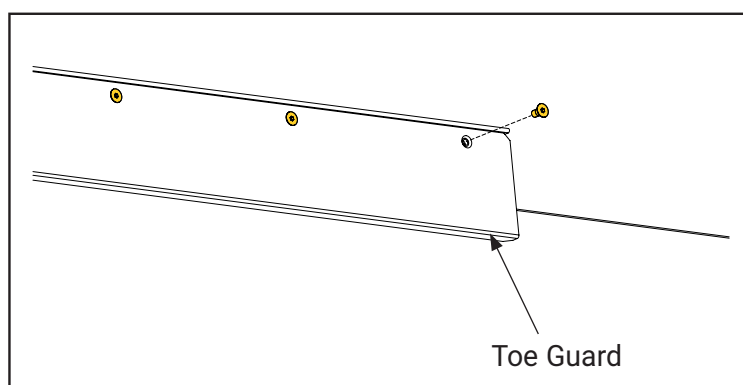
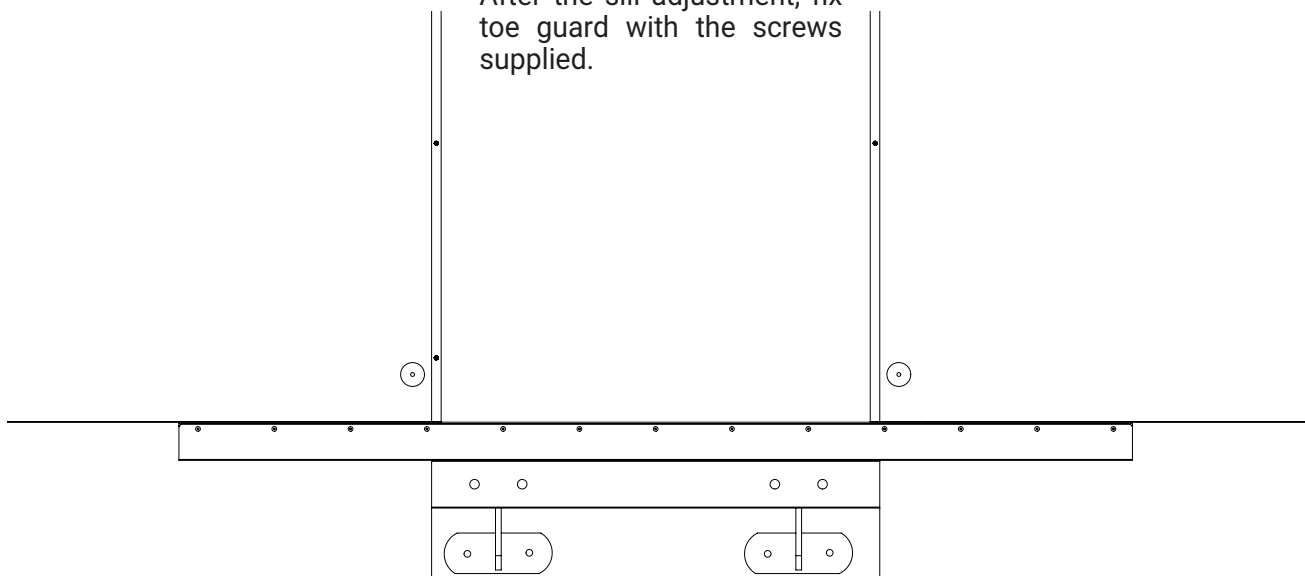

INSTALLATION OF THE SAFETY PROFILE

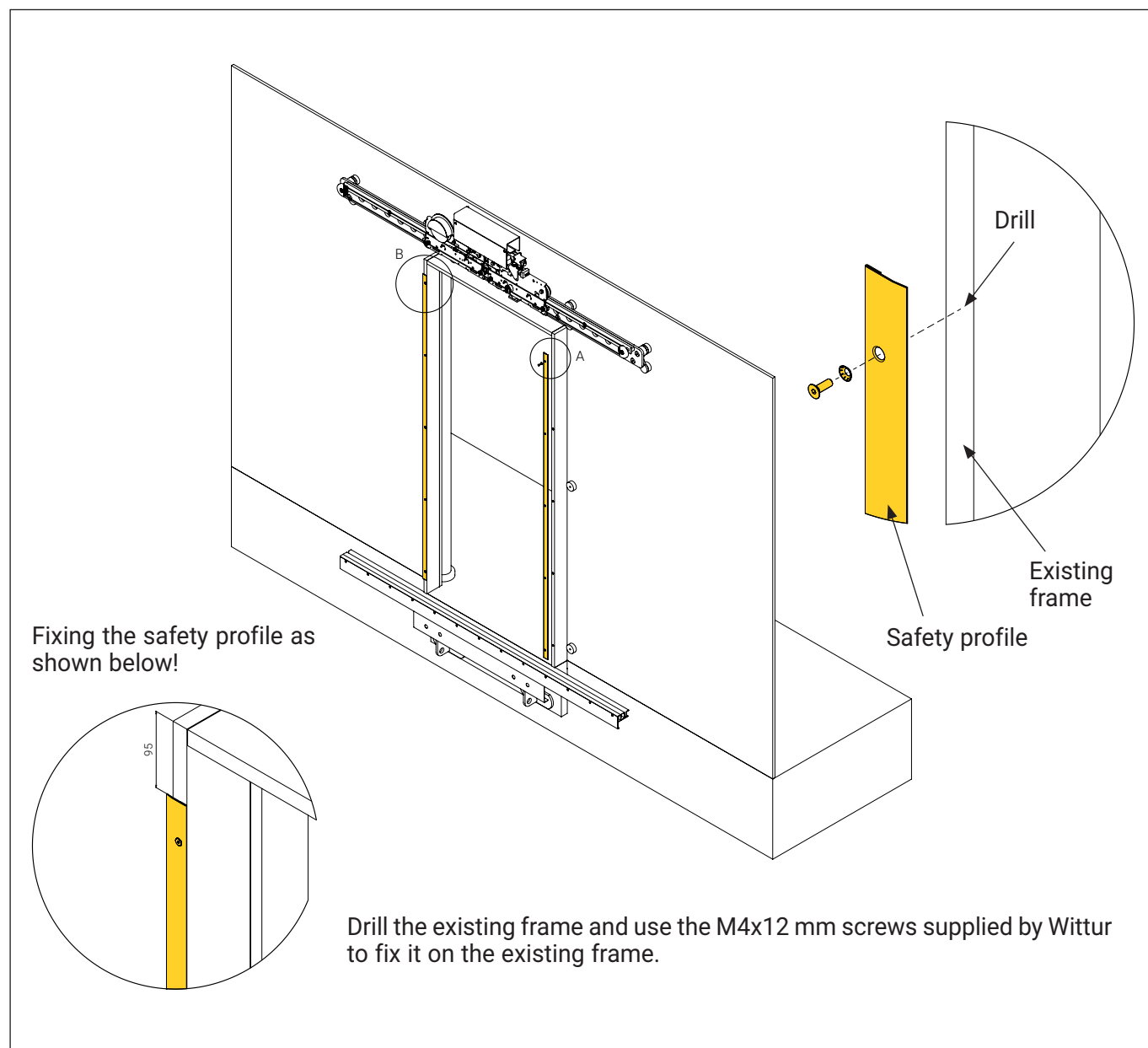

PANEL INSTALLATION

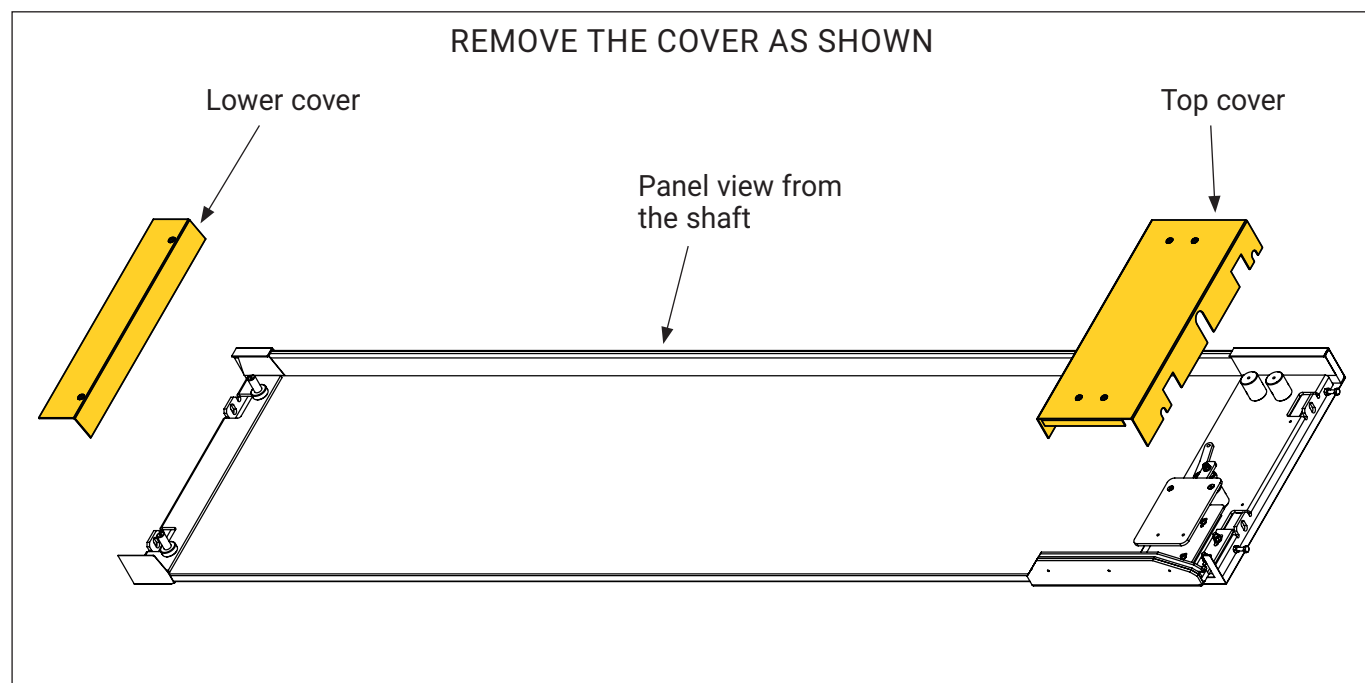
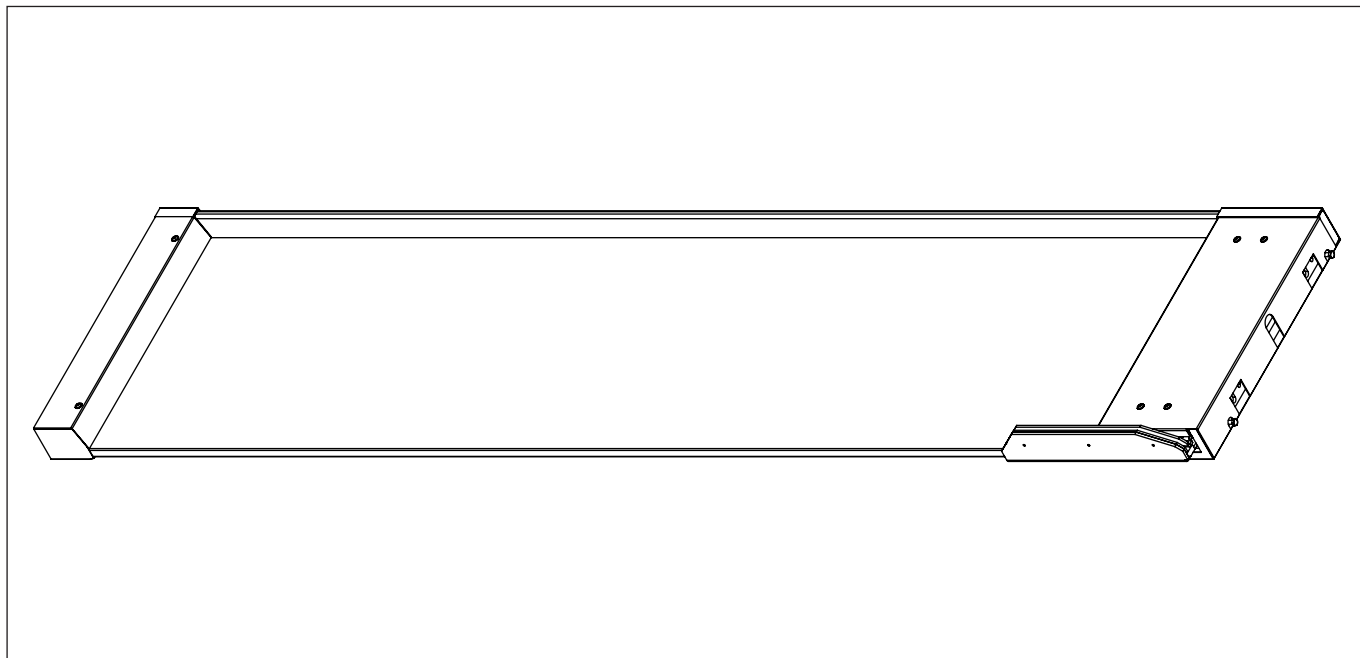

LLOYD'S LANDING DOOR
T1-T3-T5 FULL GLASS

Code 14-218216-INST.GLASS.EN
Version 0
Date 01.08.2017
Page 15.23

INSTALL THE PANEL ON THE DOOR AS SHOWN

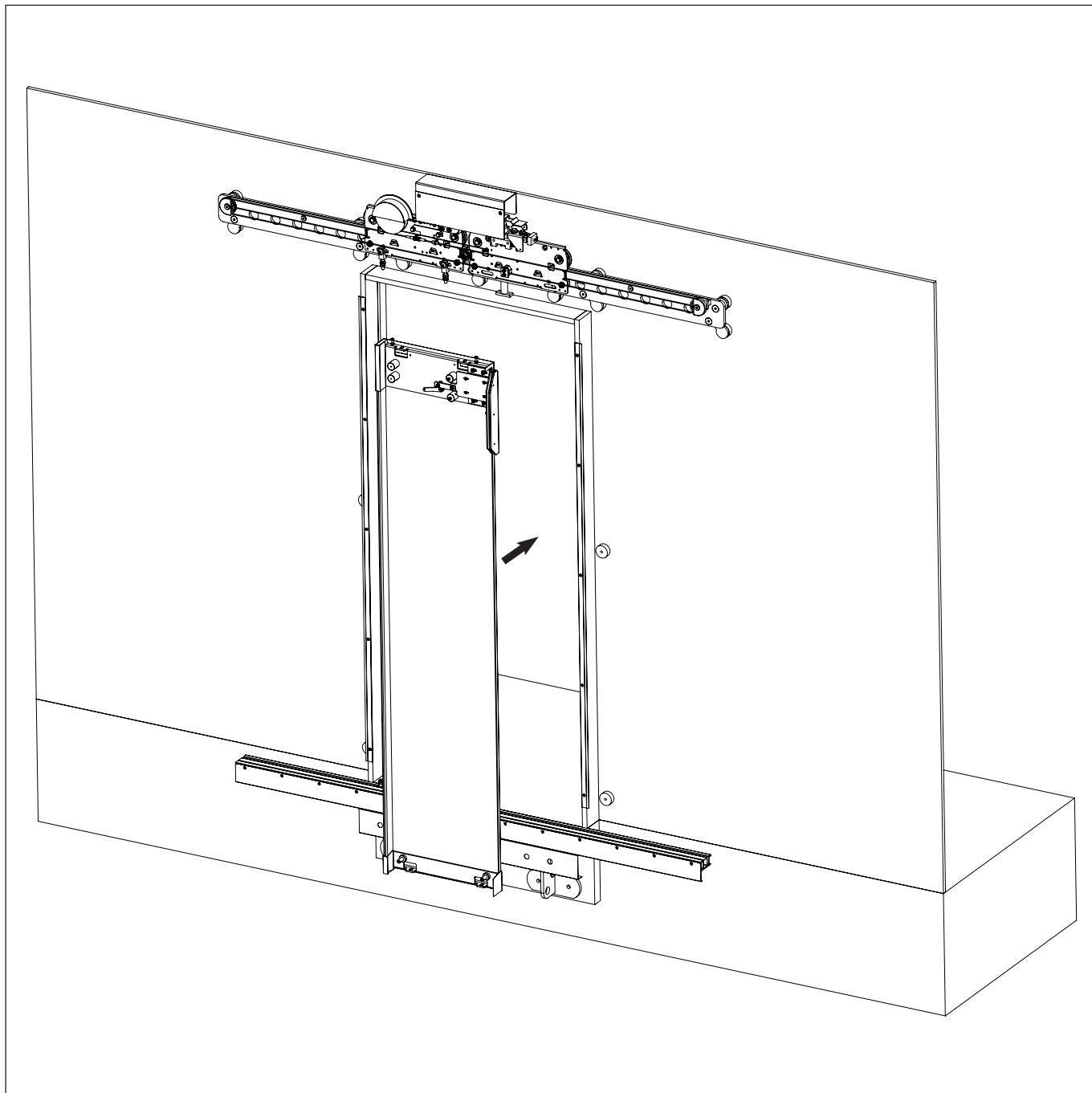

LLOYD'S LANDING DOOR T1-T3-T5 FULL GLASS

Code 14-218216-INST.GLASS.EN
Version 0
Date 01.08.2017
Page 16.23

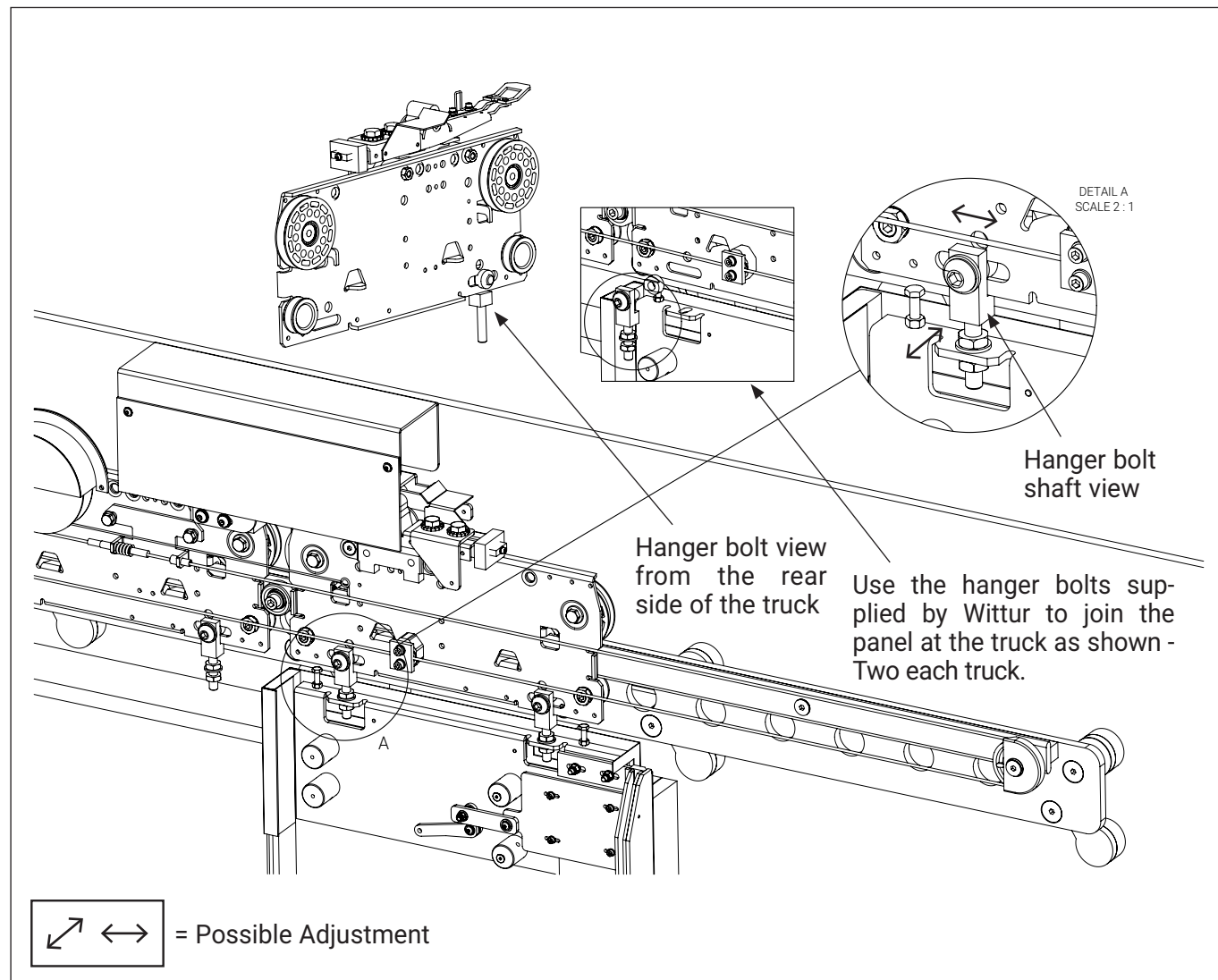

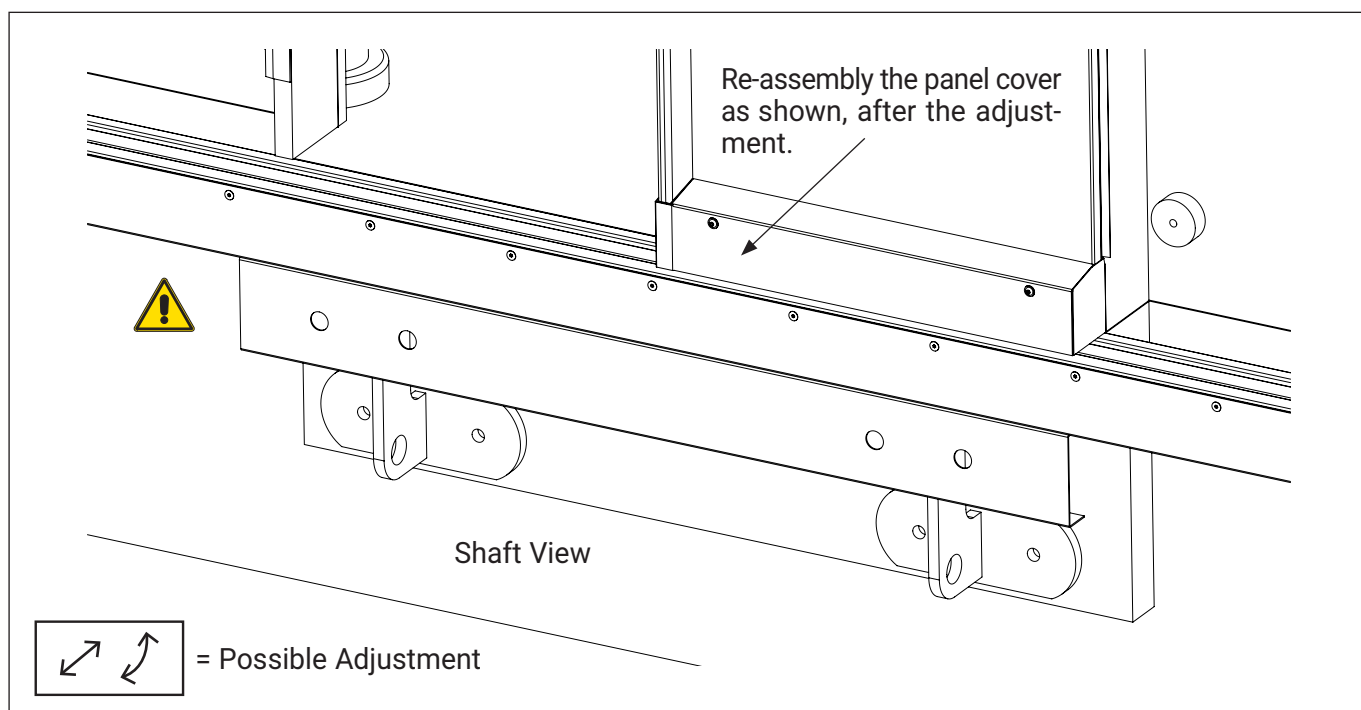
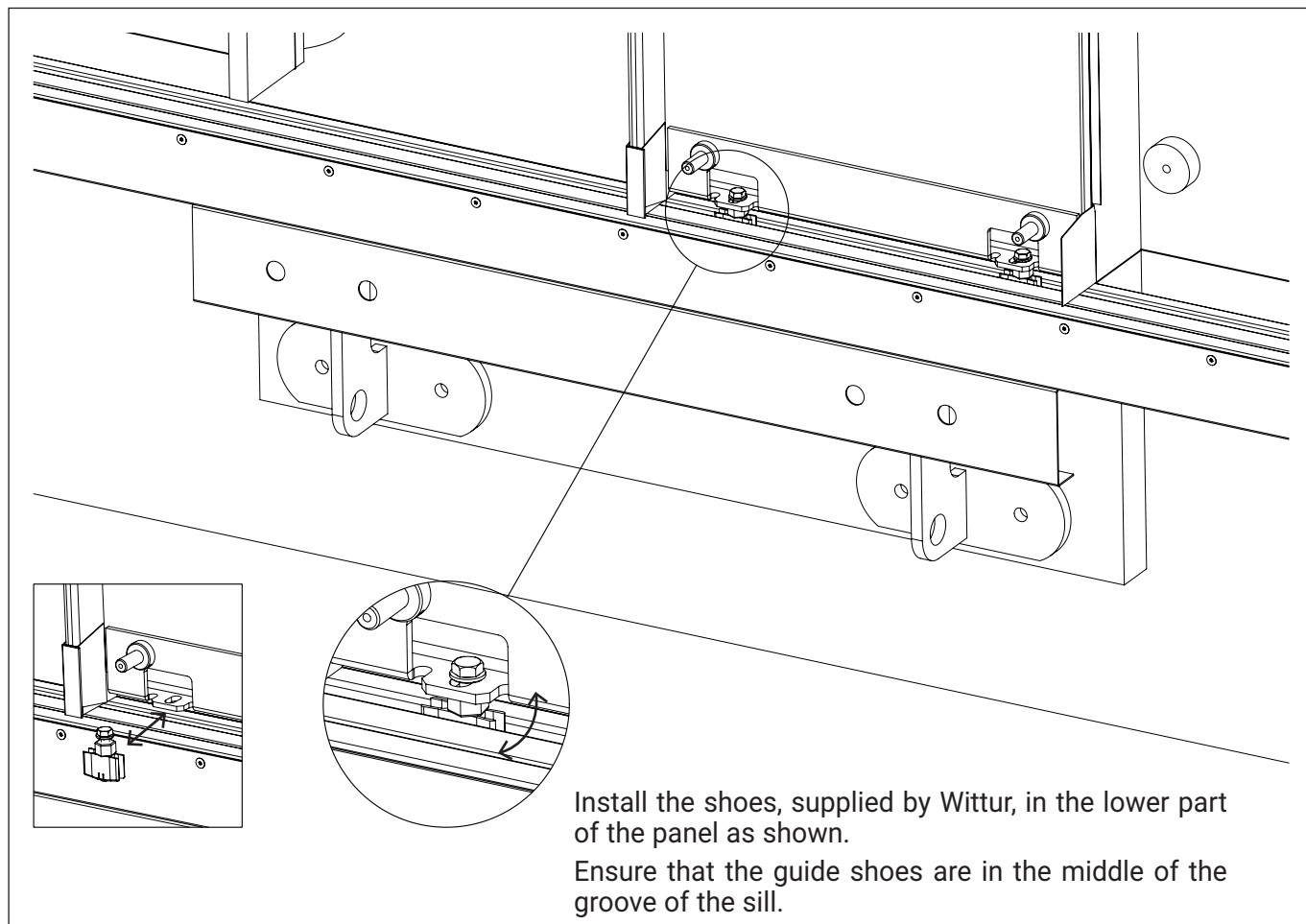

LANDING DOOR LOCK ADJUSTMENT

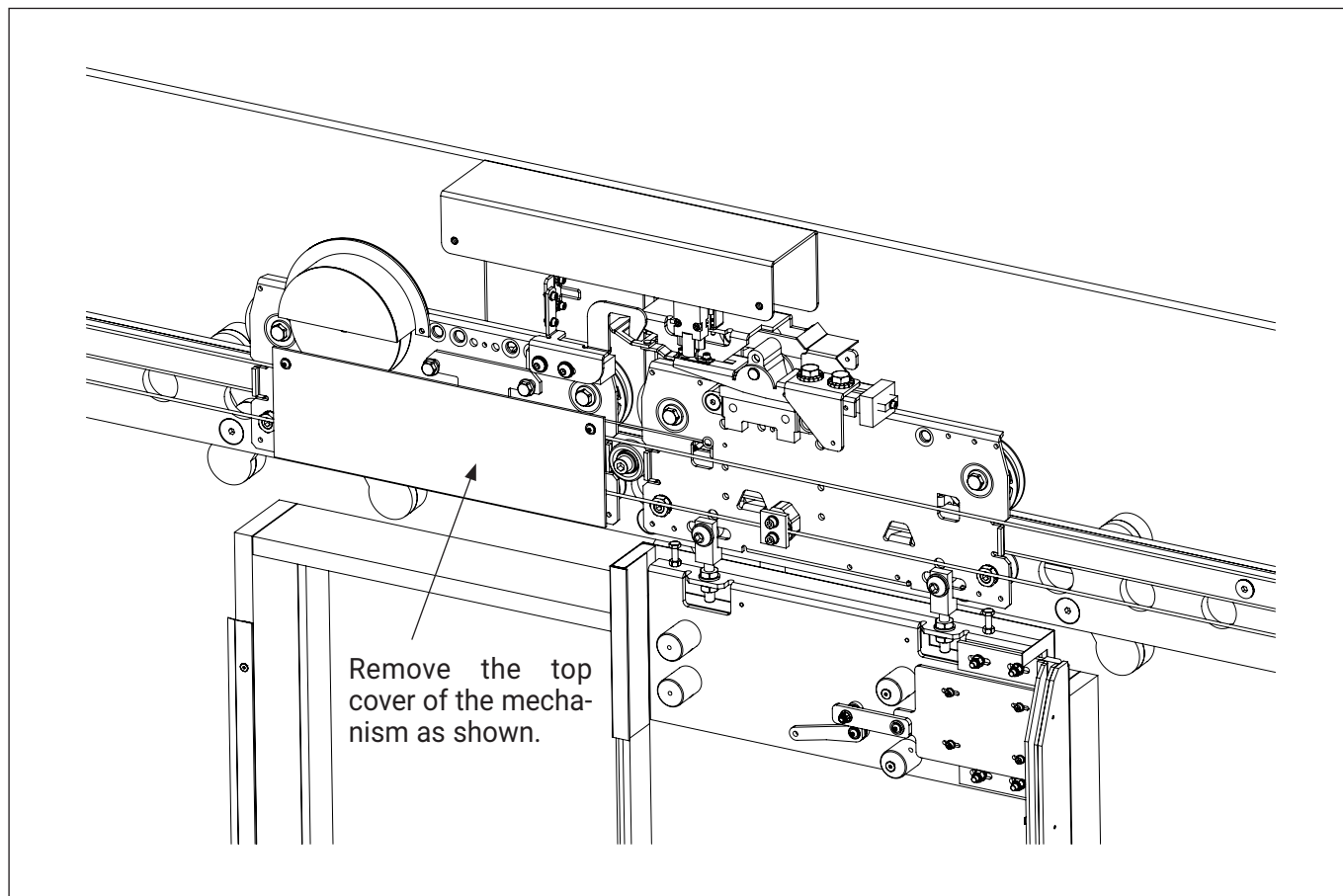

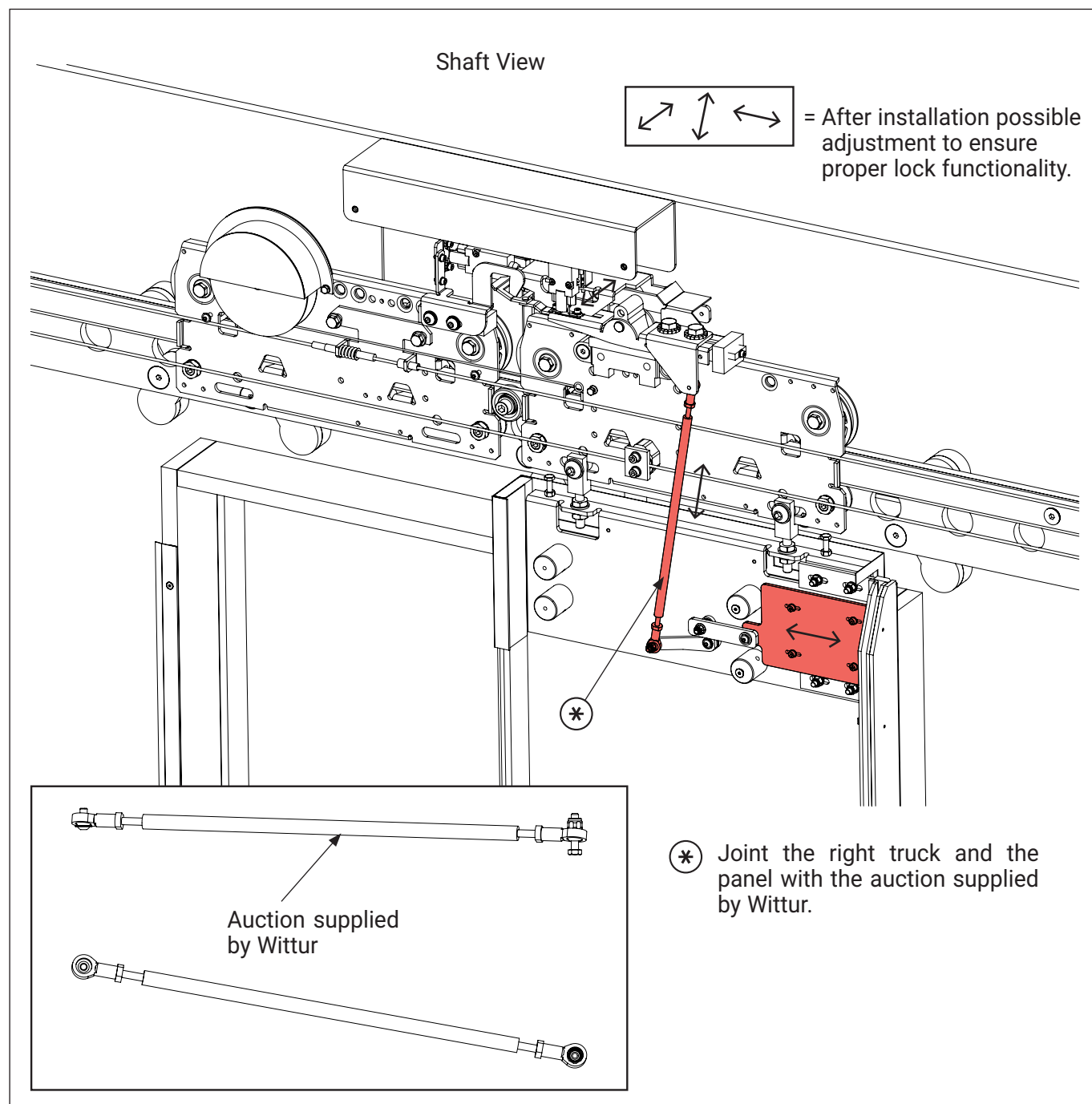

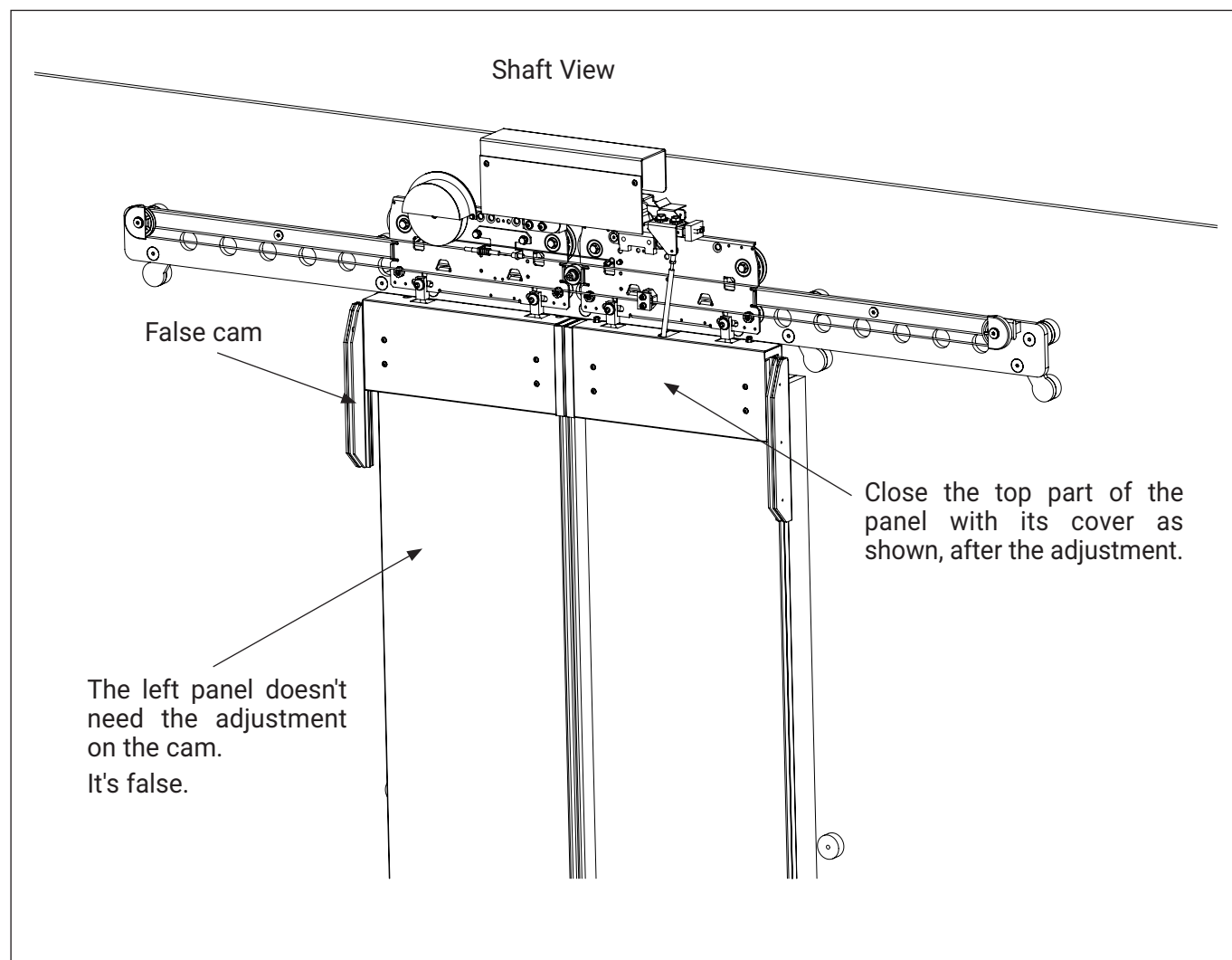

SPIRATOR RECLOSING SYSTEM ADJUSTMENT

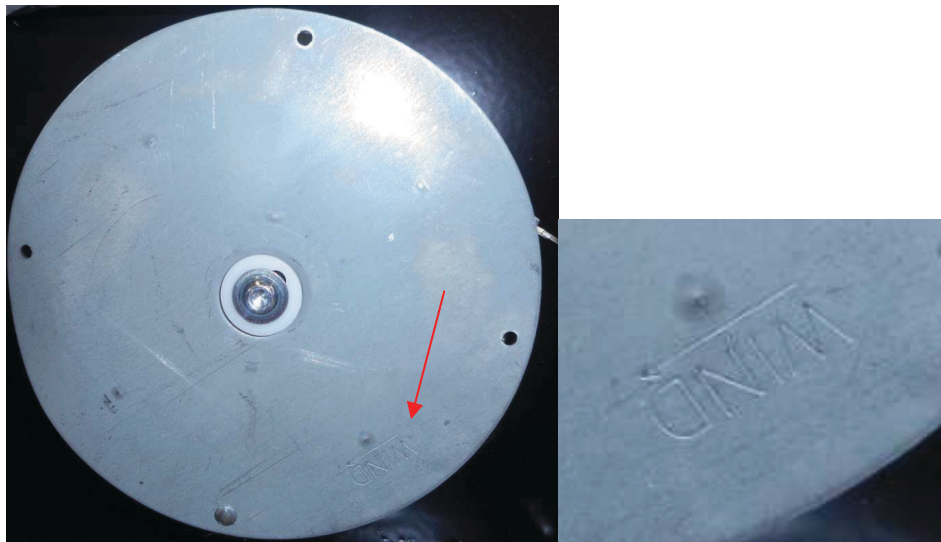

Each spurator has a marker of the winding direction like shown above.

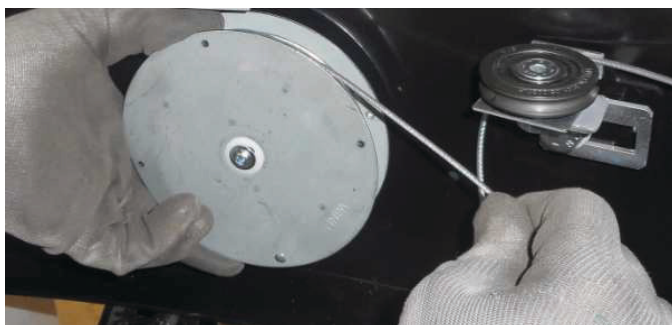

Old the spurator and turn it in the Wind indication to release the rope.

Always old the spurator to avoid it winding back and the risk of hurt your hands.

The rope winding can go from 1 to 6 maximum rotation but always after each rotation try to reclose the doors to check the rope tension to avoid the risk of overtensioning it and brake it.



As soon as loose enough length of the rope wind it around the spirator into the groove.



WARNINGS ON HOW TO KEEP THE DOORS IN GOOD OPERATING CONDITIONS



In order to prevent failures or incorrect operation and to maintain the system in good conditions, the technical efficiency of the system should periodically be checked, to ensure compliance with the applicable laws.

The technical efficiency depends on various factors such as:

- Work load
- Years of operation
- Door weight
- Climatic and environmental conditions
- Cleanness of environment
- Correct maintenance
- Etc.

And it can affect:

- Clearance/interference between the doors, and between the doors and posts according to the applicable laws
- Clearance of coupling device
- Status/conditions of fixing and coupling elements
- Conditions of parts affected by wear
- Efficiency of the lock and relevant contacts
- Any other parts that may be affected by the type of application.

For these reasons it is not possible to establish a general part replacement programme beforehand.



**YOUR GLOBAL PARTNER FOR COMPONENTS,
MODULES AND SYSTEMS IN THE ELEVATOR INDUSTRY**

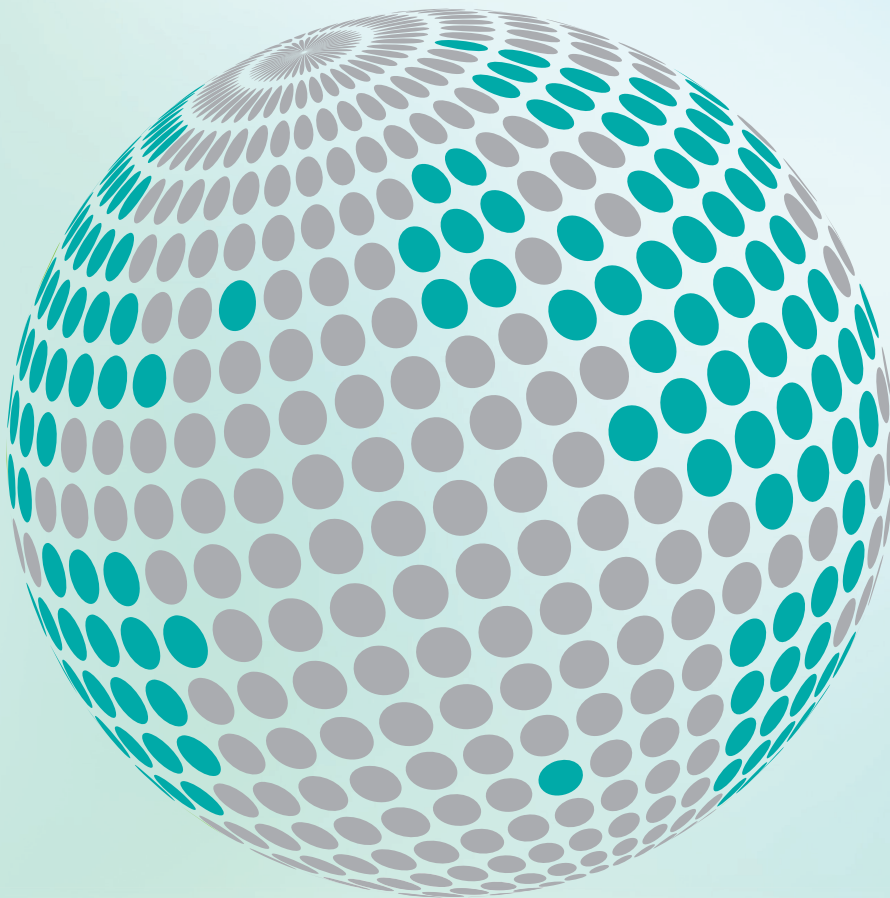

www.wittur.com

More information
about Wittur Group
available on-line.



SELCOM®
a WITTUR brand

Liftmaterial
a WITTUR brand

semaTIC®
a WITTUR brand