

INSTALLATION INSTRUCTIONS

LLOYD'S BUILDING – LONDON TOWER – T7

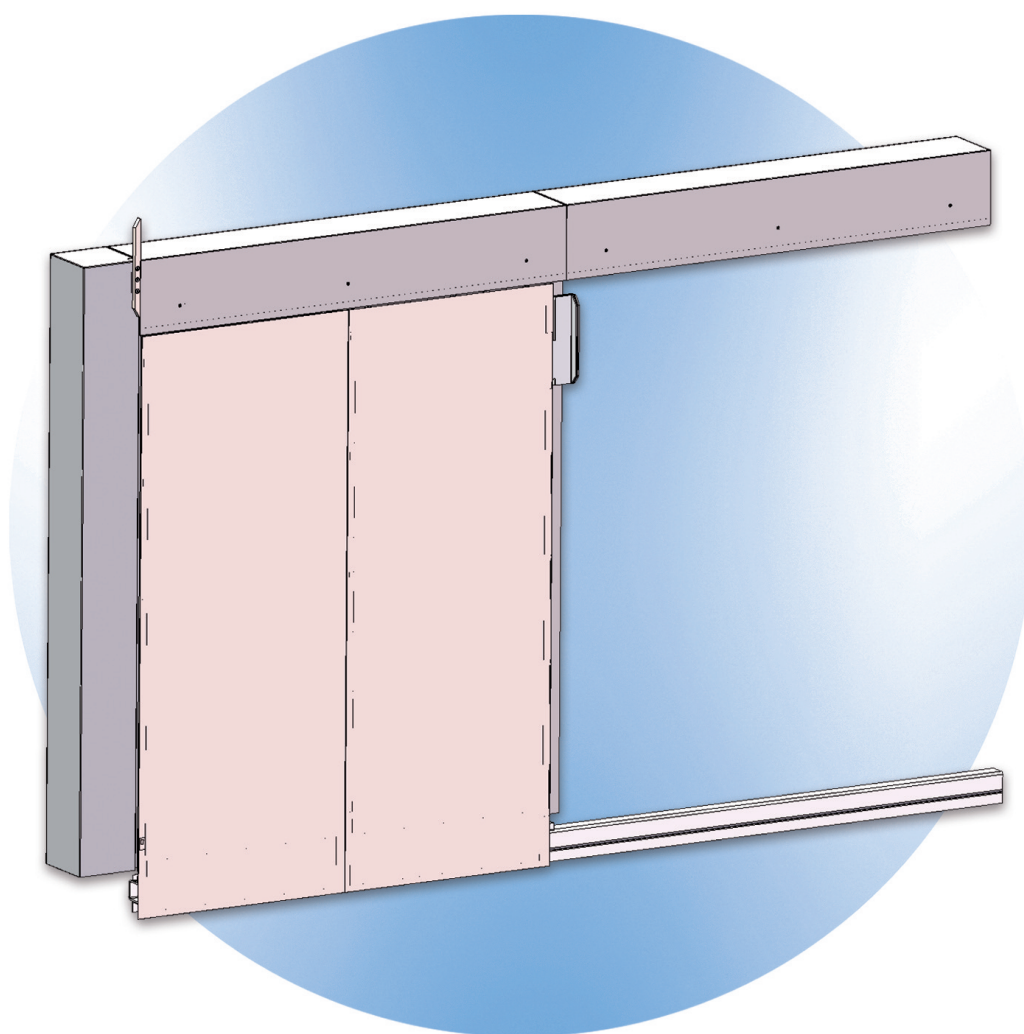

No part of this publication may be reproduced or translated, even in part, without prior written permission from WITTUR.

© Copyright WITTUR 2016

URL: <http://www.wittur.com>
e-mail: info@wittur.com

Subject to change without notice!

1. MECHANISM INSTALLATION

1.1. Remove the old components



1.2. Existing IPE

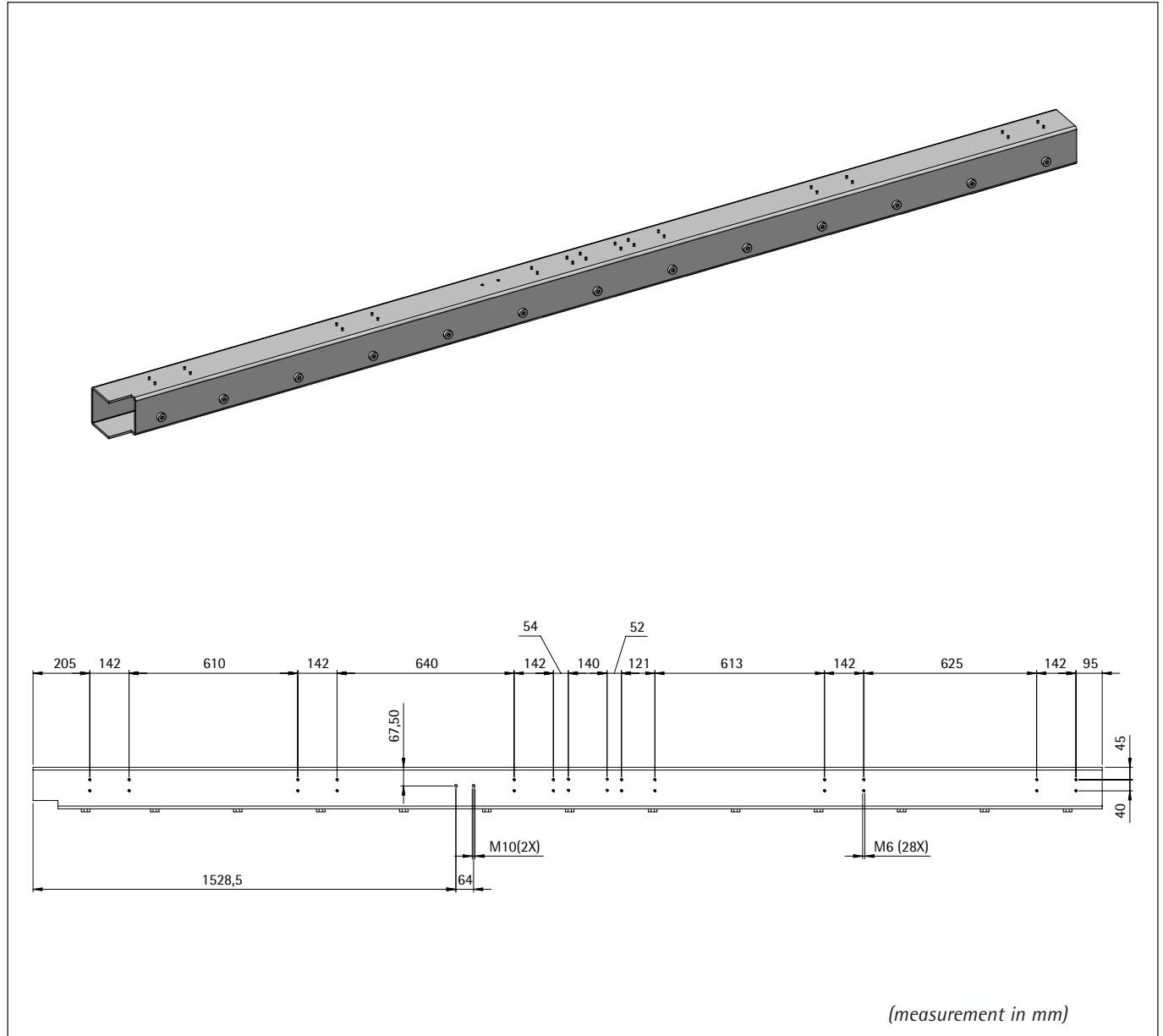

Check if the holes are in the right position and drill the missing holes.

1.3. Unpackaging of the landing mechanism

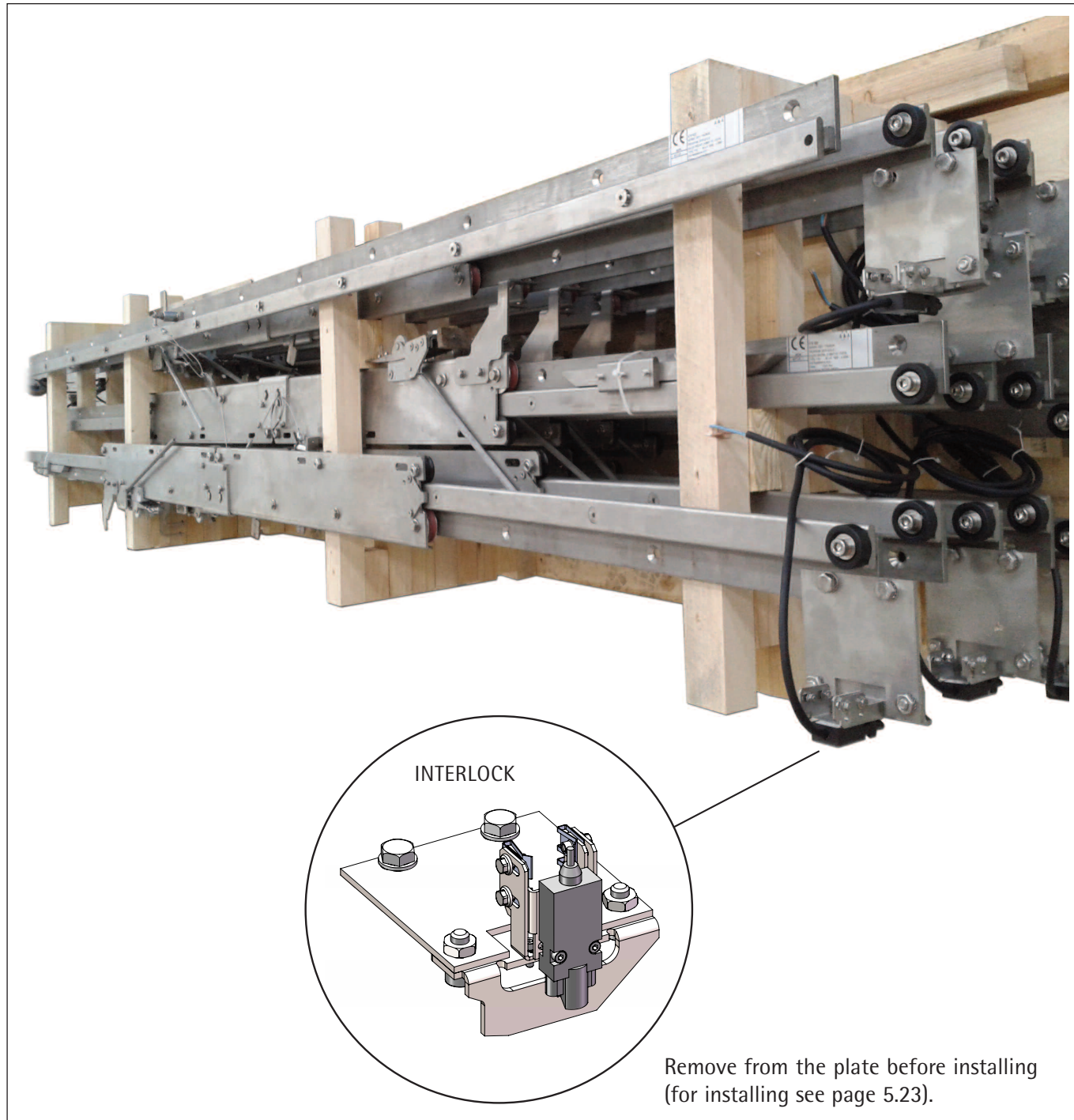

2. LANDING DOOR MECHANISM INSTALLATION ON THE EXISTING IPE



Fix the mechanism directly on the existing spacer, the spacers welded on the IPE profile.

2.1. Fix the interlock as shown

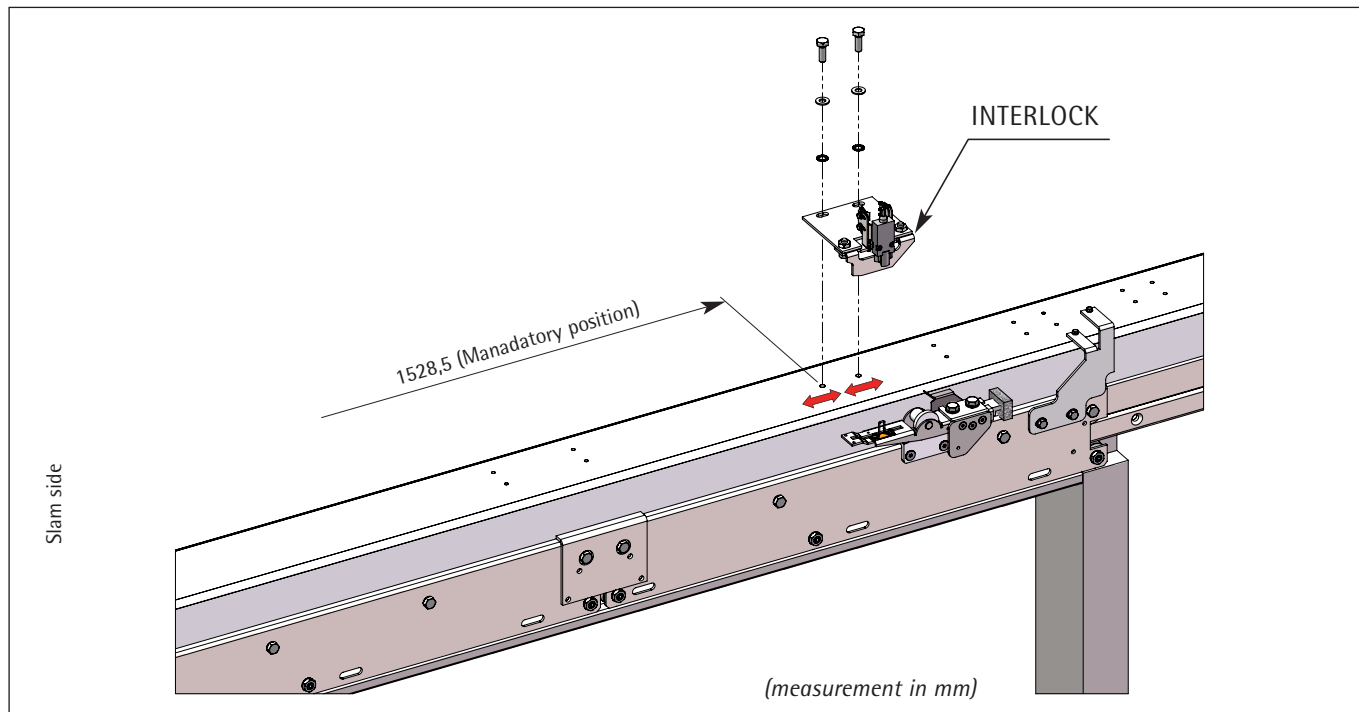

2.2. Fix the emergency device as shown

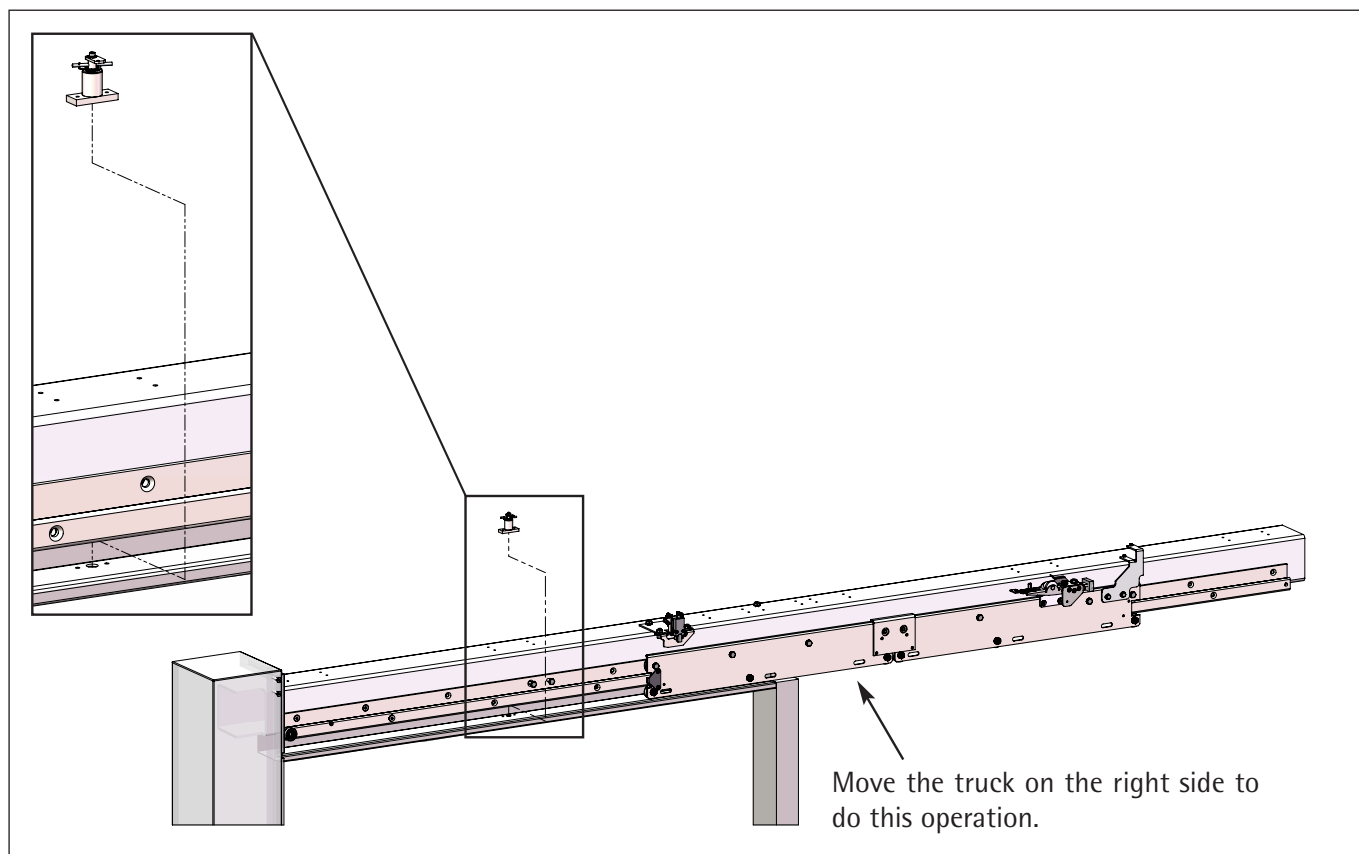

2.3. Emergency rope

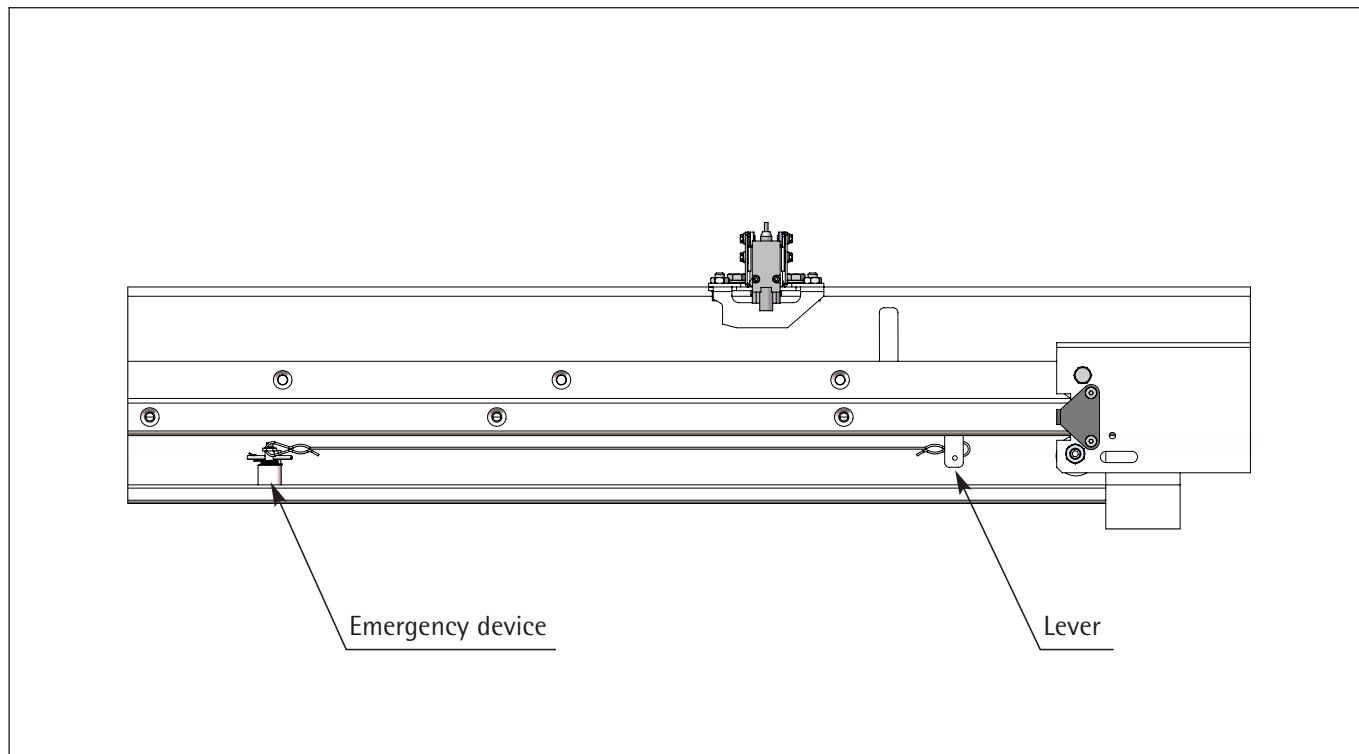

Fix the emergency rope from the lever to the emergency device.

2.4. Installation of spirator reclosing spring

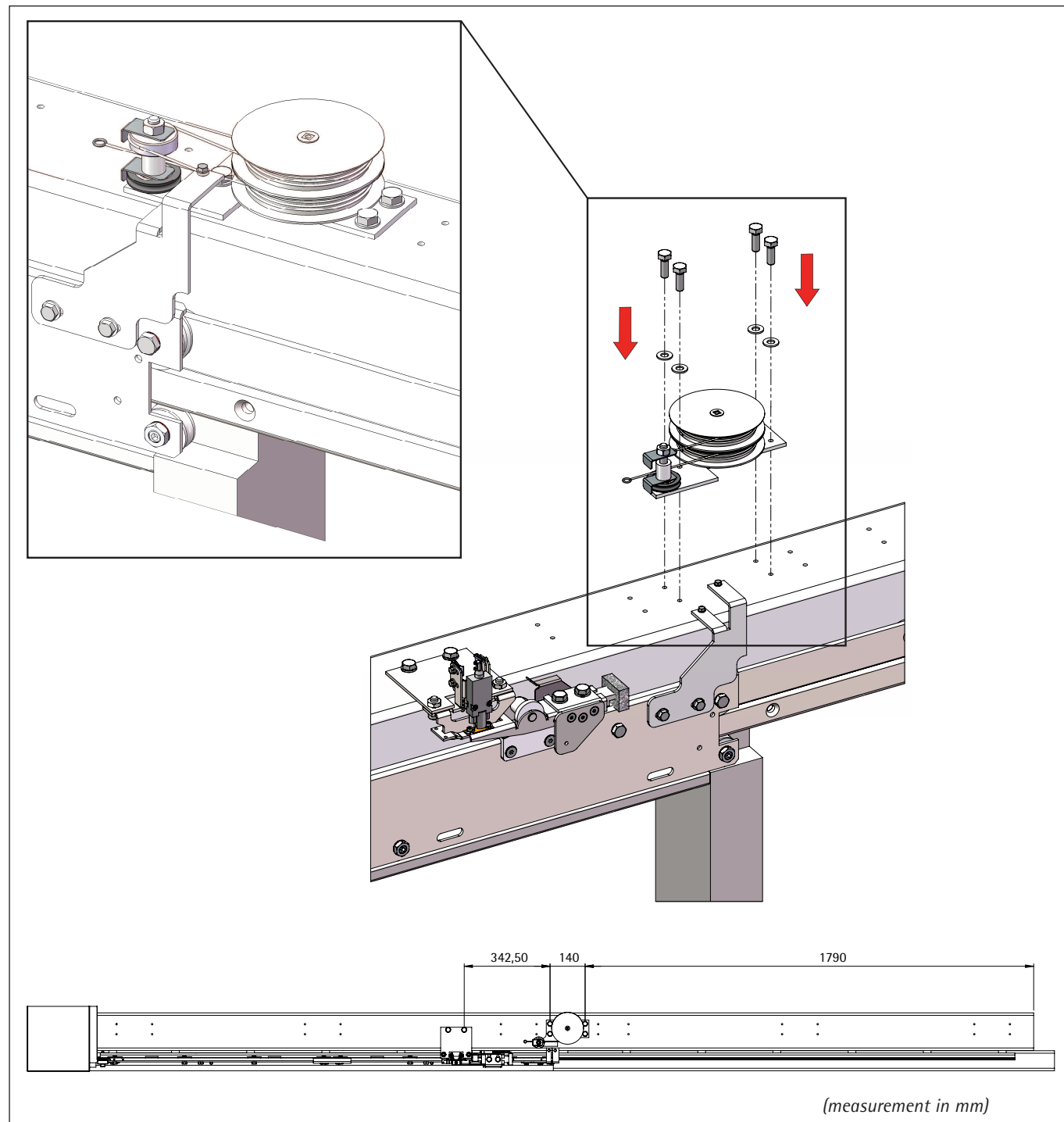

Fix the spirator springs as shown with M6 screw.

3. PANELS INSTALLATION

3.1. Disassembly of the panel Step 1

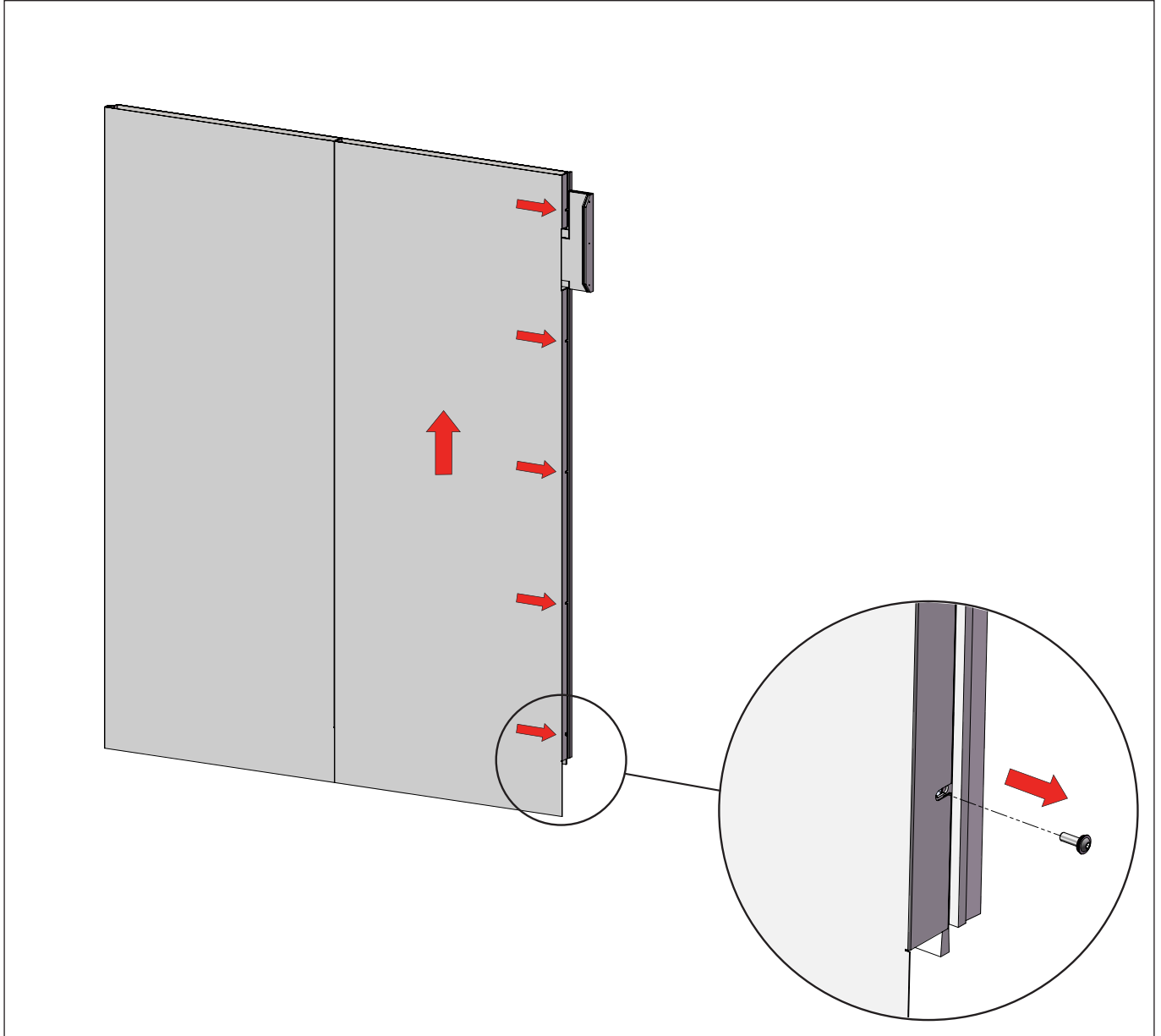

Remove the screws from the panel side as shown.

3.2. Disassembly of the panel Step 2

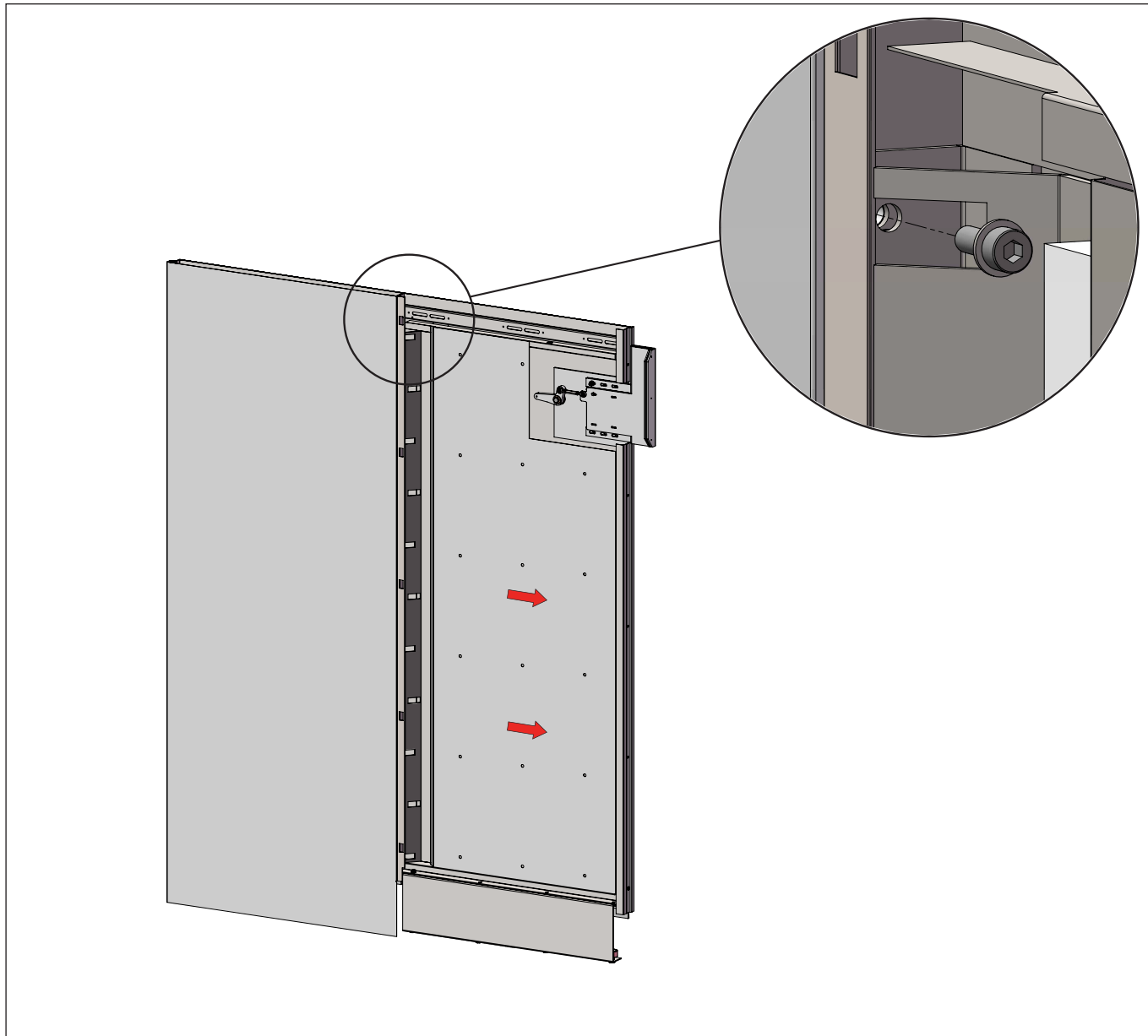

Remove the screws in the middle of it, and divide the panels.

3.3. Disassembly of the lower shoes

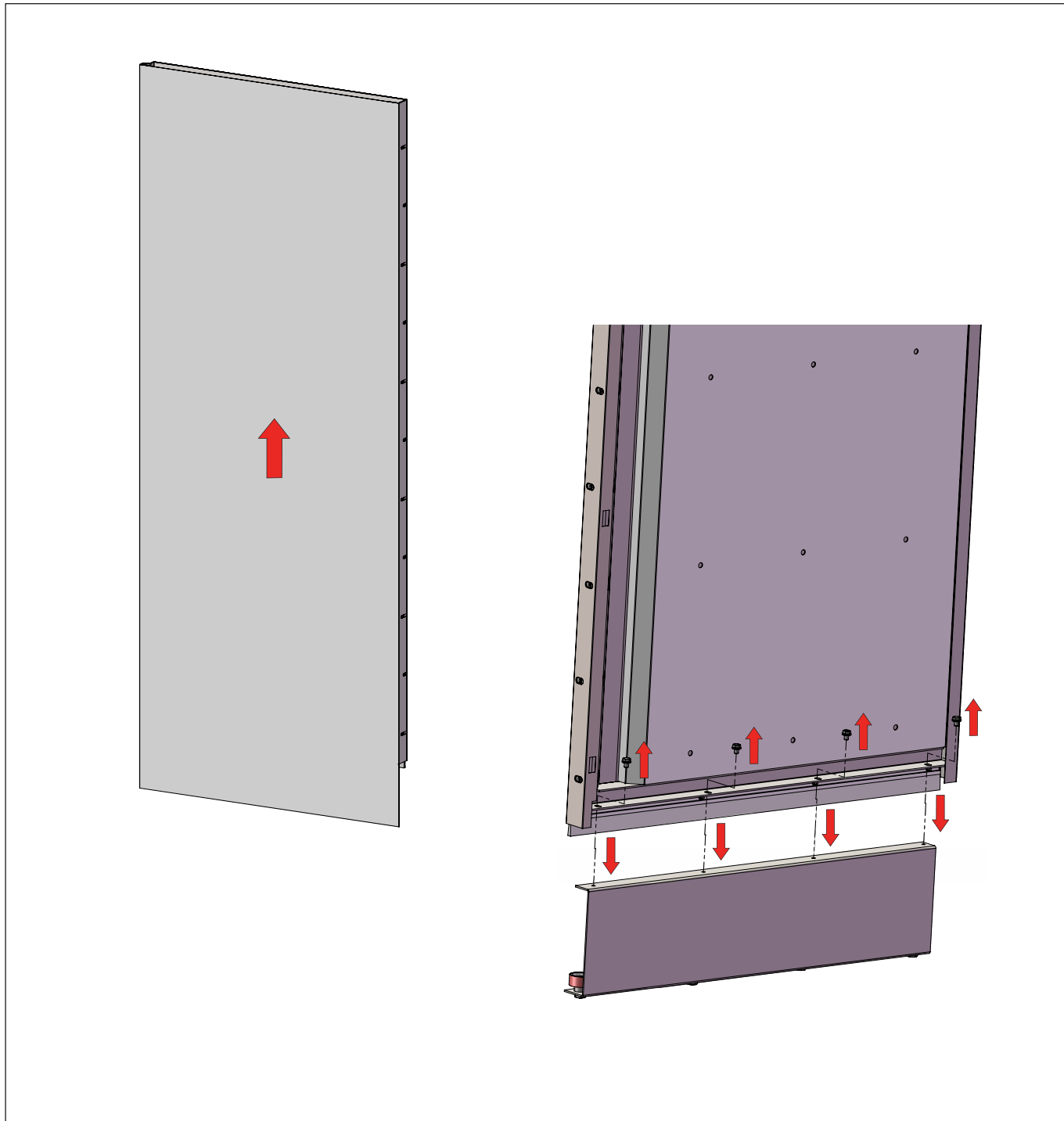

Remove the lower shoes as shown.

3.4. Assembly of hanger bolts

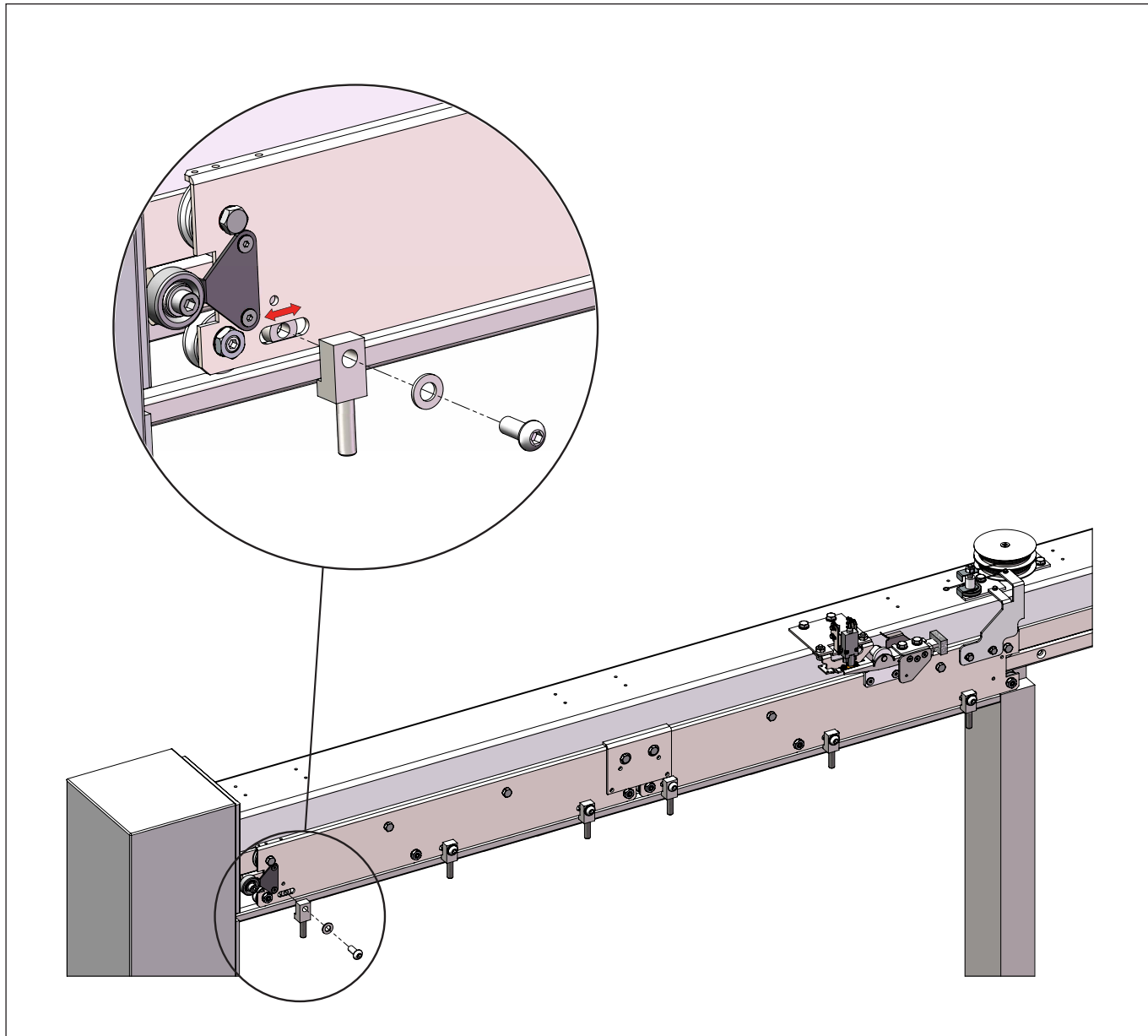

3.5. Assembly of the top brackets

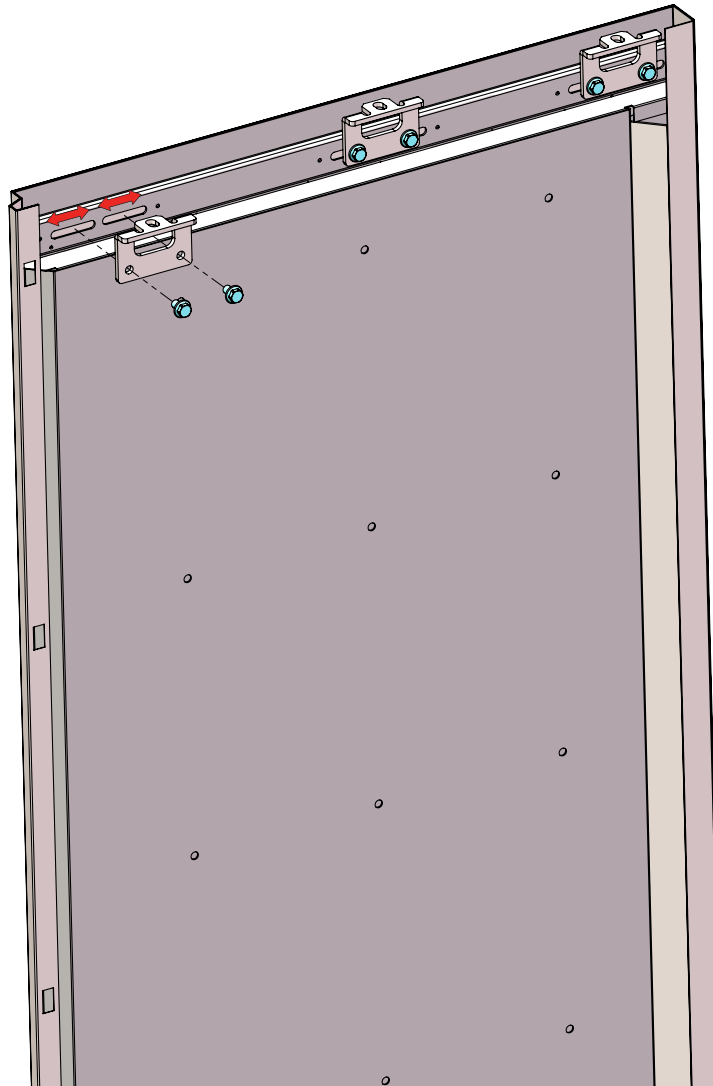

Fix the top brackets, on the panel as shown. Three each panel.

3.6. Assembly of the panel to the mechanism

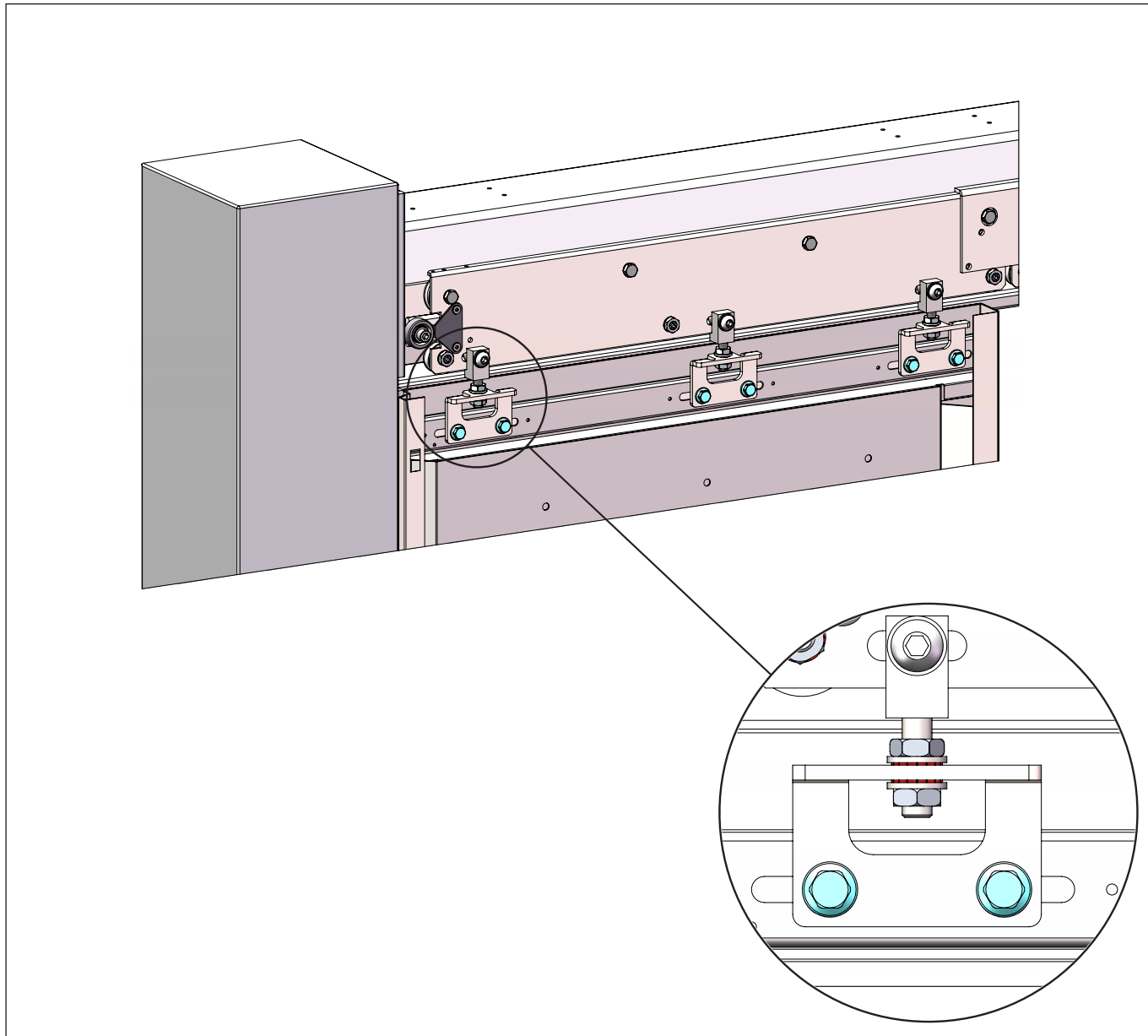

Fix the three brackets to the hanger bolts as shown.

3.7. Disassembly of the truck

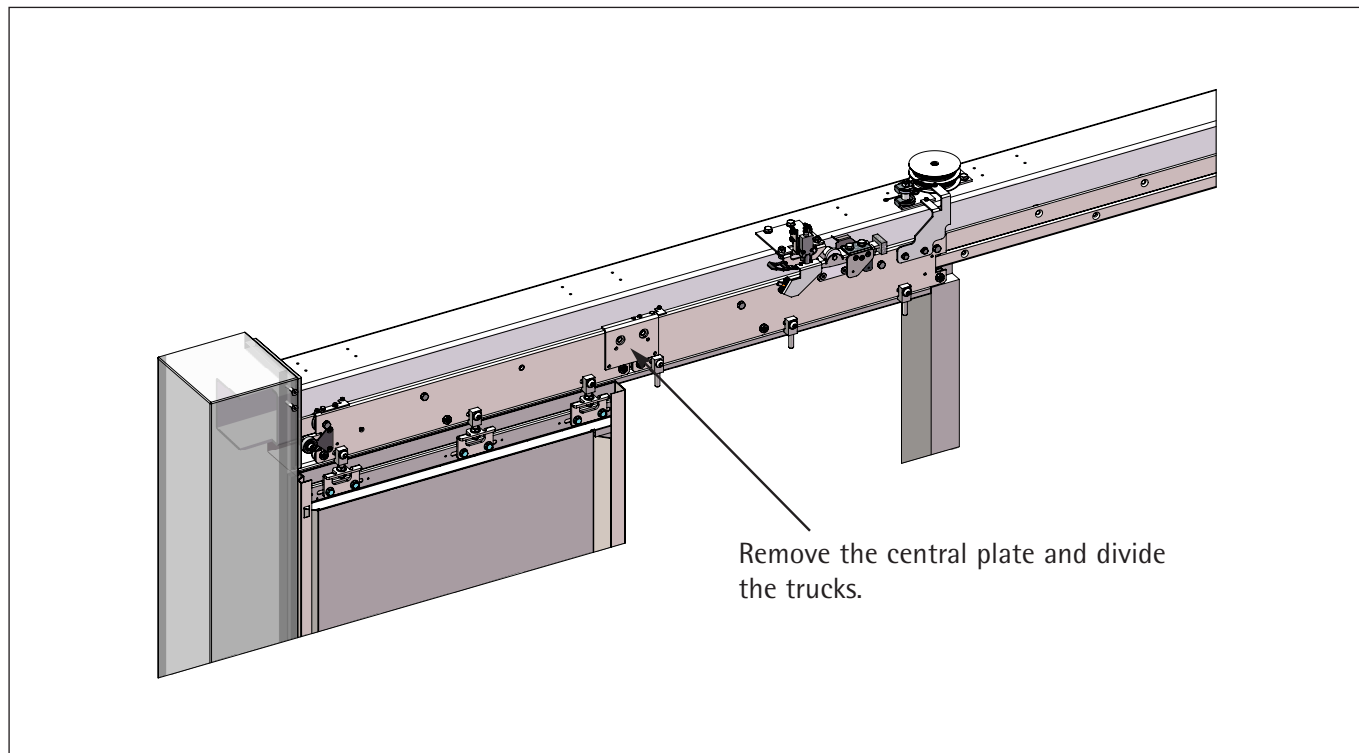

3.8. Assembly of the other panel

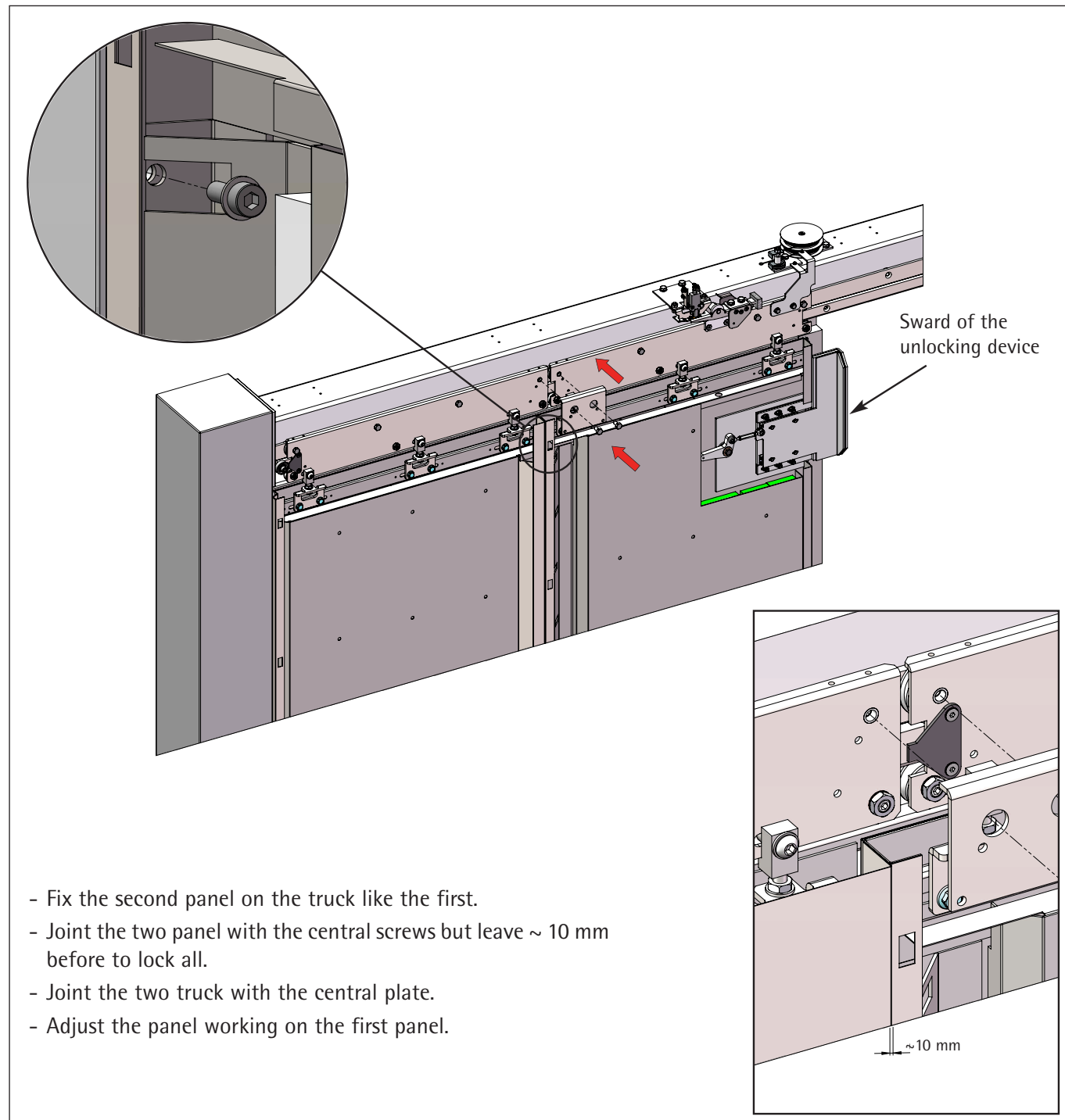

3.9. Joint the panel and truck

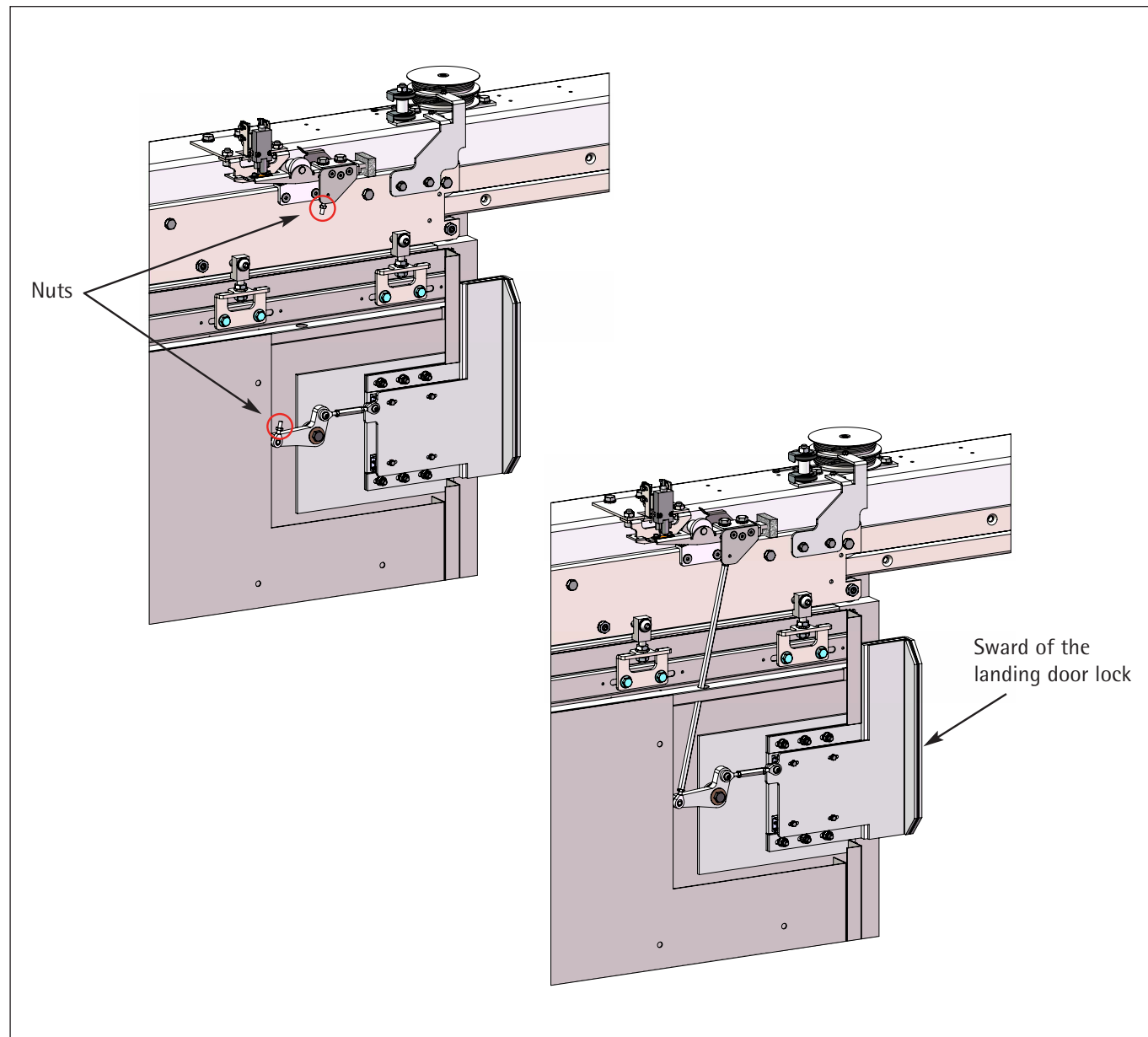

Joint the landing door sword (of the lock of the panel) and the lock with the rod supplied.

3.10. Lower shoes assembly

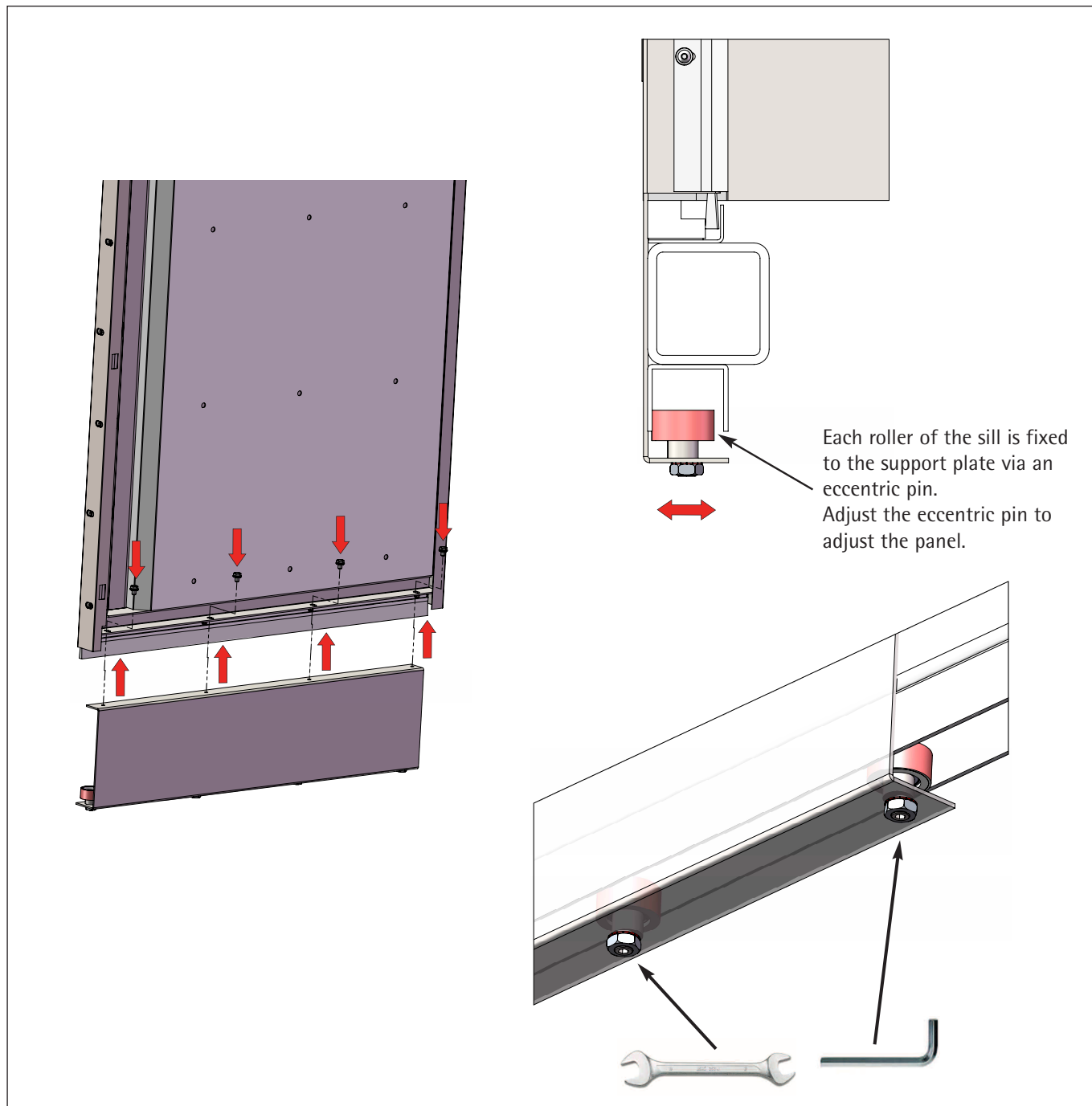

Fix the shoes on the panel and make all the adjustment on it.

3.11. Panel cover assembly

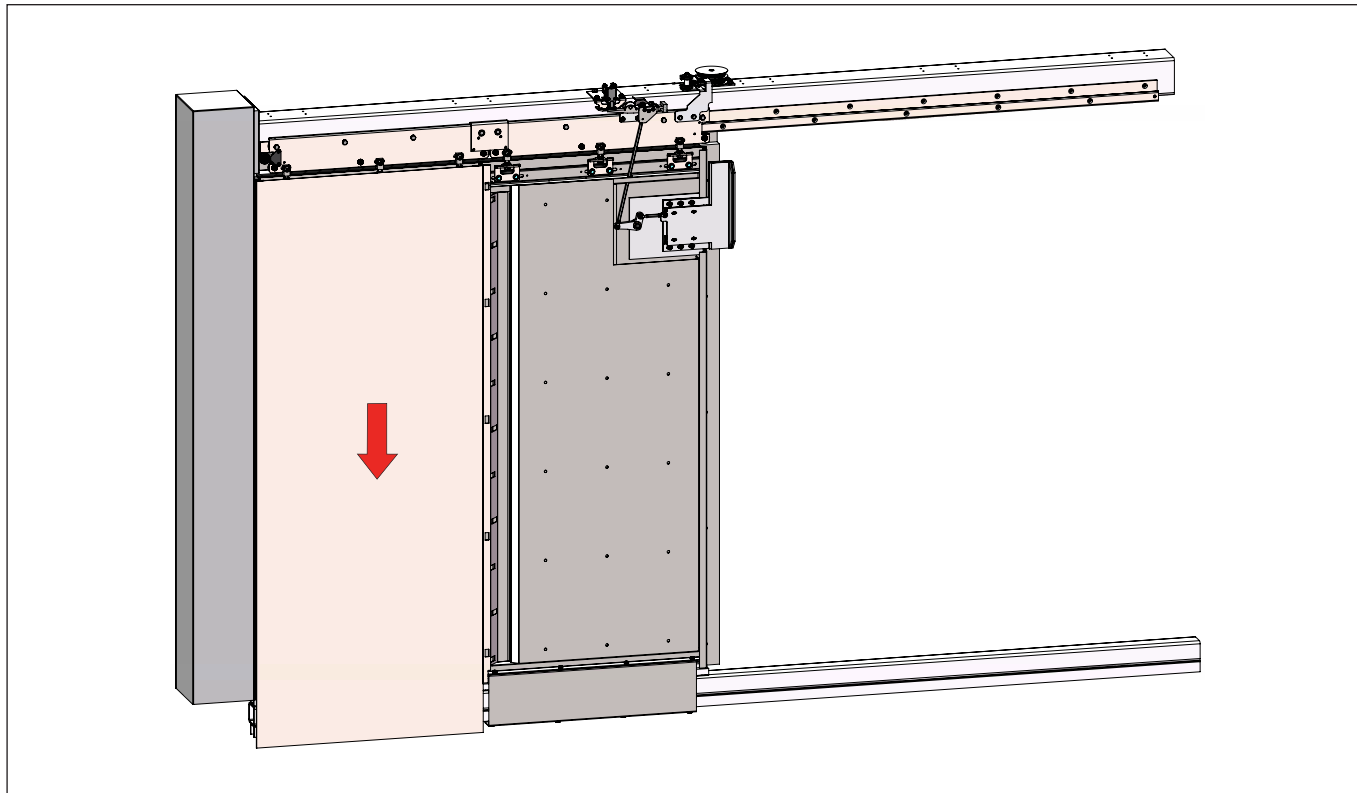

First cover to assembly.

In case the door doesn't reclose with the help of reclosing system, first check if there's a gap between the panel and if there's a gap remove the plate, and tighten close the panel to eliminate the gap.

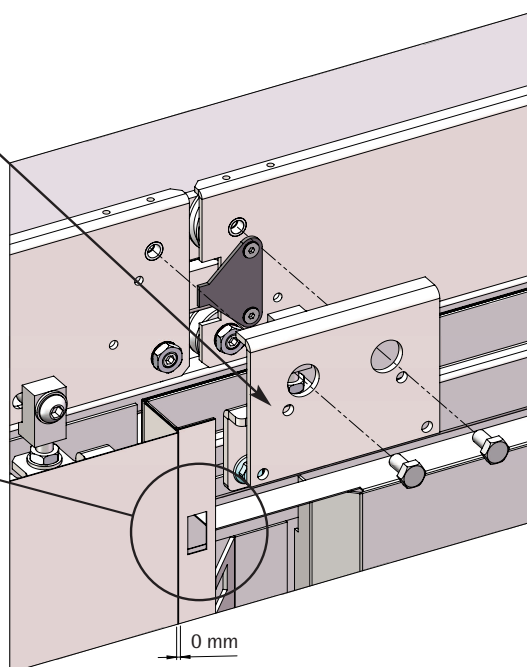
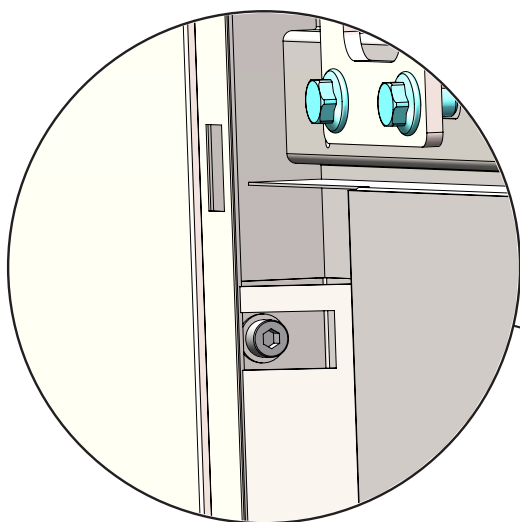

- Fix the cover on the first panel and after joint them.
- Now the gap should be 0 mm.

Panel cover assembly

Increase the tension of the spring reclosing system.
Do it step by step first one spin of rope and try to open the door.

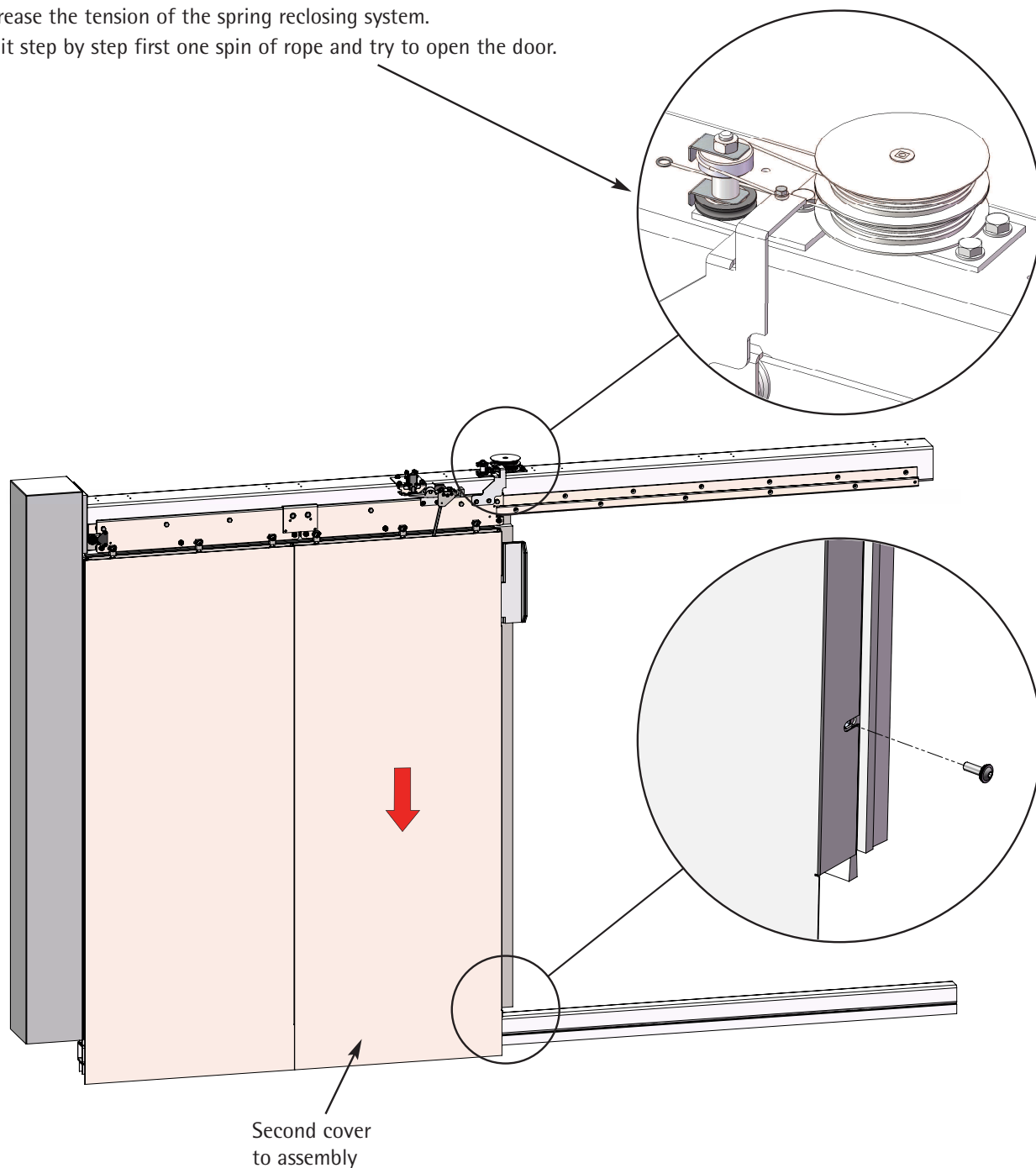

Assembly the cover on the second panel and fix it with the screws on the side.

3.12. The new top brackets assembly

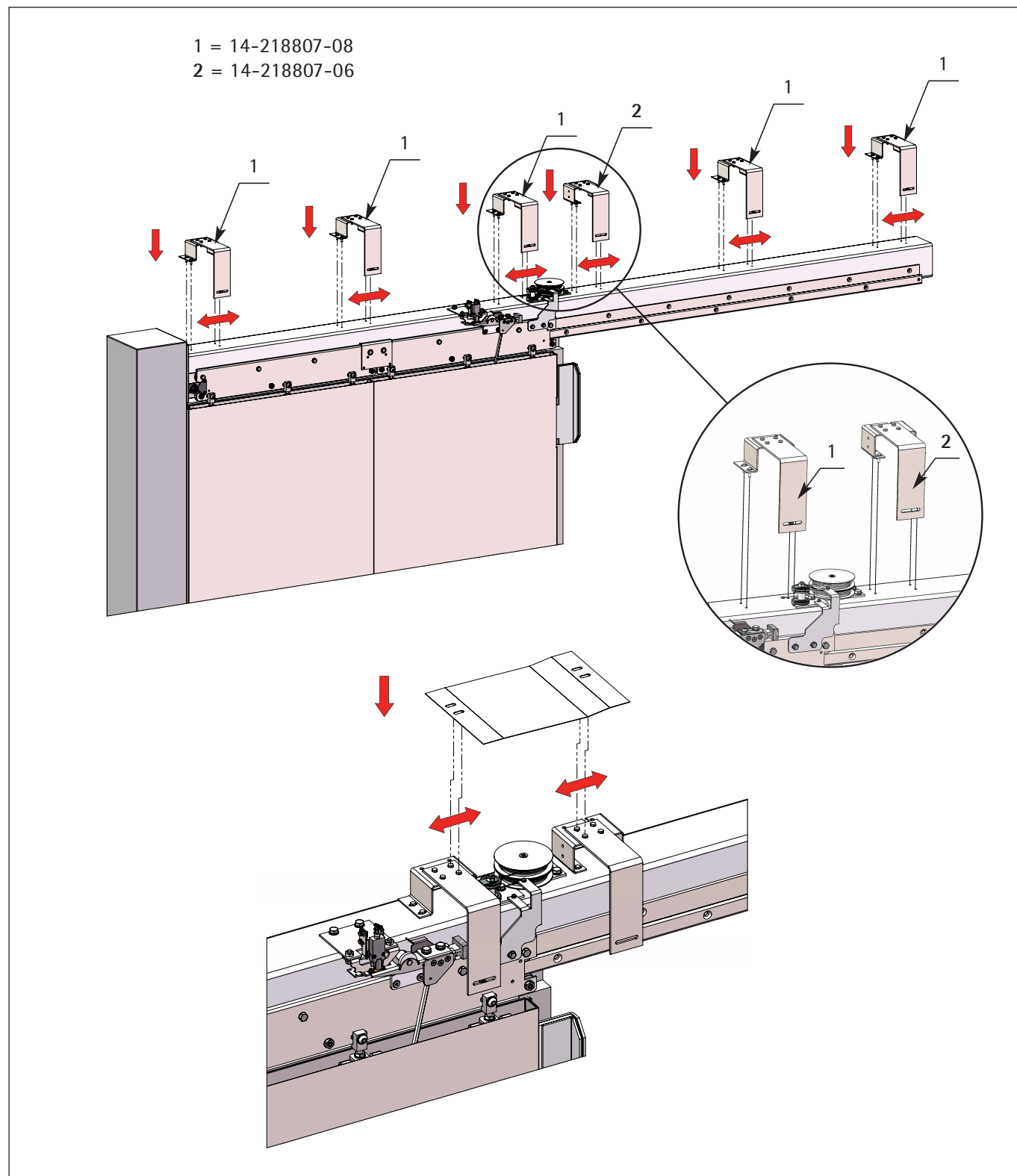

Fix the new top brackets on the existing IPE and after fix the cover on the spirator spring.

3.13. Top cover of the mechanism

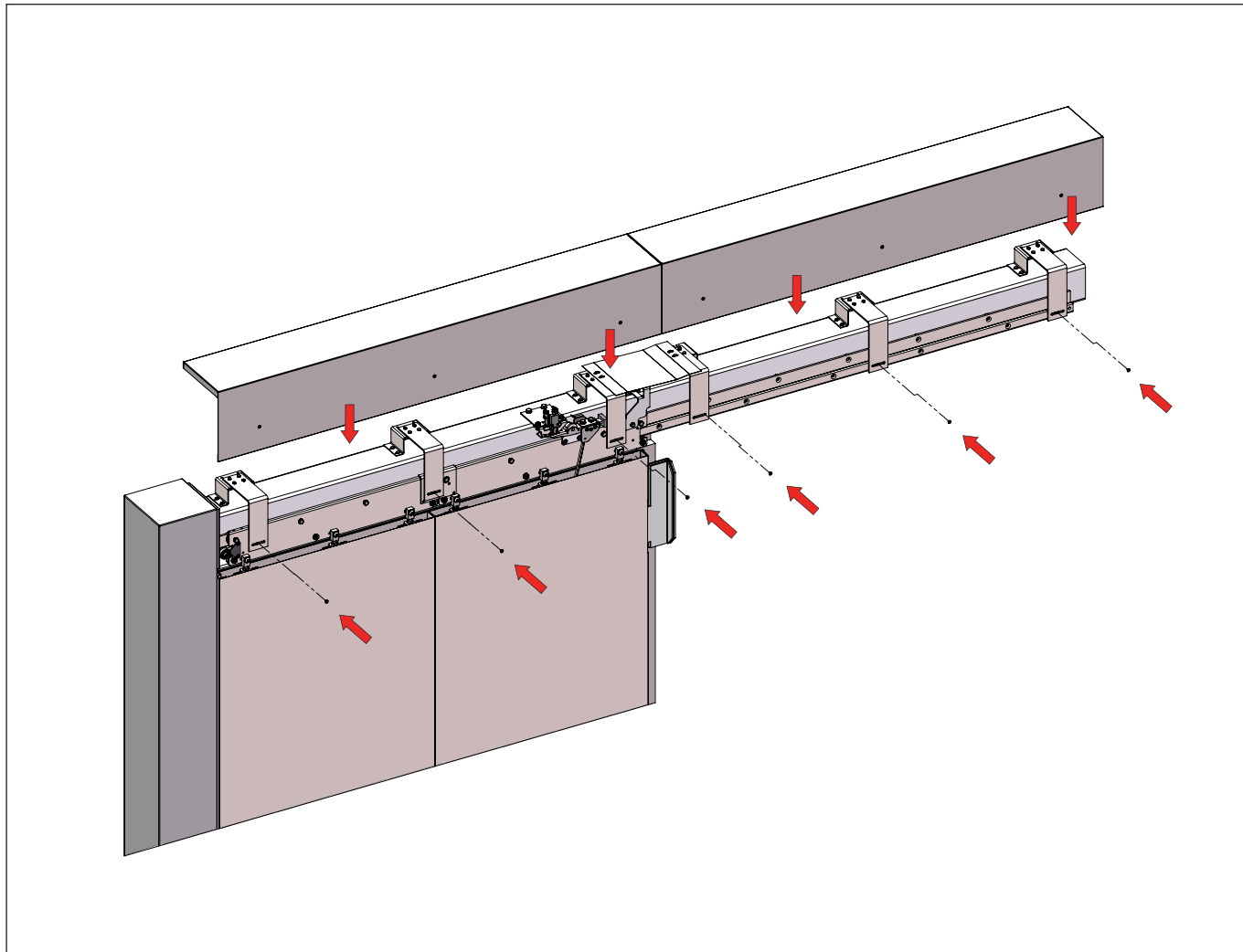

3.14. Top cover of the mechanism assembly

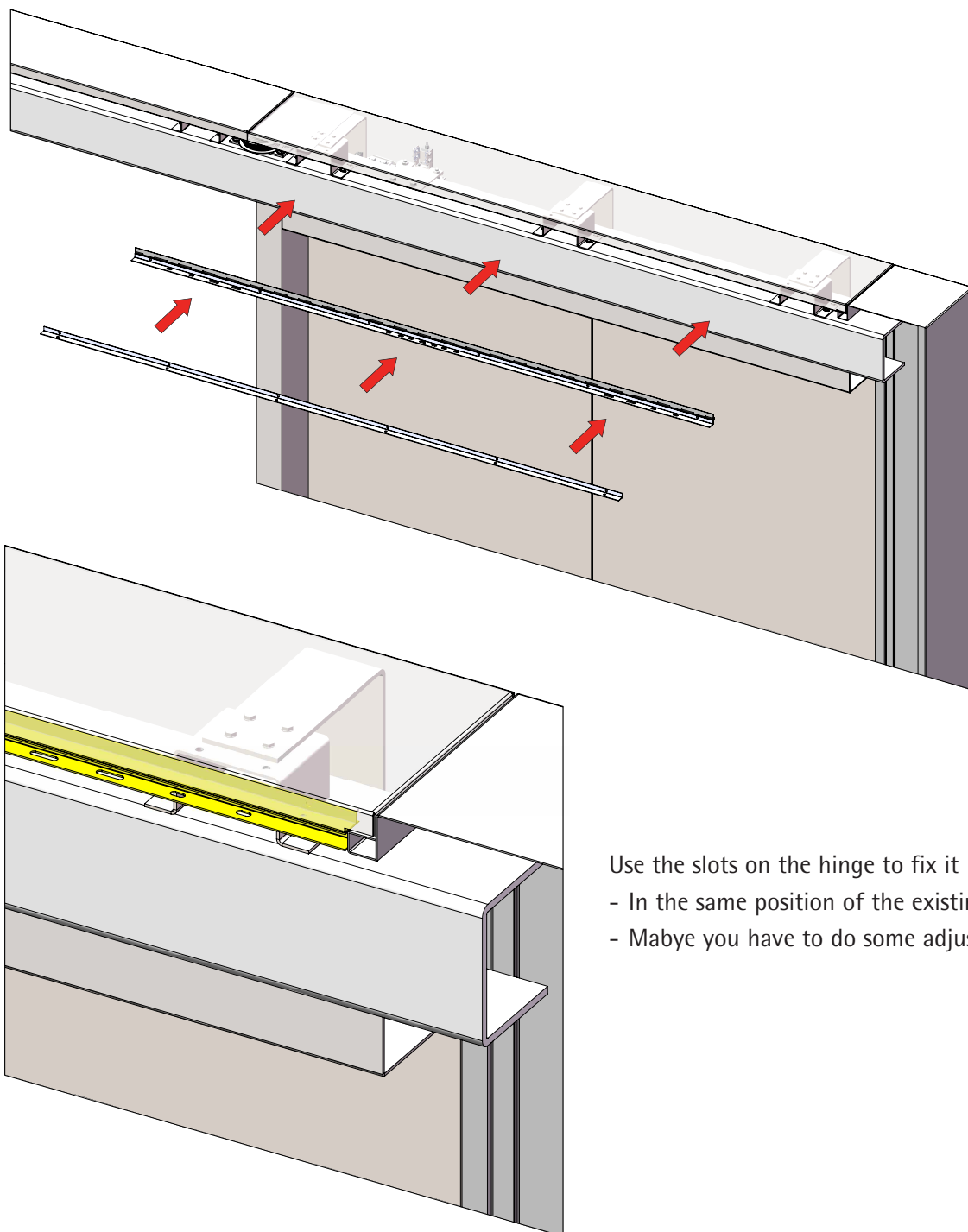

Use the slots on the hinge to fix it

- In the same position of the existing one.
- Maybe you have to do some adjustment.

3.15. Assembly of fix cam

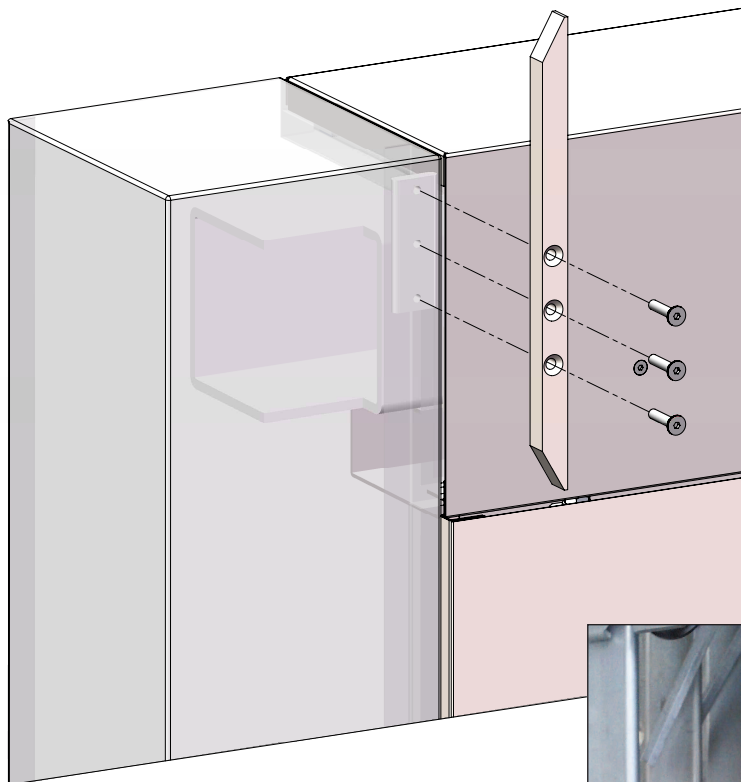

Disassembly the fix cam from the mechanism.

- After all, fix it on the existing frame. As shown.



Pay attention!!

- Fix the fix cam after the car door assembly.

