

Released for Production

©WITTUR HOLDING GmbH

The reproduction, distribution and utilization of this document as well as the communication of its contents to others without express authorization is prohibited. Offenders will be held liable for the payment of damages. All rights reserved in the event of the grant of a patent, utility model or design. Il riproduzione, distribuzione e utilizzo di questo documento o la comunicazione dei suoi contenuti ad altri senza autorizzazione esplicita è espressamente vietata. I trasgressori saranno ritenuti responsabili del pagamento di danni. Tutti i diritti riservati in caso di concessione di un brevetto, modello di utilità o design.

1	Landing Door Mechanism	1039602
2	Mechanism Bracket	1045941
3	Panel Adapter Angle	order bound
4	Lockrollers	0905040

60"	(1524mm)	734,8
59"	(1498,6mm)	722,1
58"	(1473,2mm)	709,4
57"	(1447,8mm)	696,7
56"	(1422,4mm)	684
55"	(1397mm)	671,3
54"	(1371,6mm)	658,6
53"	(1346,2mm)	645,9
52"	(1320,8mm)	633,2
51"	(1295,4mm)	620,5
50"	(1270mm)	607,8
49"	(1244,6mm)	595,1
48"	(1219,2mm)	582,4
47"	(1193,8mm)	569,7
46"	(1168,4mm)	557
45"	(1143mm)	544,3
44"	(1117,6mm)	531,6
43"	(1092,2mm)	518,9
42"	(1066,8mm)	506,2
41"	(1041,4mm)	493,5
40"	(1016mm)	480,8
39"	(990,6mm)	468,1
38"	(965,2mm)	455,4
37"	(939,8mm)	442,7
36"	(914,4mm)	430
35"	(889mm)	417,3
34"	(863,6mm)	404,6
33"	(838,2mm)	391,9
32"	(812,8mm)	379,2
CO		LA = (CO/2) - 27,2

Mechanism Bracket 1045941

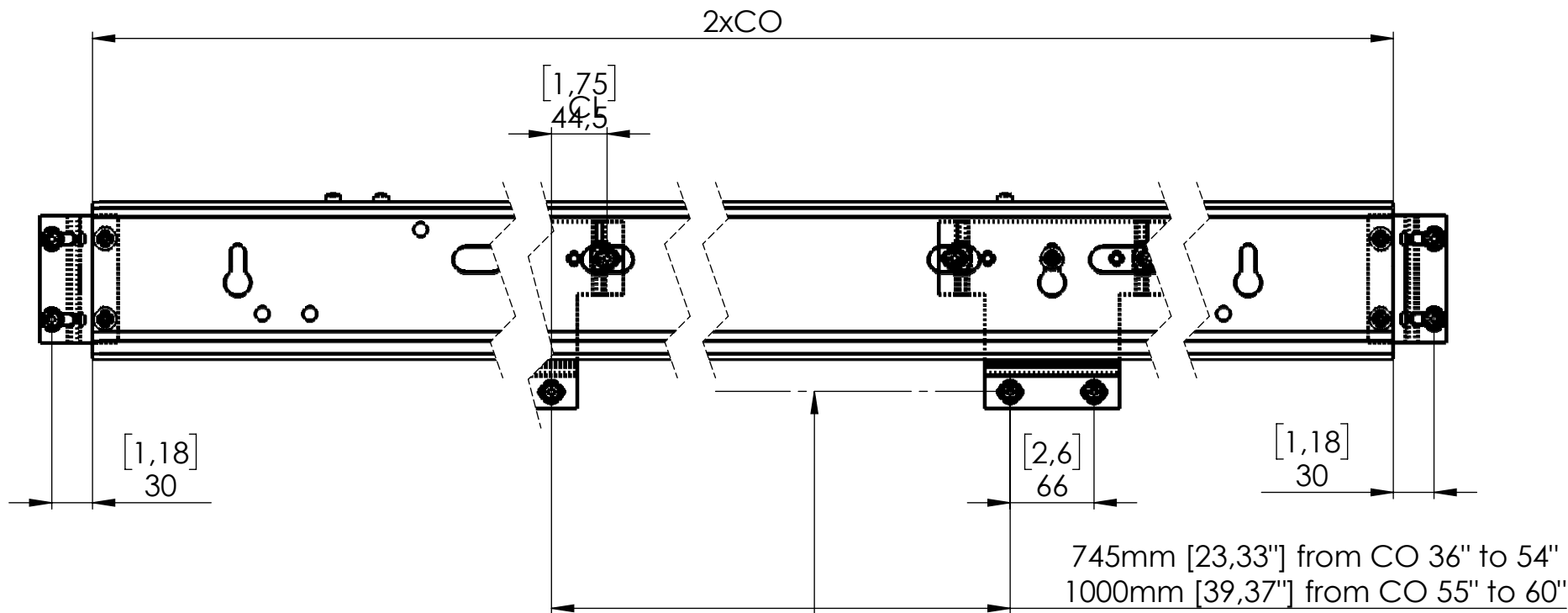

Panel Adapter Interface

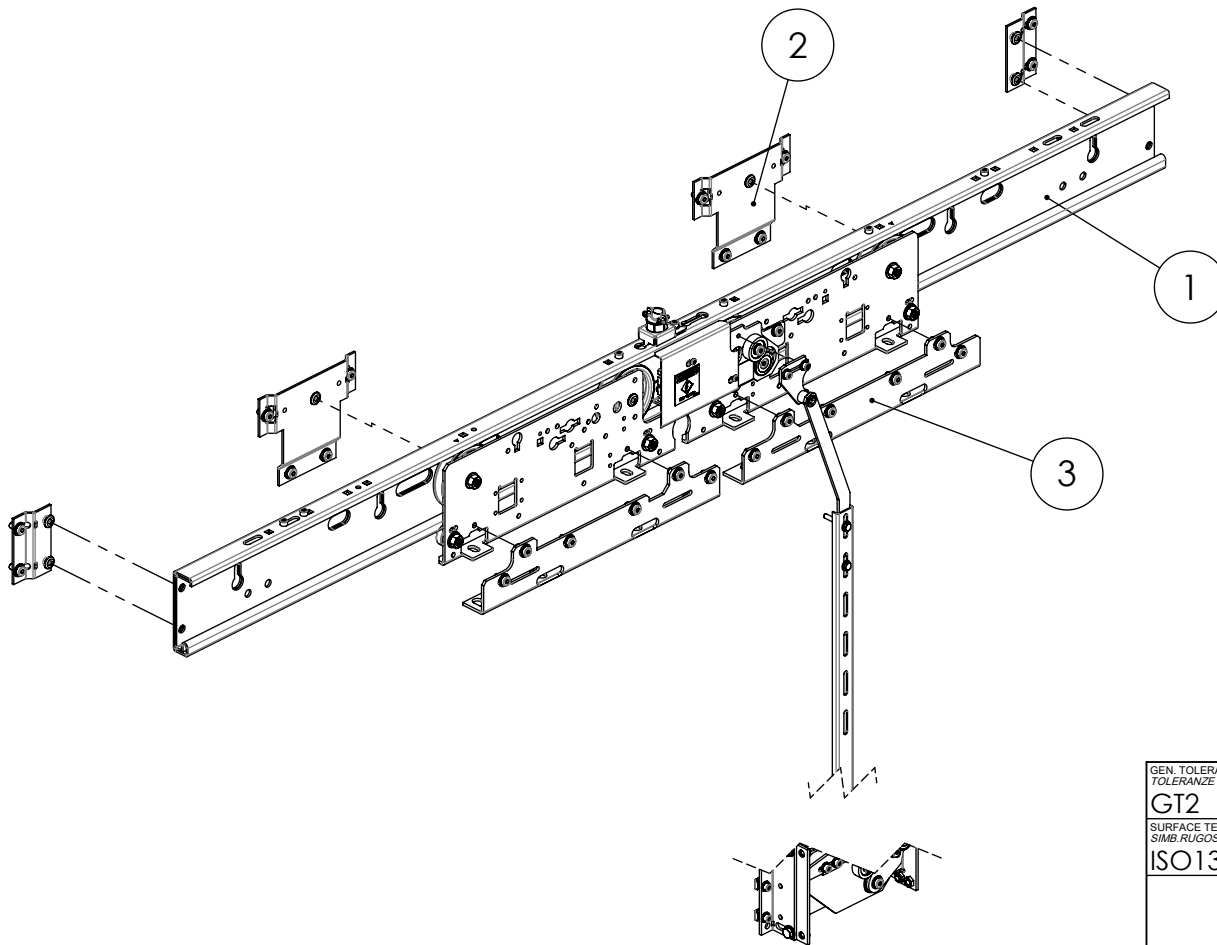
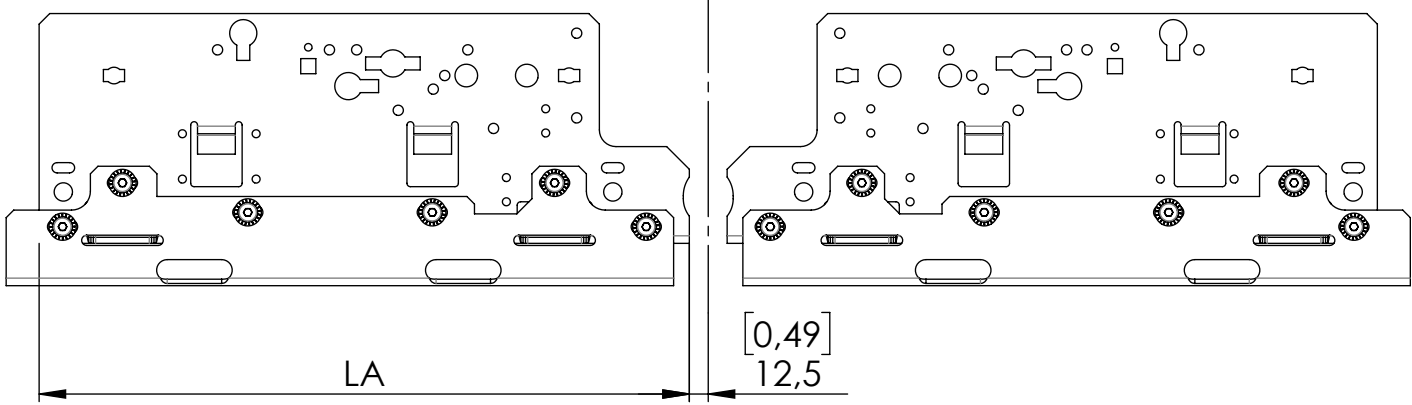

Lockrollers 0905040

CL

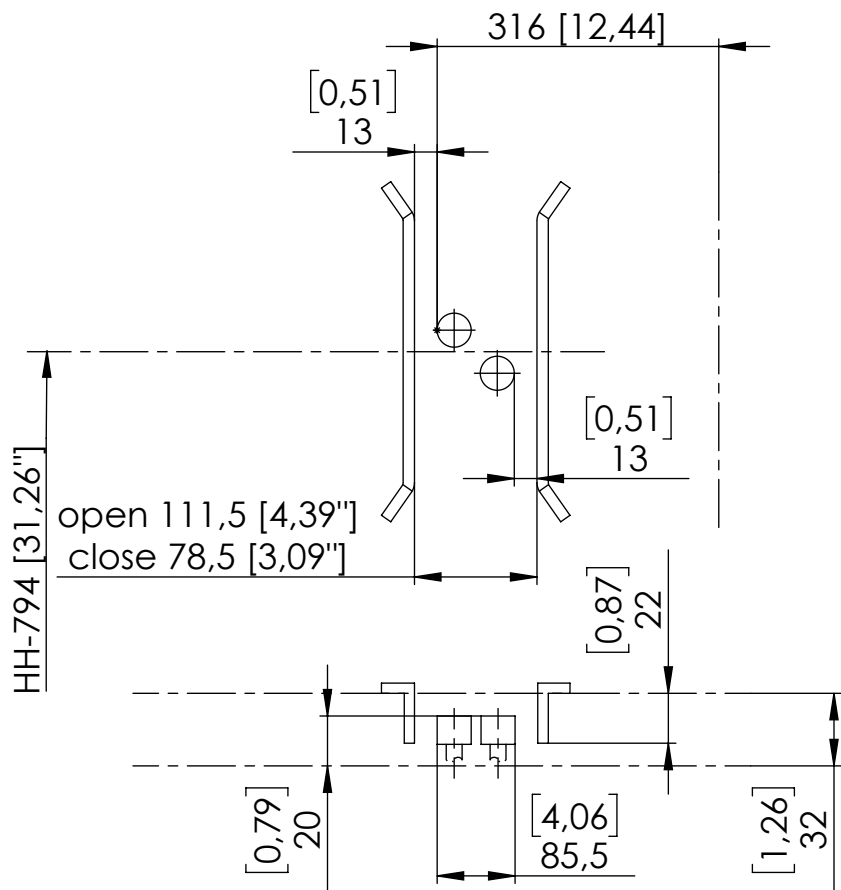
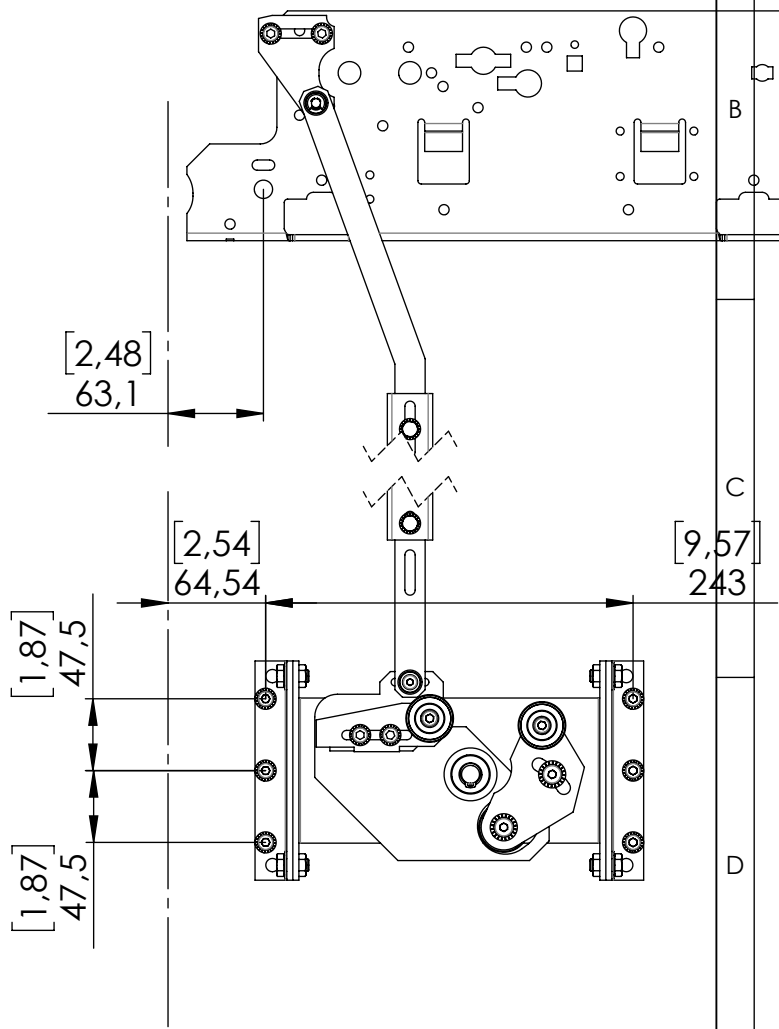

GEN. TOLERANCE WST-0003 TOLERANCE GEN. WST-0003 GT2	FUNCTIONAL CLASS CLASSE FUNZIONALE B	DESCRIPTION Quick installation guide WH SGV NA - 2C - LD	PRODUCT CATEGORY CATEGORIA PRODOTTO 2 - DOORS	PRODUCT CODE CODICE PRODOTTO SGV
SURFACE TEXTURE SYMBOLS SIMB. RUGOSITÀ SUPERFICIALE ISO1302	GEOM. TOLERANCE SYMBOLS SIMB. TOLLERANZE GEOM. ISO1101	ADD. DESCRIPTION DESCRIZIONE	SCALE SCALA 1:10	DESIGNED BY DISEGNATO DA ATIKalpaD
WITTUR		REVISION REVISIONE	SHEET FOGLIO NR 1/1	DRAWN BY DISEGNATO DA ATIKalpaD
1065744		DATE DATA 21/10/2020	REVISION REVISIONE -	FIRST APPROVAL PRIMA APPROVAZIONE dollima
		DATE DATA 02/11/2020	Released	