

Released for Production

©WITTUR HOLDING GmbH

The reproduction, distribution and utilization of this document as well as the communication of its contents to others without express authorization is prohibited. Offenders will be held liable for the payment of damages. All rights reserved in the event of the grant of a patent, utility model or design. Il riproduzione, distribuzione e utilizzazione di questo documento, così come la comunicazione dei suoi contenuti ad altri, senza autorizzazione espressa, è vietata. Gli autori saranno ritenuti responsabili per il pagamento di danni. Tutti i diritti riservati in caso di concessione di un brevetto, modello di utilità o design.

| | | |
|---|---------------------------|---------|
| 1 | Car Door Operator | 1046915 |
| 2 | Car Door Operator Bracket | 1039395 |
| 3 | Panel Adapter Angle | 0905052 |
| 4 | Car Door Interlock | 1031827 |

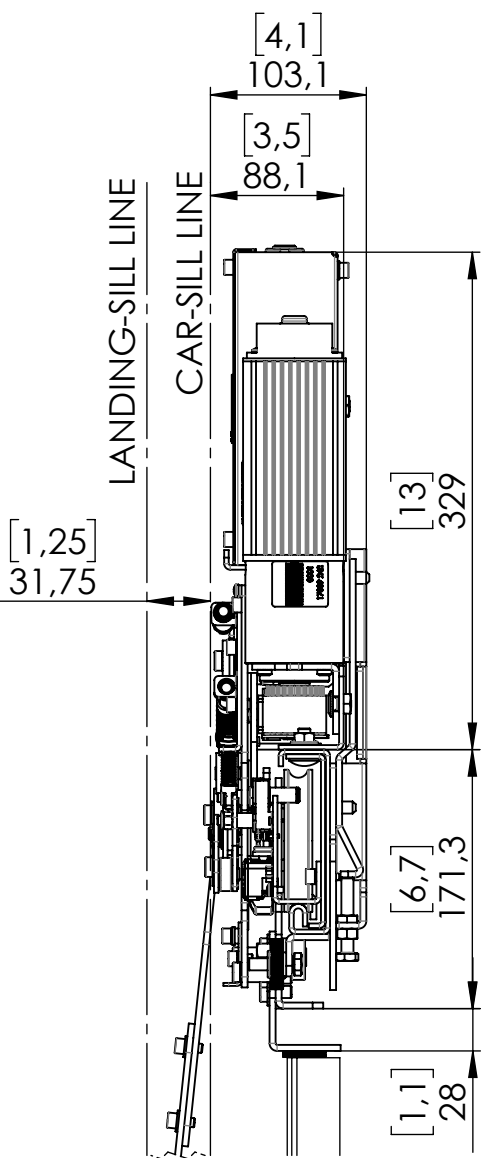
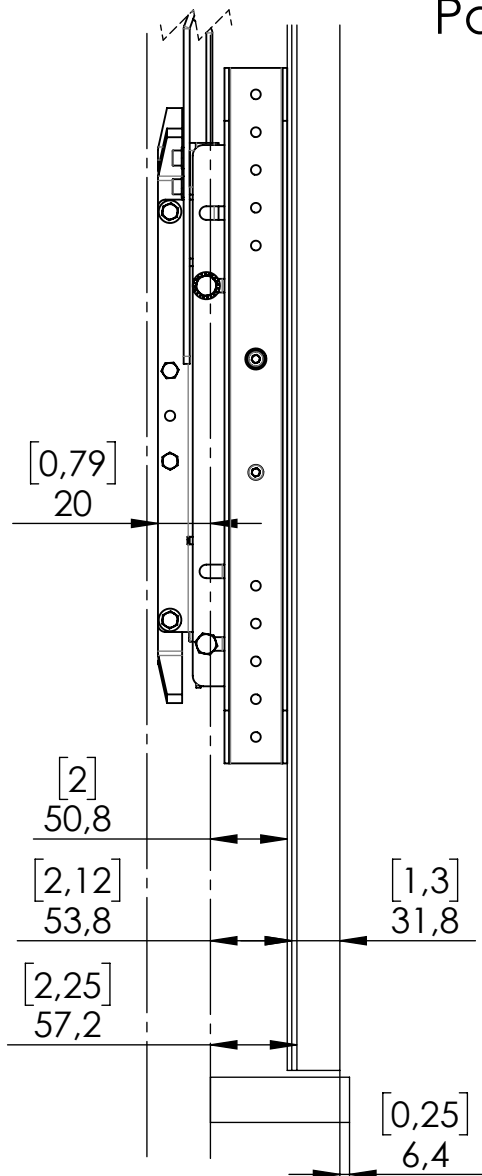

Panel Adapter Angle 0905052

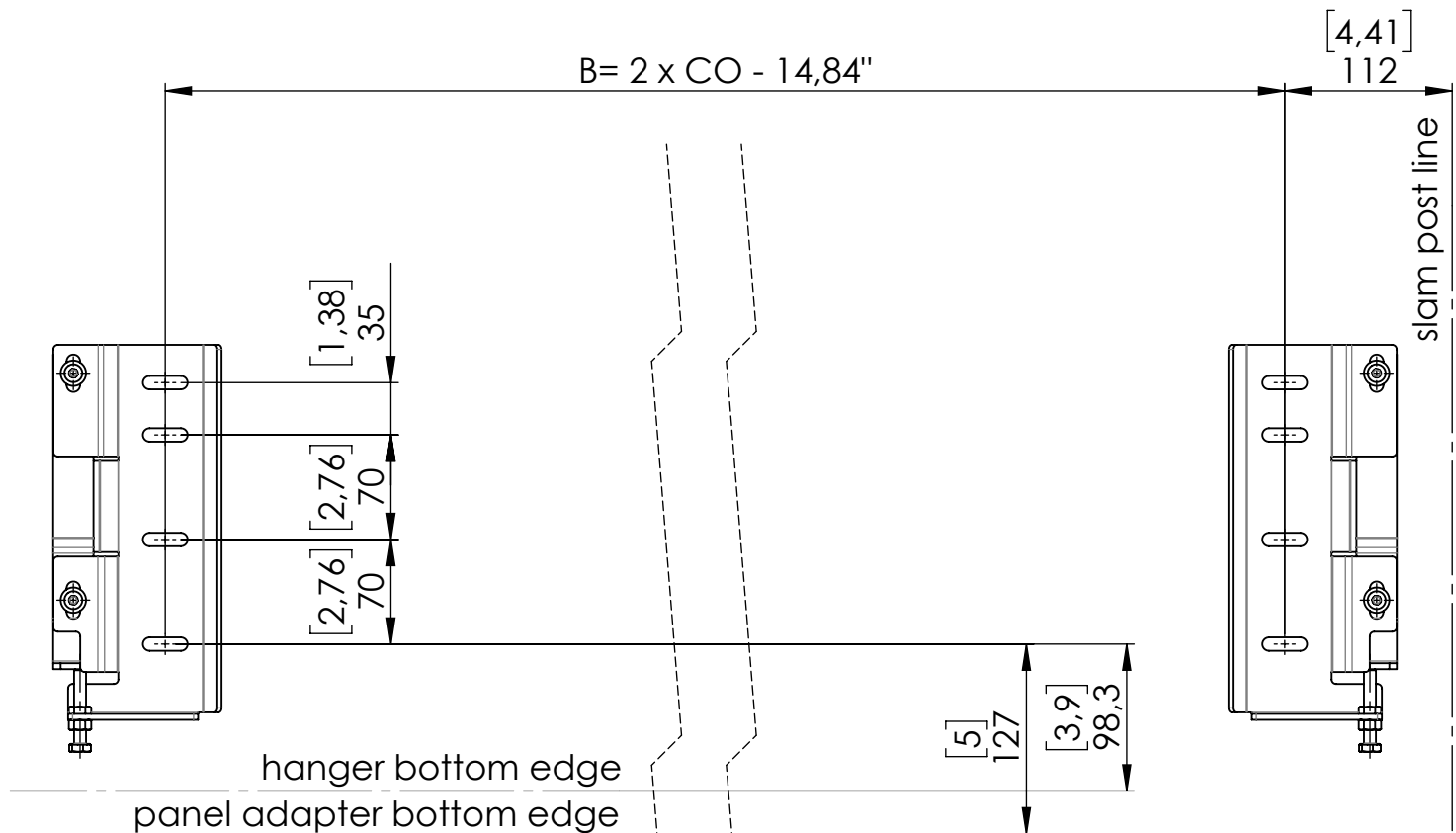
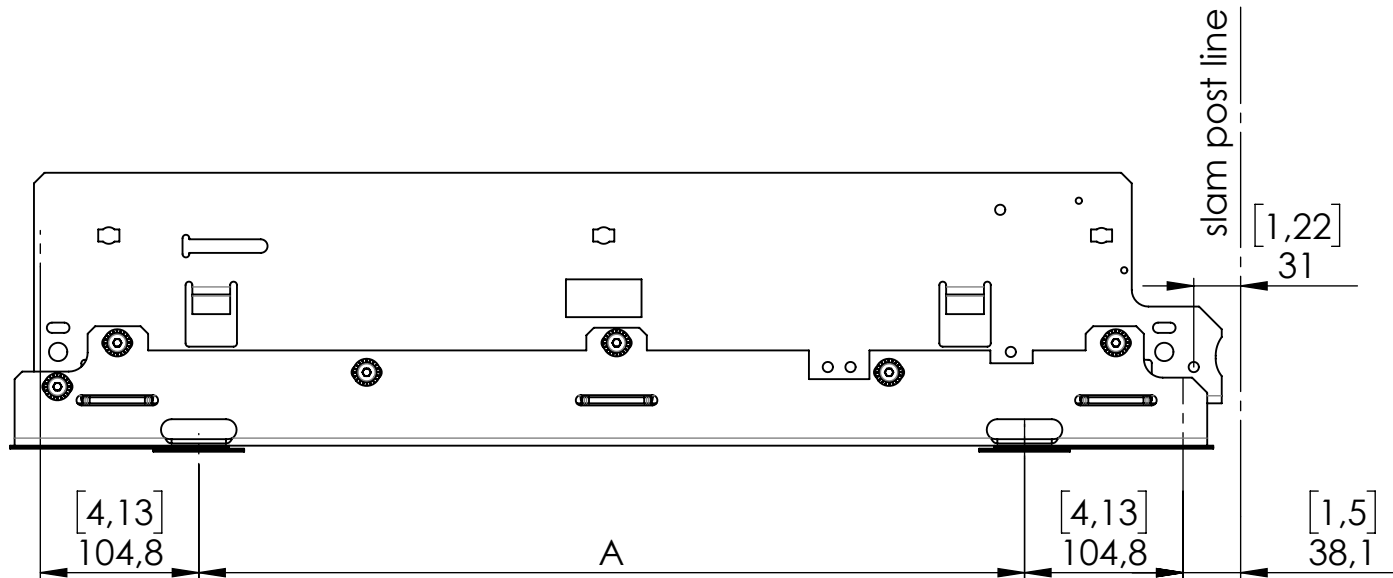

Car Door Bracket 1039395

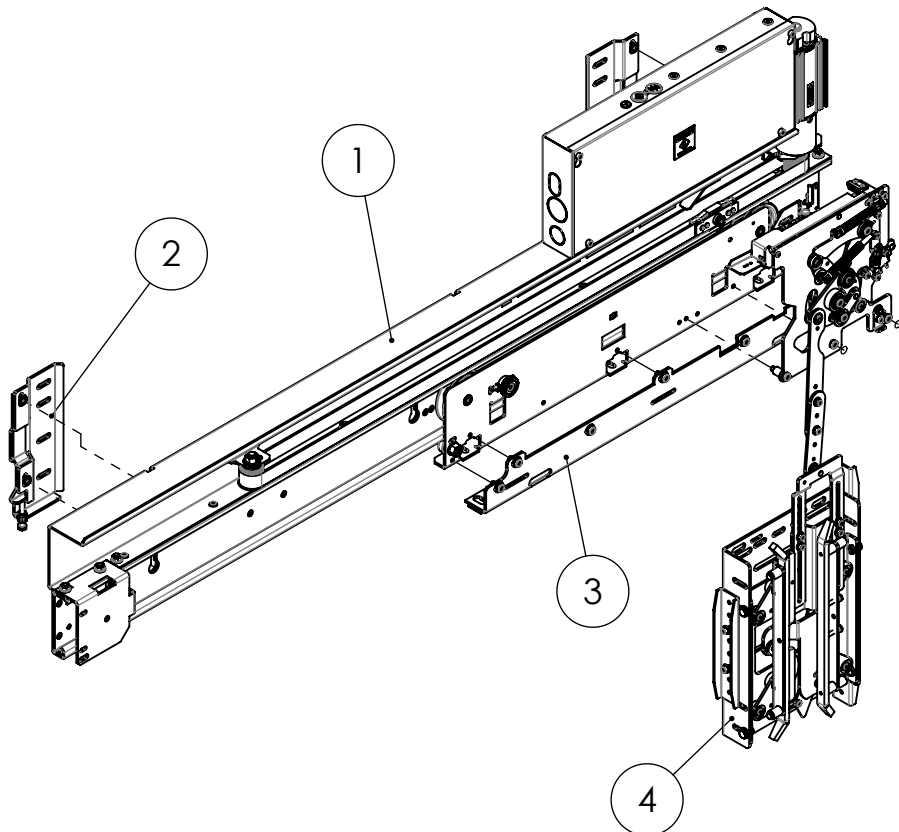
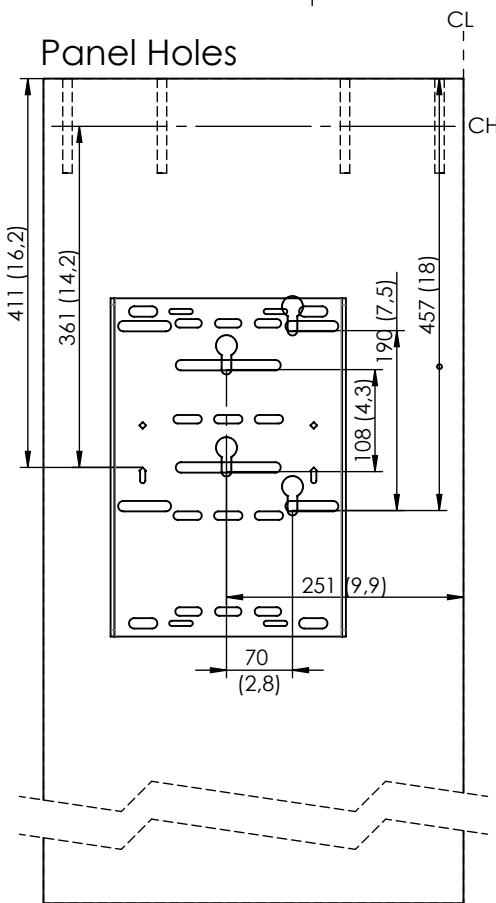

Car Door Interlock 1031827

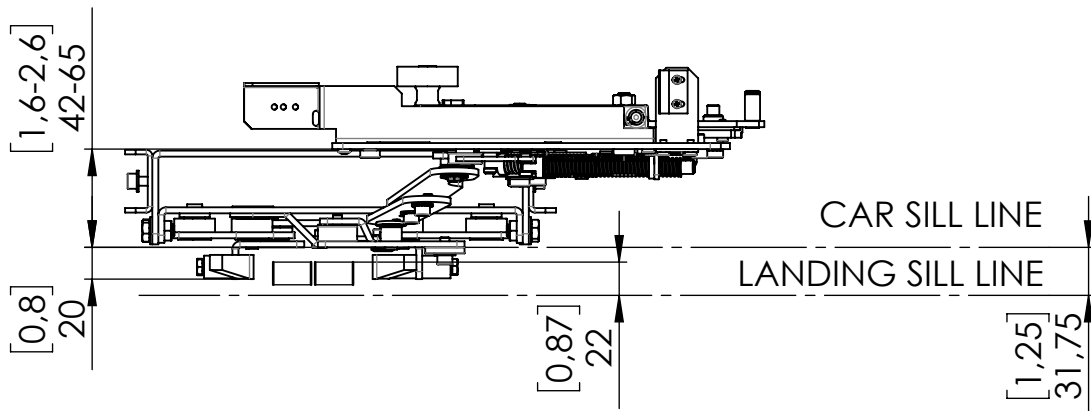
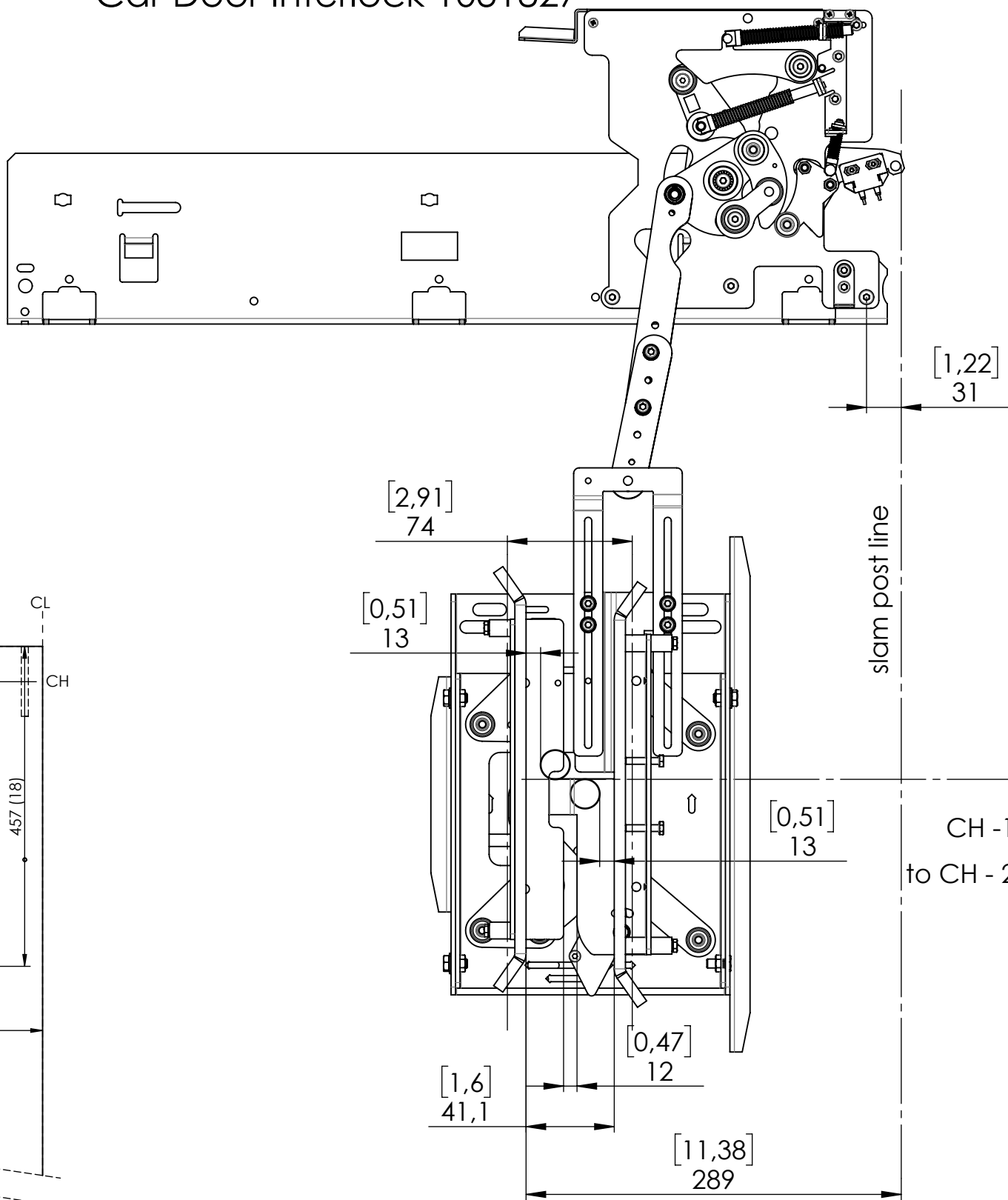

| | | | |
|---------|---------|---------------|-----------------|
| 48 | 1219,2 | 37,5" (952,5) | 81,16" (2061,4) |
| 47 | 1193,8 | 36,5" (927,1) | 79,16" (2010,6) |
| 46 | 1168,4 | 35,5" (901,7) | 77,16" (1959,8) |
| 45 | 1143,0 | 34,5" (876,3) | 75,16" (1909) |
| 44 | 1117,6 | 33,5" (850,9) | 73,16" (1858,2) |
| 43 | 1092,2 | 32,5" (825,5) | 71,16" (1807,4) |
| 42 | 1066,8 | 31,5" (800,1) | 69,16" (1756,6) |
| 41 | 1041,4 | 30,5" (774,7) | 67,16" (1705,8) |
| 40 | 1016,0 | 29,5" (749,3) | 65,16" (1655) |
| 39 | 990,6 | 28,5" (723,9) | 63,16" (1604,2) |
| 38 | 965,2 | 27,5" (698,5) | 61,16" (1553,4) |
| 37 | 939,8 | 26,5" (673,1) | 59,16" (1502,6) |
| 36 | 914,4 | 25,5" (647,7) | 57,16" (1451,8) |
| 35 | 889,0 | 24,5" (622,3) | 55,16" (1401) |
| 34 | 863,6 | 23,5" (596,9) | 53,16" (1350,2) |
| 33 | 838,2 | 22,5" (571,5) | 51,16" (1299,4) |
| 32 | 812,8 | 21,5" (546,1) | 49,16" (1248,6) |
| CO [in] | CO [mm] | A | B |

| | | | | |
|---|--|--|---|---|
| GEN. TOLERANCE WST-0003 TOLERANCE GEN. WST-0003 GT2 | FUNCTIONAL CLASS CLASSE FUNZIONALE B | DESCRIPTION Quick Installation Guide DOVER SGV NA - 1S | PRODUCT CATEGORY CATEGORIA PRODOTTO 2 - DOORS | PRODUCT CODE CODICE PRODOTTO SGV |
| SURFACE TEXTURE SYMBOLS SIMB. RUZZOSTA SUPERFICIALE ISO1302 | GEOM. TOLERANCE SYMBOLS SIMB. TOLLERANZE GEOM. ISO1101 | SCALE SCALA 1:5 | SIZE FORMATO A2 | DESIGNED BY DISEGNATO DA AT1OberR |
| WITTUR | | 1062628 | 1/1 | DATE DATA 06/08/2020 |
| | | | REVISION REVISIONE - | FIRST APPROVAL PRIMA APPROVAZIONE dollima |
| | | | | DATE DATA 15/10/2020 |