

Released for Production

©WITTUR HOLDING GmbH

The reproduction, distribution and utilization of this document as well as the communication of its contents to others without express authorization is prohibited. Offenders will be held liable for the payment of damages. All rights reserved in the event of the grant of a patent, utility model or design. È vietata la riproduzione, la distribuzione o l'utilizzo di questo documento, nonché la comunicazione dei suoi contenuti ad altri, senza l'autorizzazione esplicita del WITTUR Holding GmbH. I trasgressori saranno ritenuti responsabili del pagamento di danni. Tutti i diritti riservati in caso di concessione di un brevetto, modello di utilità o design.

| | | |
|---|---------------------------|---------|
| 1 | Car Door Operator | 1040038 |
| 2 | Car Door Operator Bracket | 1039395 |
| 3 | Panel Adapter Angle | 0905389 |
| 4 | Car Door Interlock | 1031827 |

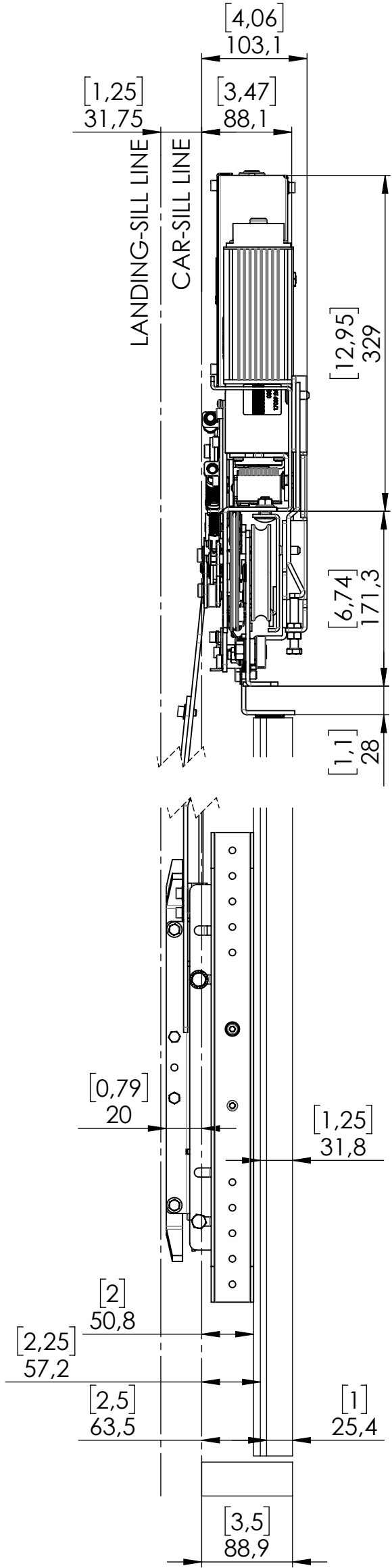

Car Door Operator Bracket 1039395

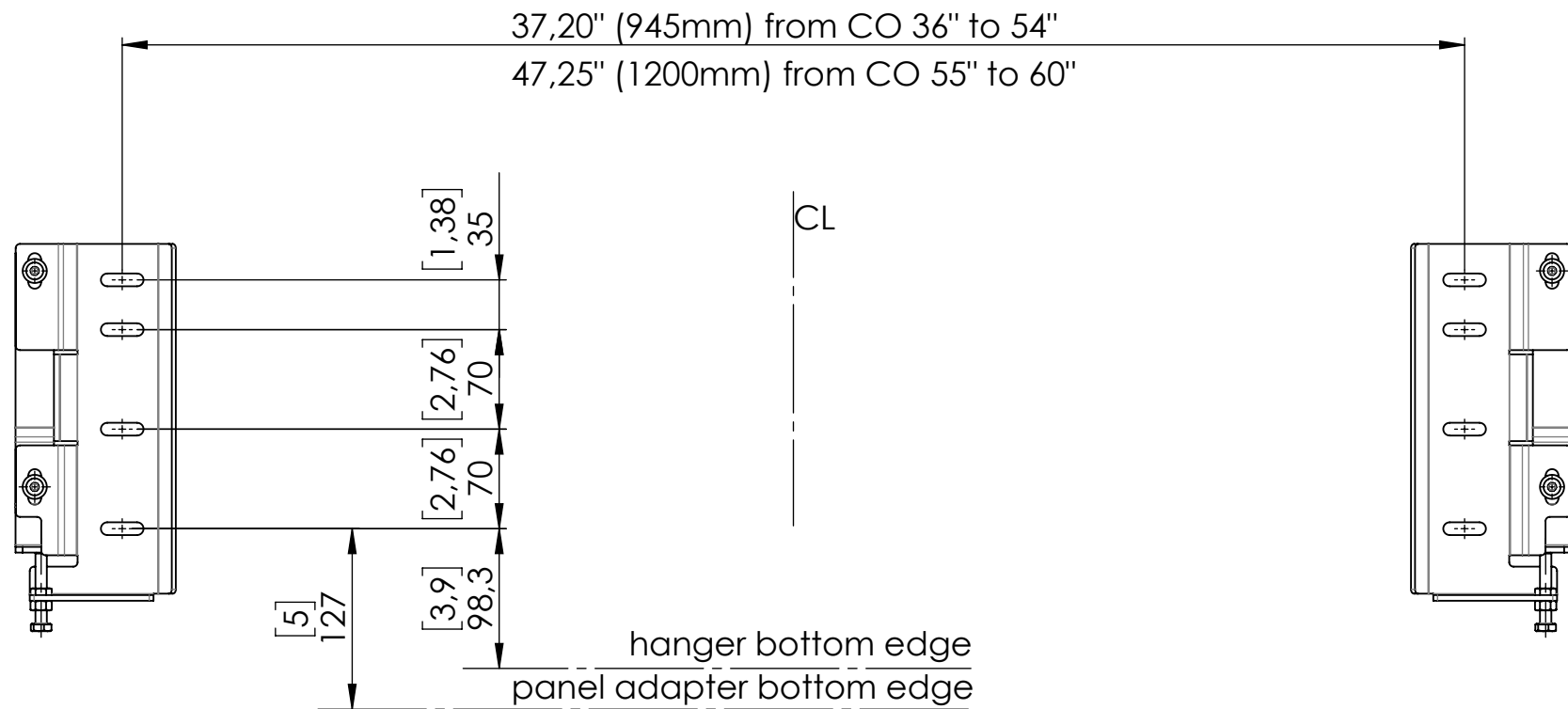

Panel Adapter Angle 0905389

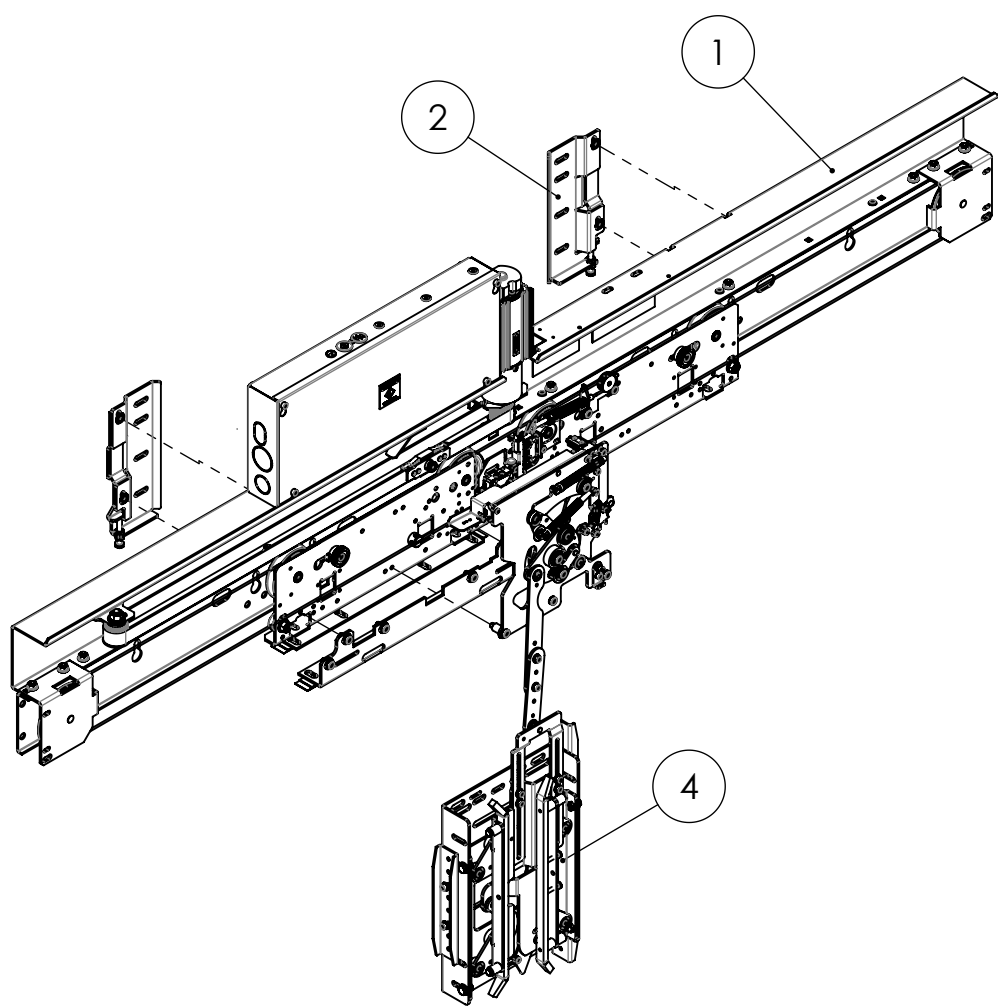
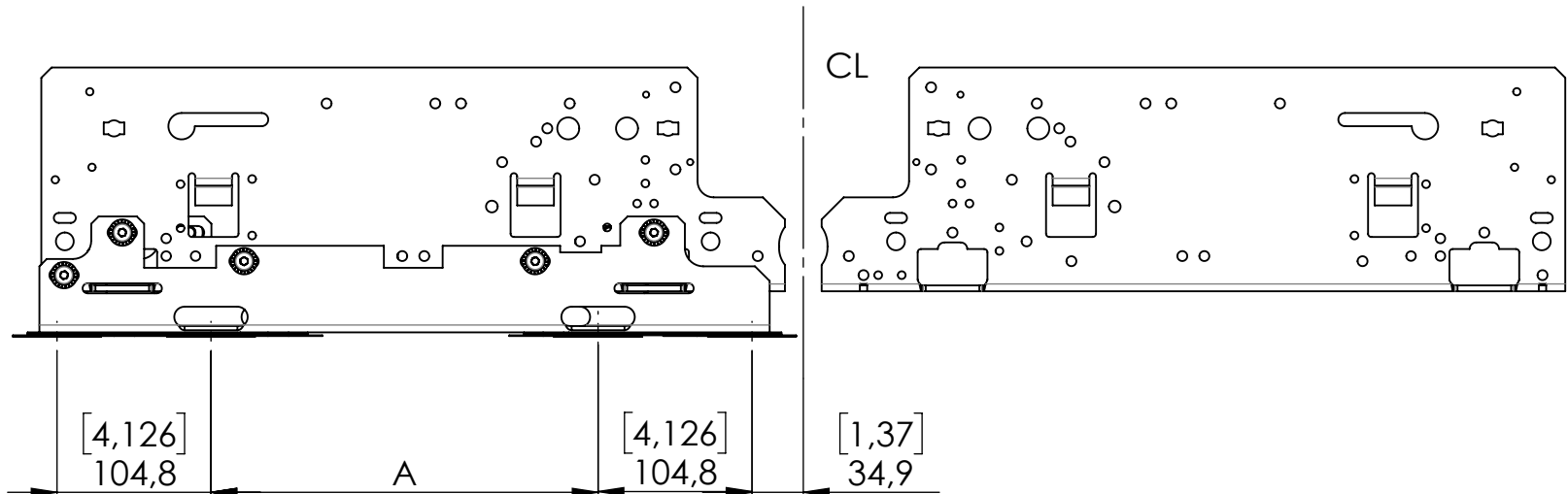

| | | |
|-----|------------|-------------------|
| 60" | (1524mm) | |
| 59" | (1498,6mm) | |
| 58" | (1473,2mm) | |
| 57" | (1447,8mm) | |
| 56" | (1422,4mm) | |
| 55" | (1397mm) | |
| 54" | (1371,6mm) | |
| 53" | (1346,2mm) | 14,88" (377,7 mm) |
| 52" | (1320,8mm) | 14,88" (377,7 mm) |
| 51" | (1295,4mm) | 14,88" (377,7 mm) |
| 50" | (1270mm) | 13,37" (339,7 mm) |
| 49" | (1244,6mm) | 13,37" (339,7 mm) |
| 48" | (1219,2mm) | 13,37" (339,7 mm) |
| 47" | (1193,8mm) | 11,88" (301,6 mm) |
| 46" | (1168,4mm) | 11,88" (301,6 mm) |
| 45" | (1143mm) | 11,88" (301,6 mm) |
| 44" | (1117,6mm) | 10,37" (263,5 mm) |
| 43" | (1092,2mm) | 10,37" (263,5 mm) |
| 42" | (1066,8mm) | 10,37" (263,5 mm) |
| 41" | (1041,4mm) | 8,88" (225,5 mm) |
| 40" | (1016mm) | 8,88" (225,5 mm) |
| 39" | (990,6mm) | 8,88" (225,5 mm) |
| 38" | (965,2mm) | 7,37" (187,3 mm) |
| 37" | (939,8mm) | 7,37" (187,3 mm) |
| 36" | (914,4mm) | 7,37" (187,3 mm) |
| CO | | A |

Car Door Operator Interlock 1031827

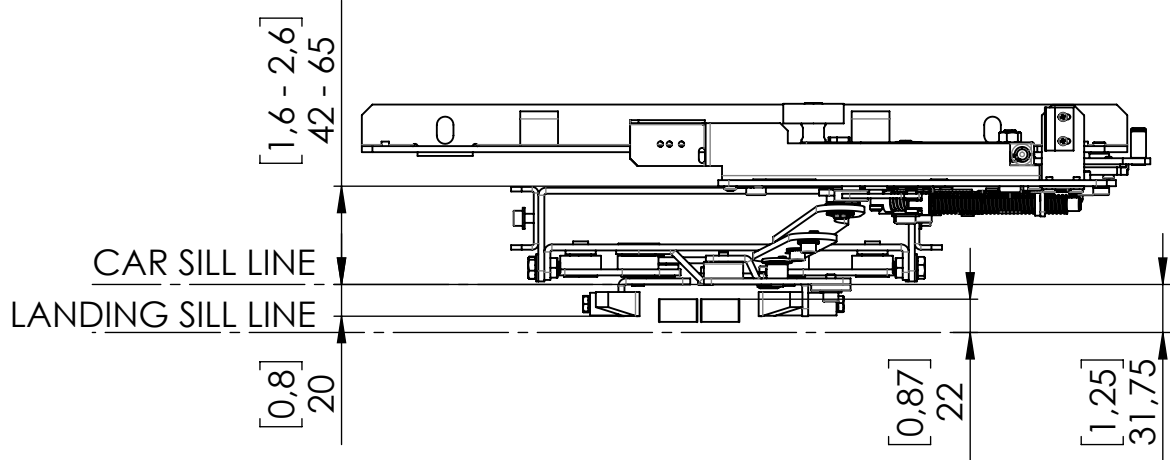
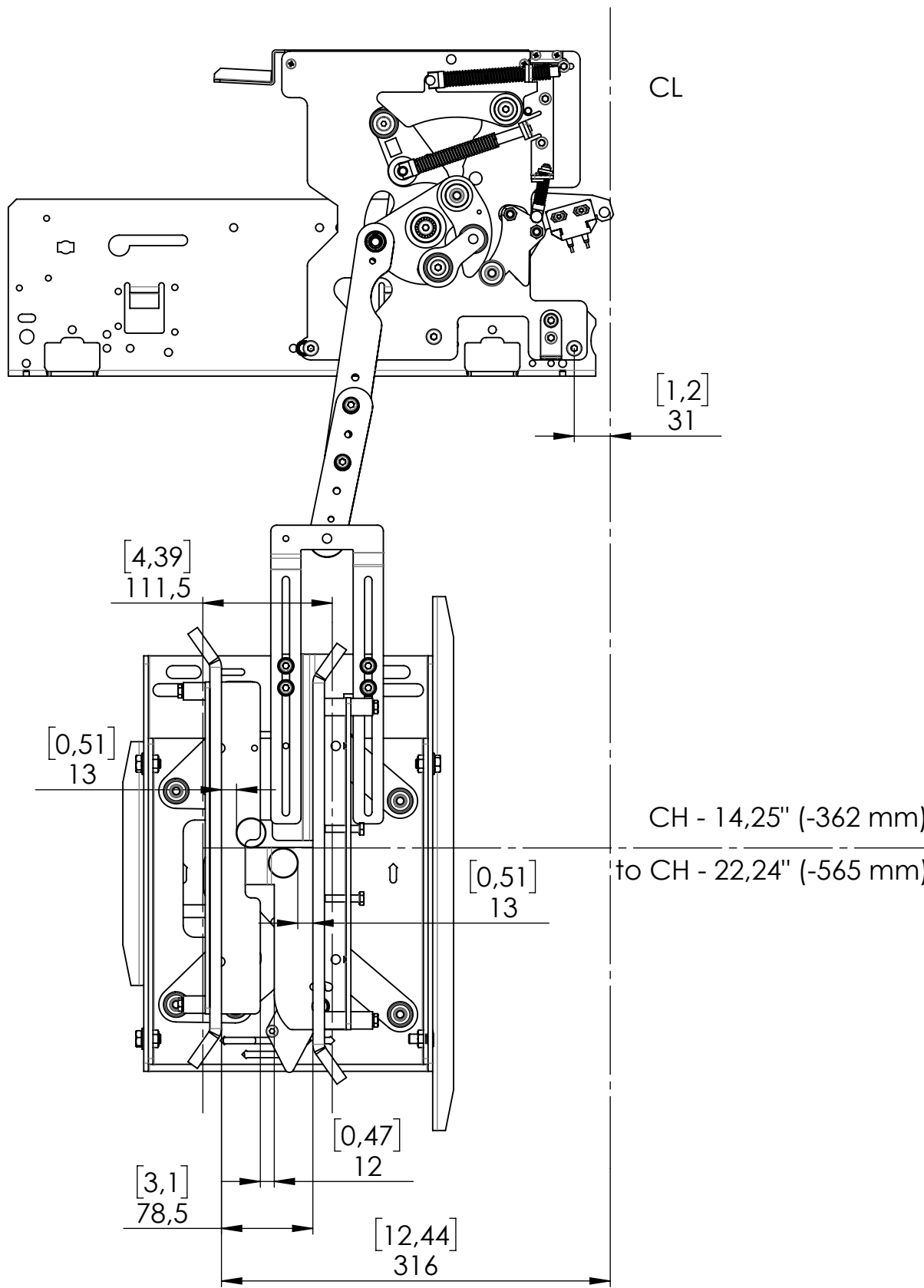

| | | | | |
|---|--|---|---|---|
| GEN. TOLERANCE WST-0003 TOLERANCE GEN. WST-0003 GT2 | FUNCTIONAL CLASS CLASSE FUNZIONALE B | DESCRIPTION Quick Installation Guide GAL | PRODUCT CATEGORY CATEGORIA PRODOTTO 2 - DOORS | PRODUCT CODE CODICE PRODOTTO SGV |
| SURFACE TEXTURE SYMBOLS SIMB. RUGOSITÀ SUPERFICIALE ISO1302 | GEOM. TOLERANCE SYMBOLS SIMB. TOLLERANZE GEOM. ISO1101 | SCALE SCALA 1:5 | SIZE FORMATO A2 | DESIGNED BY COSTRUTTO DA AT1OberR |
| | | DATE DATA 29/07/2020 | | DRAWN BY DISEGNATO DA AT1OberR |
| | | REVISION REVISIONE - | | FIRST APPROVAL PRIMA APPROVAZIONE dollima |
| | | SHEET FOLIO NR 1/1 | | DATE DATA 15/10/2020 |