

Car Door Bracket 1039395

B = 2 x CO - 14,84"

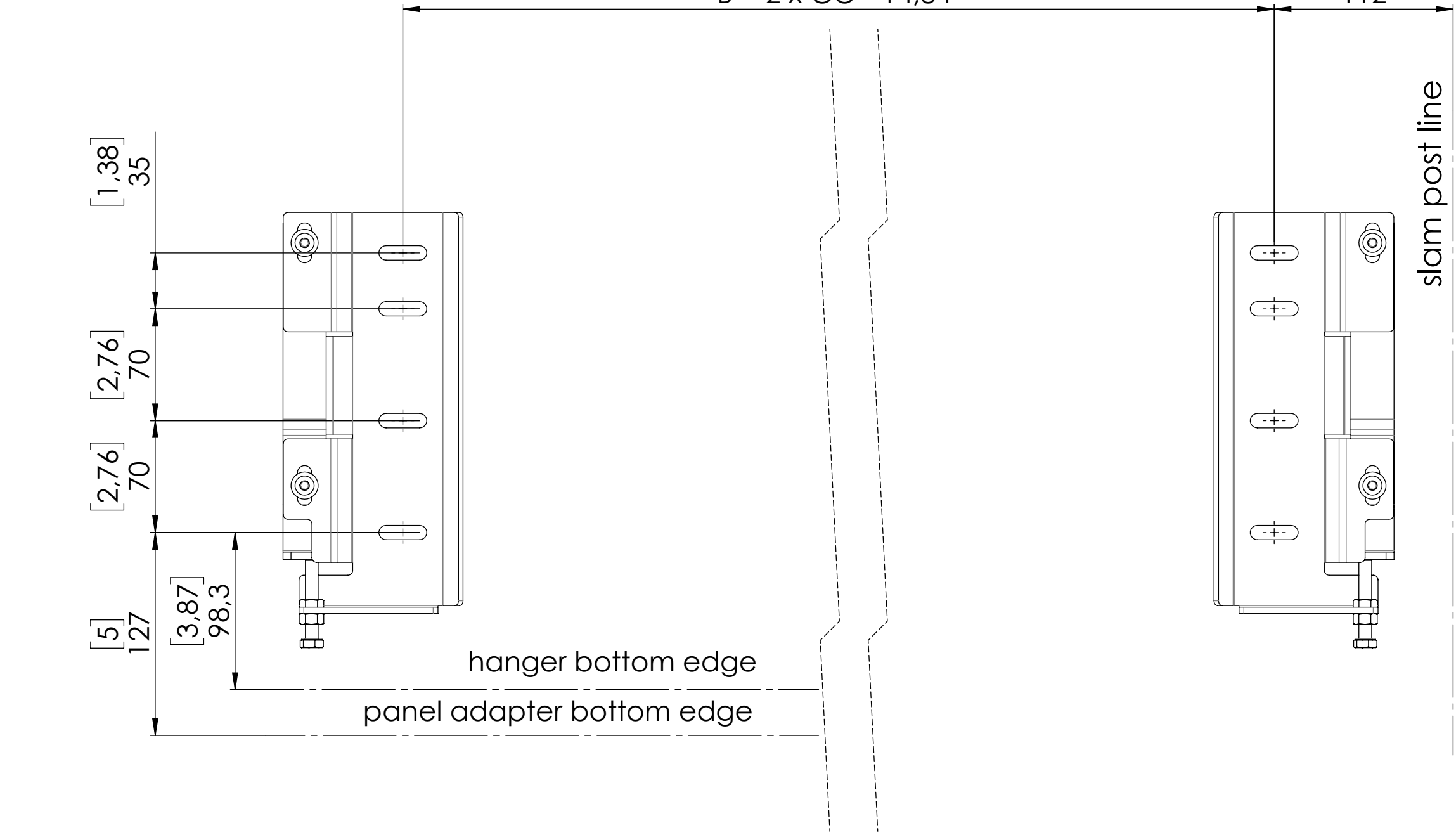

Panel Adapter Interface

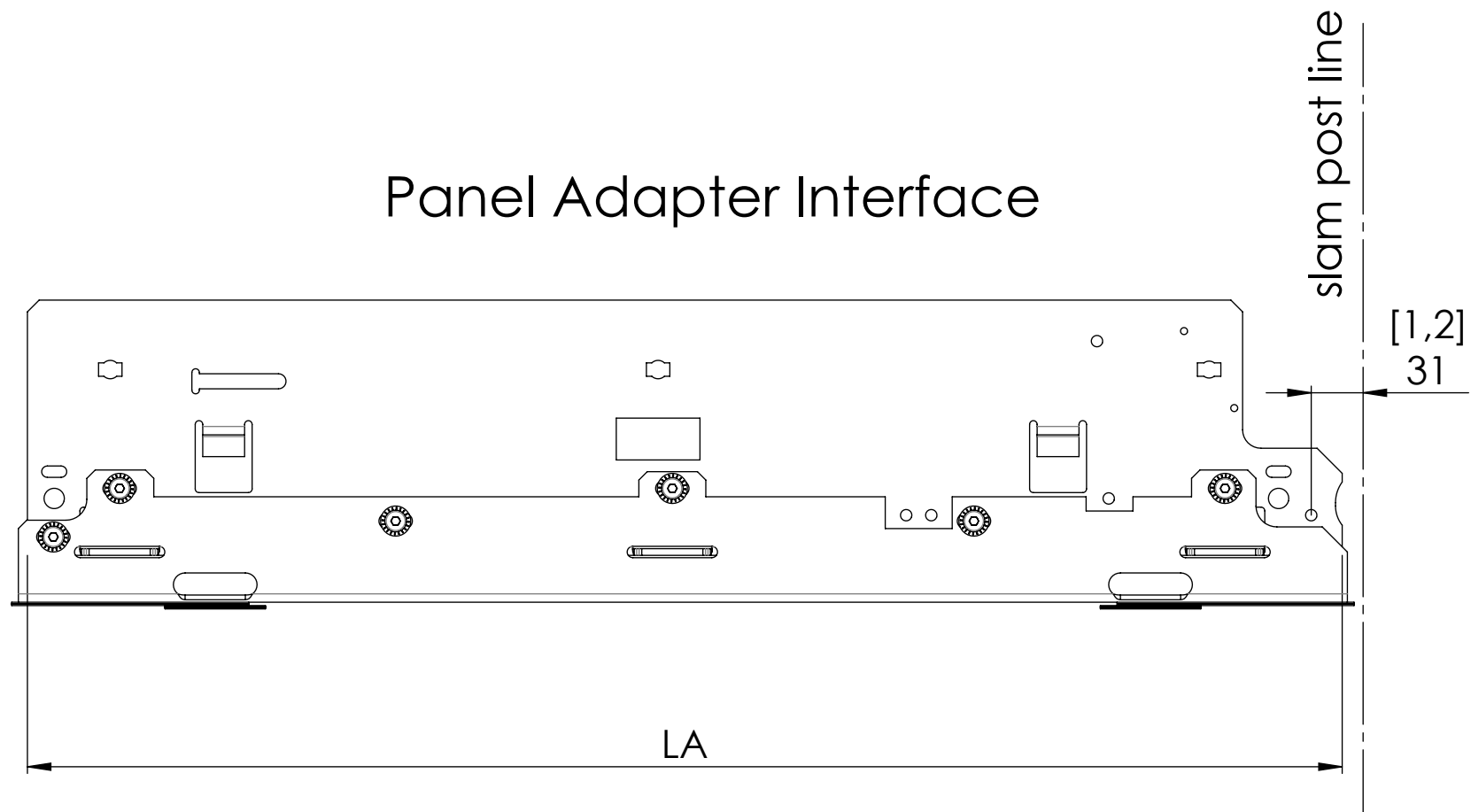

Coupler actuated

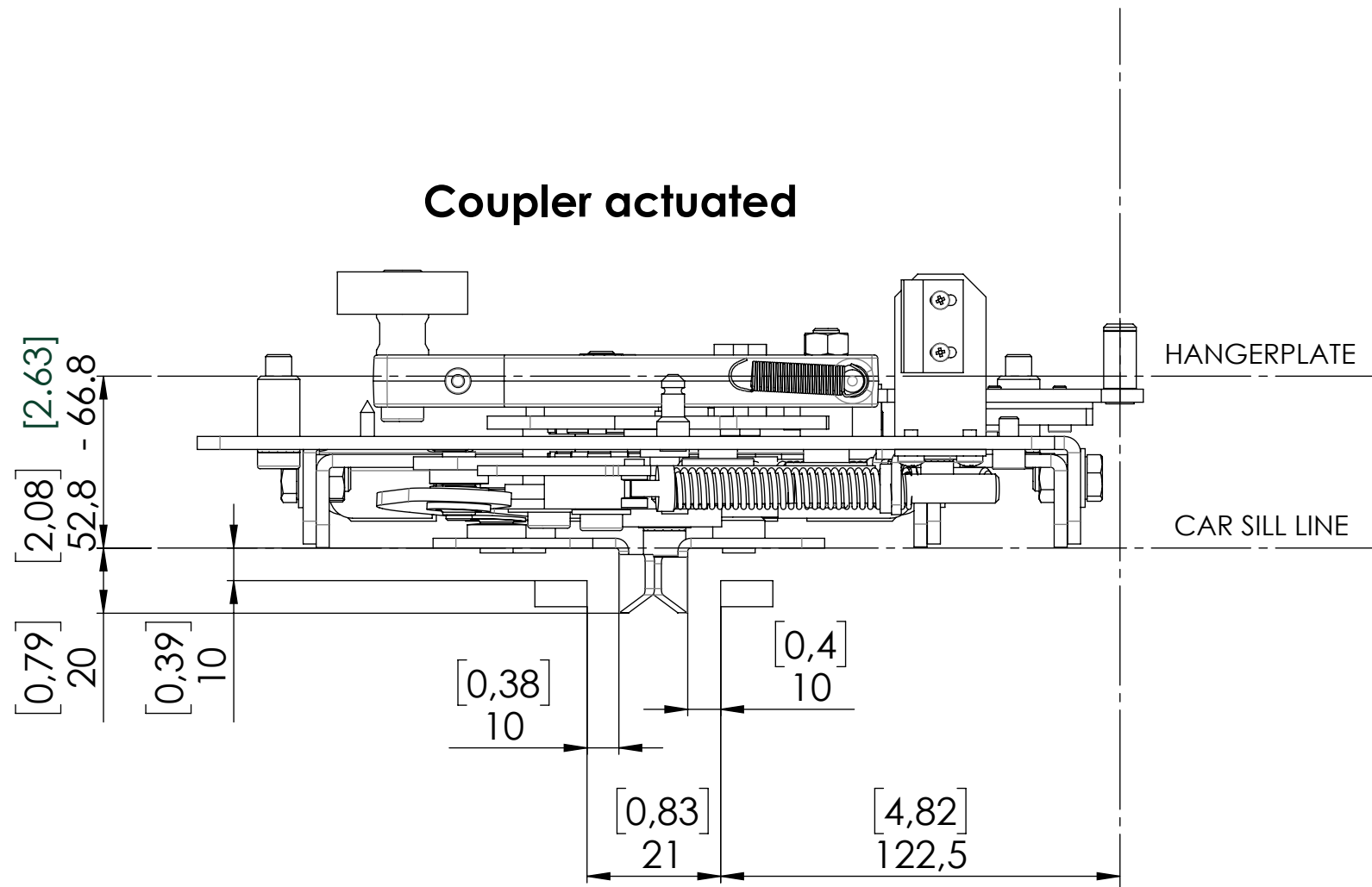

Car Door Interlock 1031490

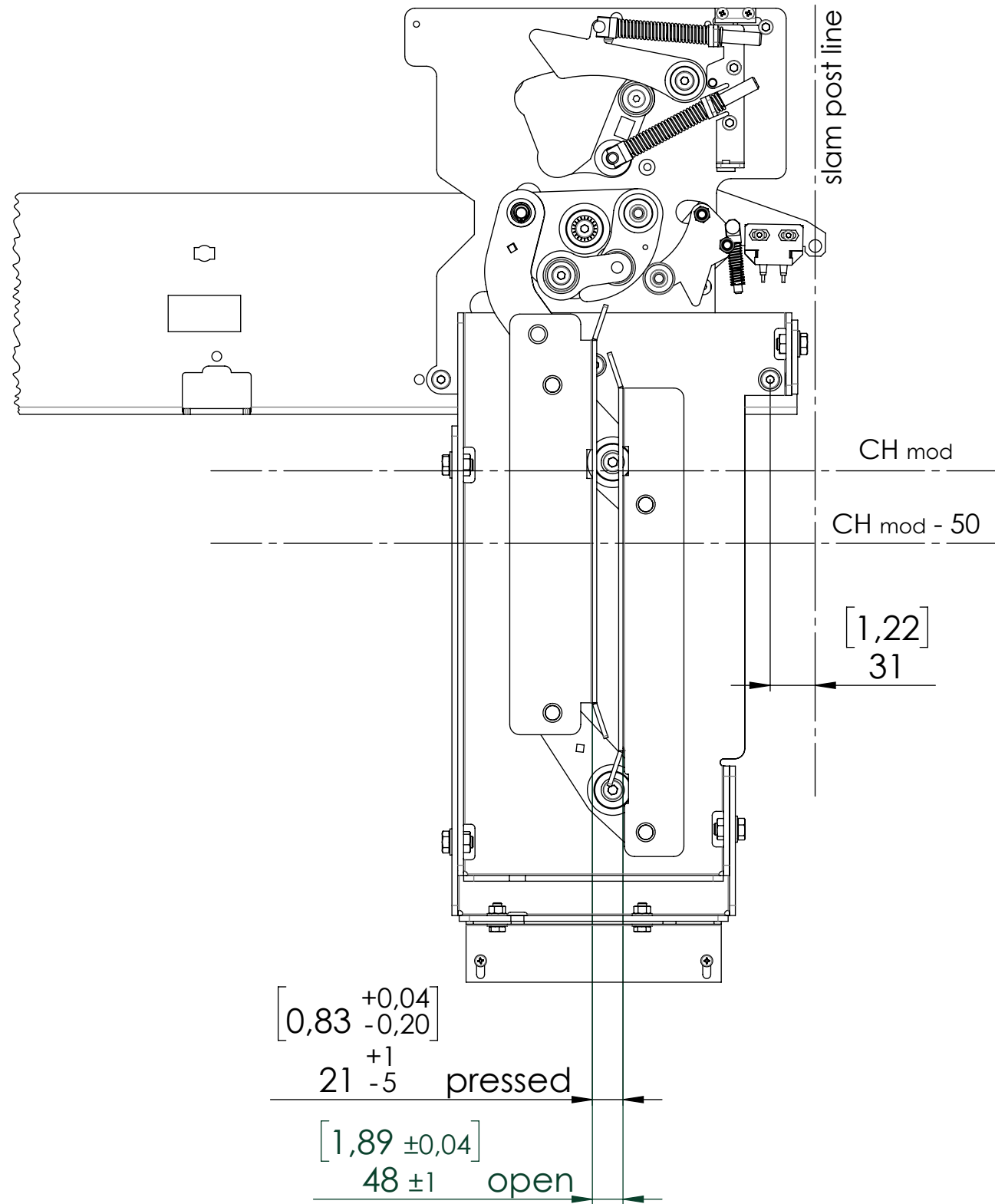

Car Door Interlock 1023385

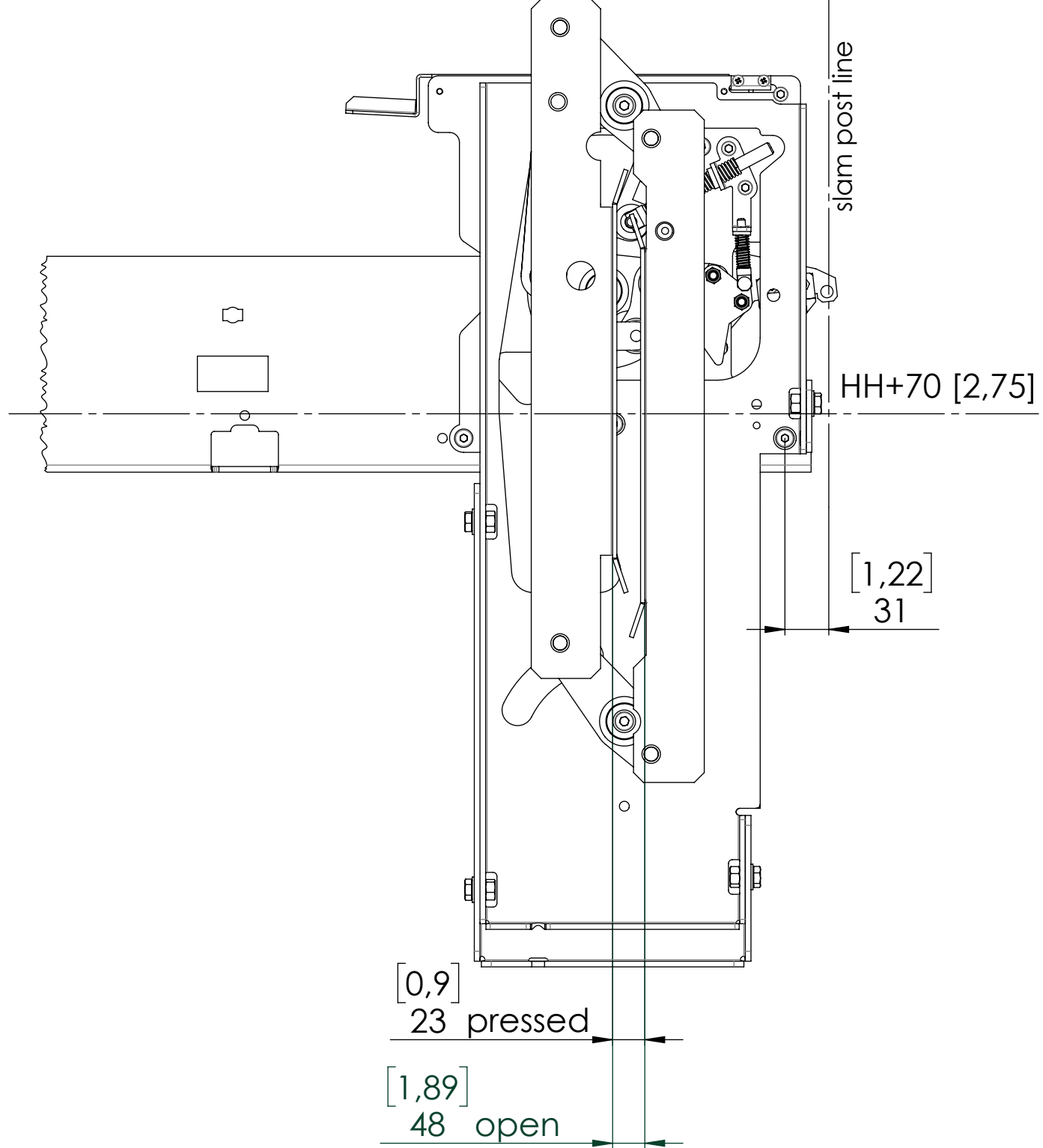

Coupler actuated

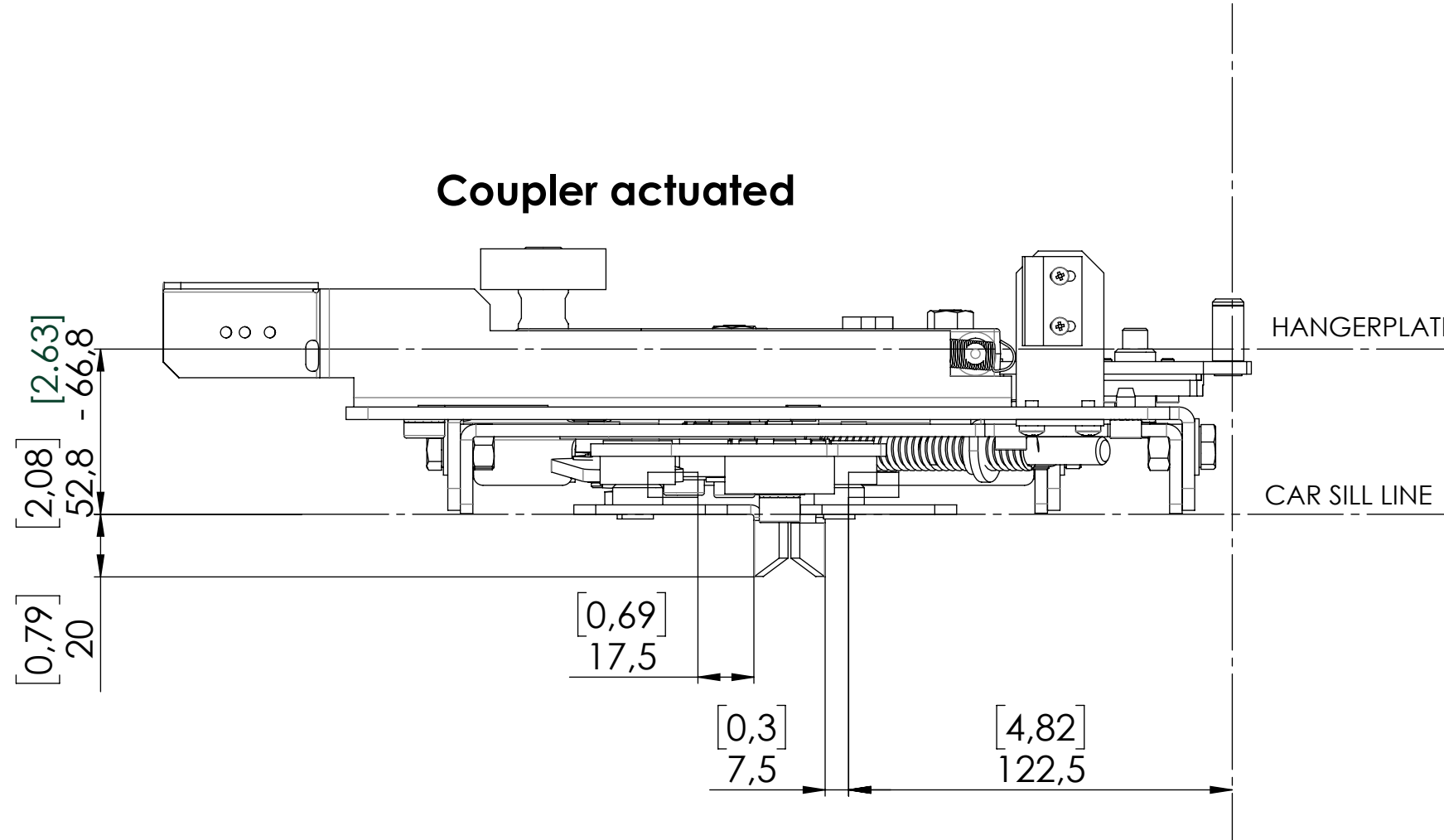

1	Car Door Operator	1046915
2	Car Door Operator Bracket	1039395
3	Panel Adapter Angle	order bound
4	Car Door Interlock	1023385 1031490

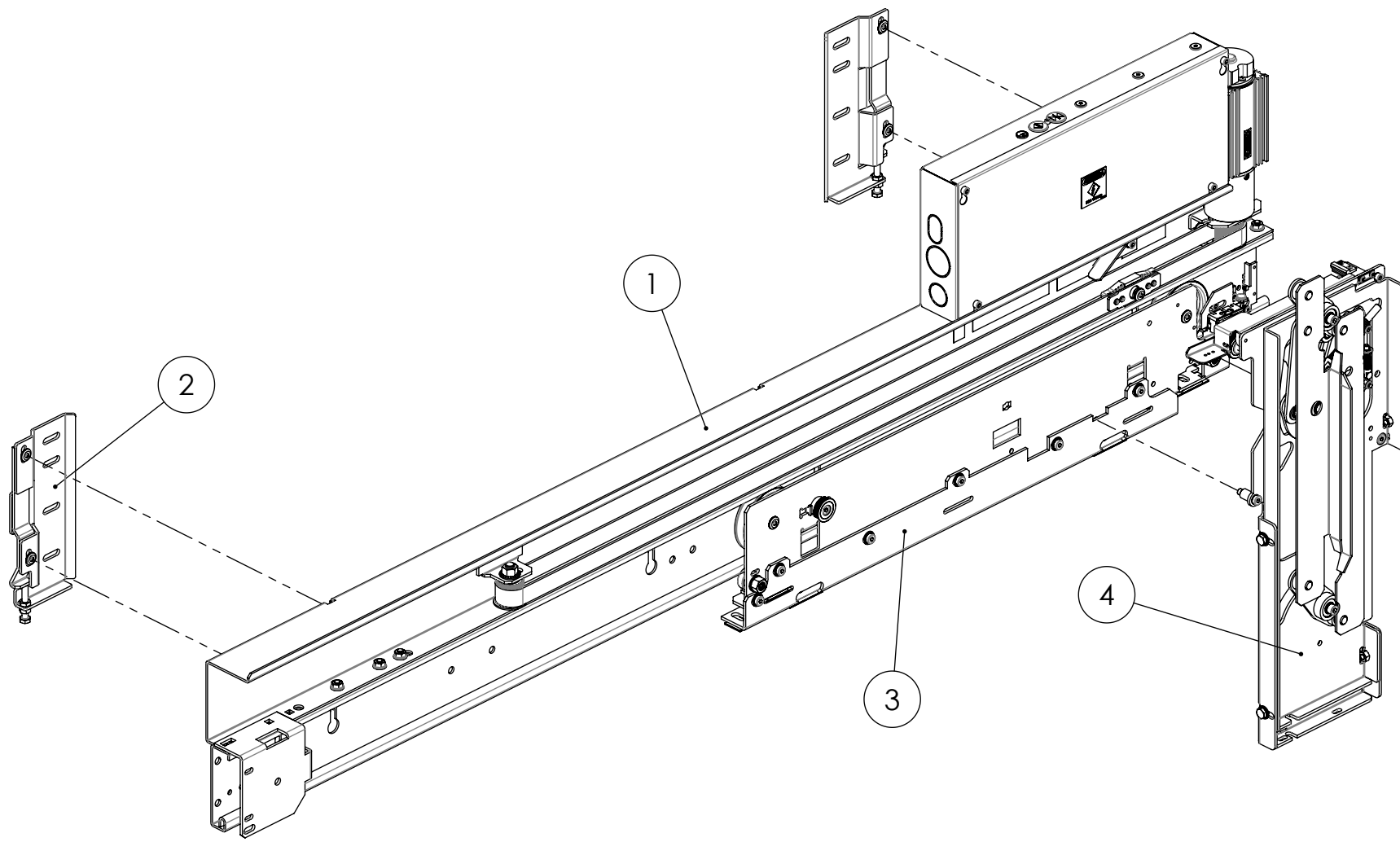

GEN. TOLERANCE HST-00001 AT15 TOLERANCE HST-00022 GT2	FUNCTIONAL CLASS FUNCTIONAL-ASSET B	DESCRIPTION Quick installation guide WH SGV NA - 1S	PRODUCT CATEGORY 2 - DOORS	PRODUCT CODE SGV
SURFACE TEXTURE SYMBOL ISO1302	SCHEMATIC SYMBOL ISO1101	SCALE 1:4	DESIGNED BY AT1KalpaD	DESIGNED BY AT1KalpaD
ZUS. BESCHREIBUNG DRAWING NUMBER ZEICHNUNGSNUMMER		DATE 01/09/2020	DATE 01/09/2020	DATE 01/09/2020
WITTUR		1063568	1/1	Released