

# WCW06, WCW10

## COUNTERWEIGHT FRAME SERIES



## COUNTERWEIGHT FRAME SERIES

# WCW06, WCW10

The WCW series counterweight frames are assembled using screws. Due to its narrow dimensions it is perfect for any standard solution up to 60 m travel height.

TYPE	WCW06		WCW10	
Max. rated speed (m/s)	1,75		3,5	
Max. Suspended Load (kg)	1350		2500	
Max. Frame Height (mm)	3900			
Guide Rail Type (mm)	5/8/9/10/12/14/15/15,88/16			
DBG Min/Max (mm)	470/1020			490/1020
Suspension	1:1	2:1	1:1	2:1
Pulley Ø (mm)	---	160/240/ 330	---	240/330/ 410/530
Rope Ø (mm)	6/6,5/6,7/ 8/8,1/10	6,5/6,7/ 8/8,1	8/8,1/10/13	
Rope type	Steel / PU Coated			

Norm Application		EN81-20	EN81-21	WCWSG
Sliding guide	SLG7	X		
	SLG1	X	X	X
Roller Guide	WRG80	X	X	X
	WRG100	X	X	

### FEATURES

- Meets the EN 81-20 specification
- WCW-width (DBG\*) as well as WCW-height can be chosen freely (in mm steps), within the technical limits
- Suitable for rail head width from 5 to 16 mm, acc. to standard dimension of guide rail width
- Suspension 1:1 up to 2:1
- Usage possible with counterweight safety gear (optional)
- Easy installation
- Small shipping dimensions

### CONTENT OF SUPPLY

- Crosshead channel complete with rope anchor or rope pulley
- At suspension 1:1 rope anchor with equalisation springs are possible (optional)
- Roller guides or sliding guide shoes incl. Guide lubricator
- Buffer spacers (optional)
- Compensation chain hanger (optional)
- Filler-weights are "available on demand"

TYPE	WCW06	WCW10
Slings compatibility	WCF06 / WCF06E	WCF10

(\*) DBG = Distance between guide

# WCW06, WCW10 SUSPENSION 1:1

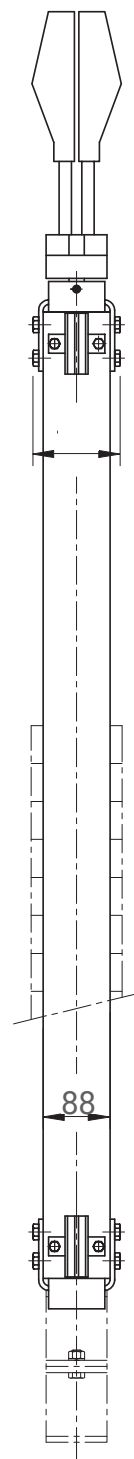
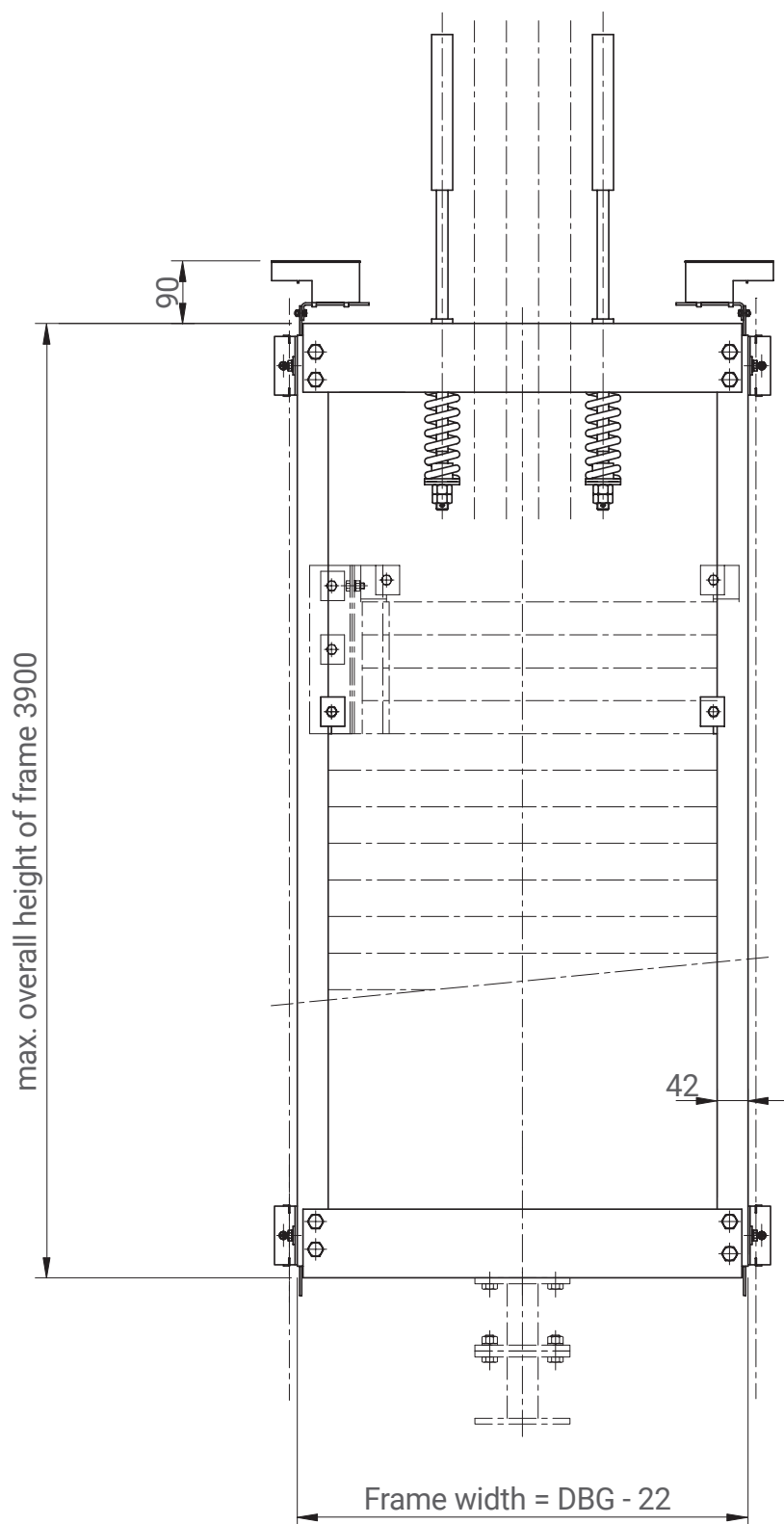

DBG = Distance between guide

## COUNTERWEIGHT FRAME SERIES

# WCW06, WCW10 SUSPENSION 2:1

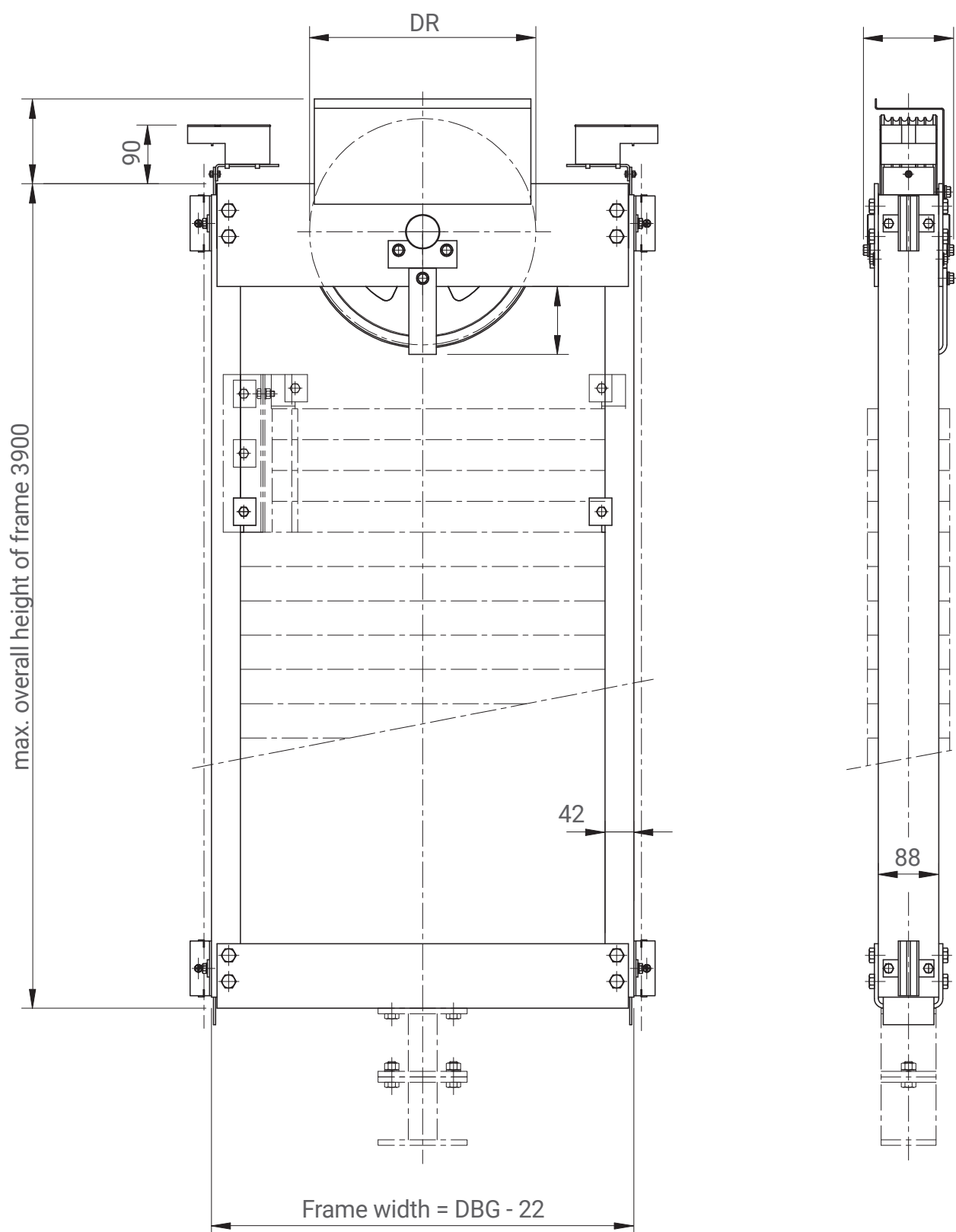

DBG = Distance between guide

DR = Pulley diameter



WITTUR

**YOUR GLOBAL PARTNER** FOR COMPONENTS,  
MODULES AND SYSTEMS IN THE ELEVATOR INDUSTRY



WESW06\_WC0110 - SB 5.0005465 - English - July 2024

Subject to change without notice!

WITTUR.COM



WCW on  
wittur.com

**ADVANCING** THE ELEVATOR INDUSTRY®